

Twin Master Combine

Wheel & Axle Assembly 2-3

Return to this page by clicking the upper right corner of any page in this section.

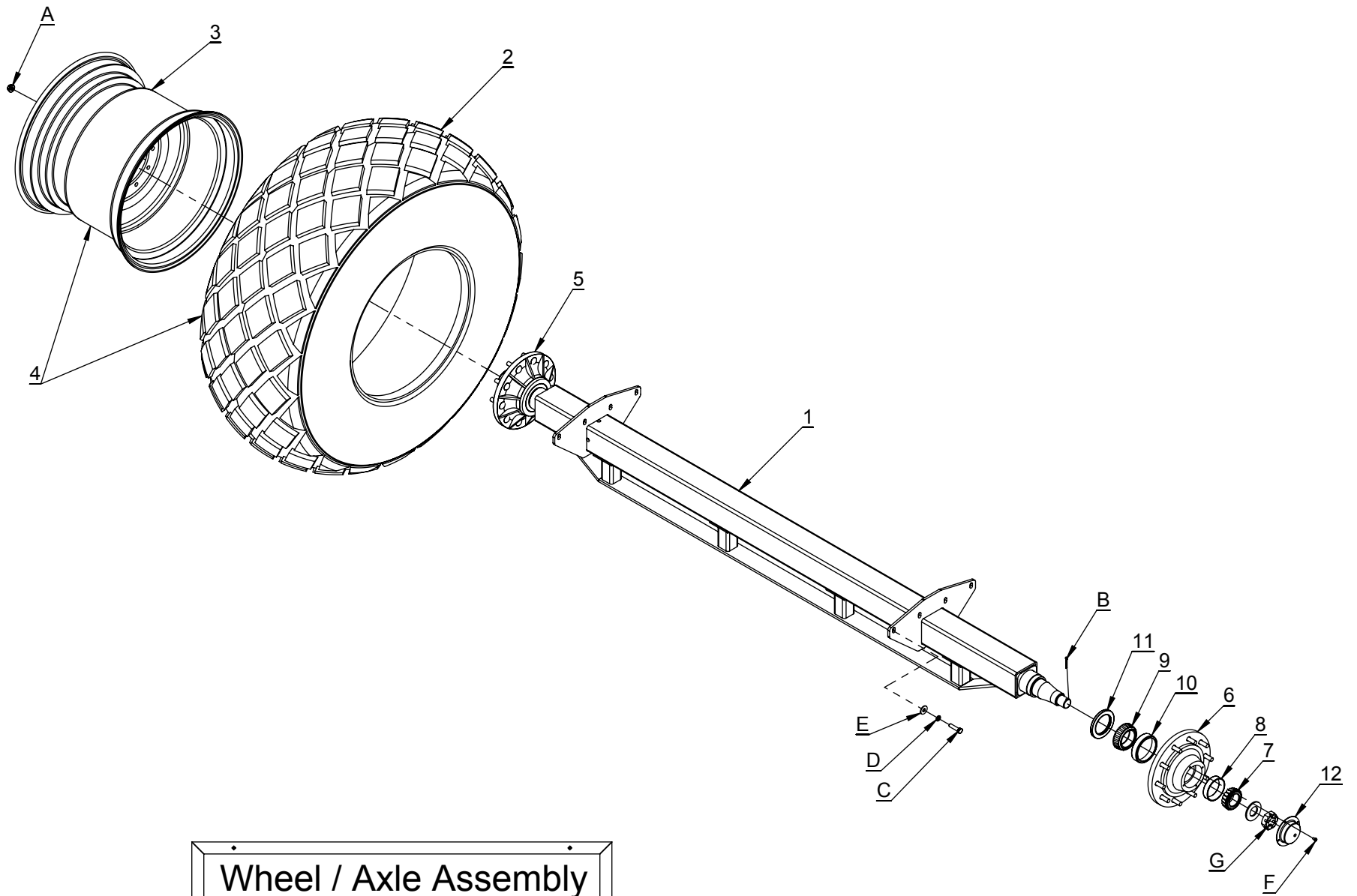

Wheel / Axle Assembly

Wheel / Axle Assembly

Parts List

<u>Item No.</u>	<u>Part No.</u>	<u>Qty</u>	<u>Description</u>
1.	510802	1	Wheel Axle
2.	120024	2	Tire (30.5L – 32 R3) (16 ply)
3.	123026	2	Wheel (27-32) (10 Hole)
4.	120031	2	Tire & Wheel (complete assembly, includes #'s 120024 & 123026)
5.	108226	2	Hub, Complete (10 Hole) (includes bearing cones, cups, seal & dust cap)
6.	108257	2	Hub, (10 Hole) (hub only / no bearings, seal or dust cap)
7.	102166	2	Bearing, Outer Cone
8.	102167	2	Bearing, Outer Cup
9.	102164	2	Bearing, Inner Cone
10.	102165	2	Bearing, Inner Cup
11.	119242	2	Seal, Hub
12.	103144	2	Cap, Dust (4 Mounting Holes)

Hardware List

<u>Item No.</u>	<u>Part No.</u>	<u>Qty</u>	<u>Description</u>
A.		20	3/4" – 16 R.H. Flange Nut
B.		2	Pin, Cotter
C.		8	5/8" x 2" NC Hex Bolt
D.		8	5/8" Lock Washer
E.		8	5/8" Flat Washer
F.		8	5/16" x 1/2" NC Hex Bolt
G.		2	2" – 12 NF Castellated Hex Nut