

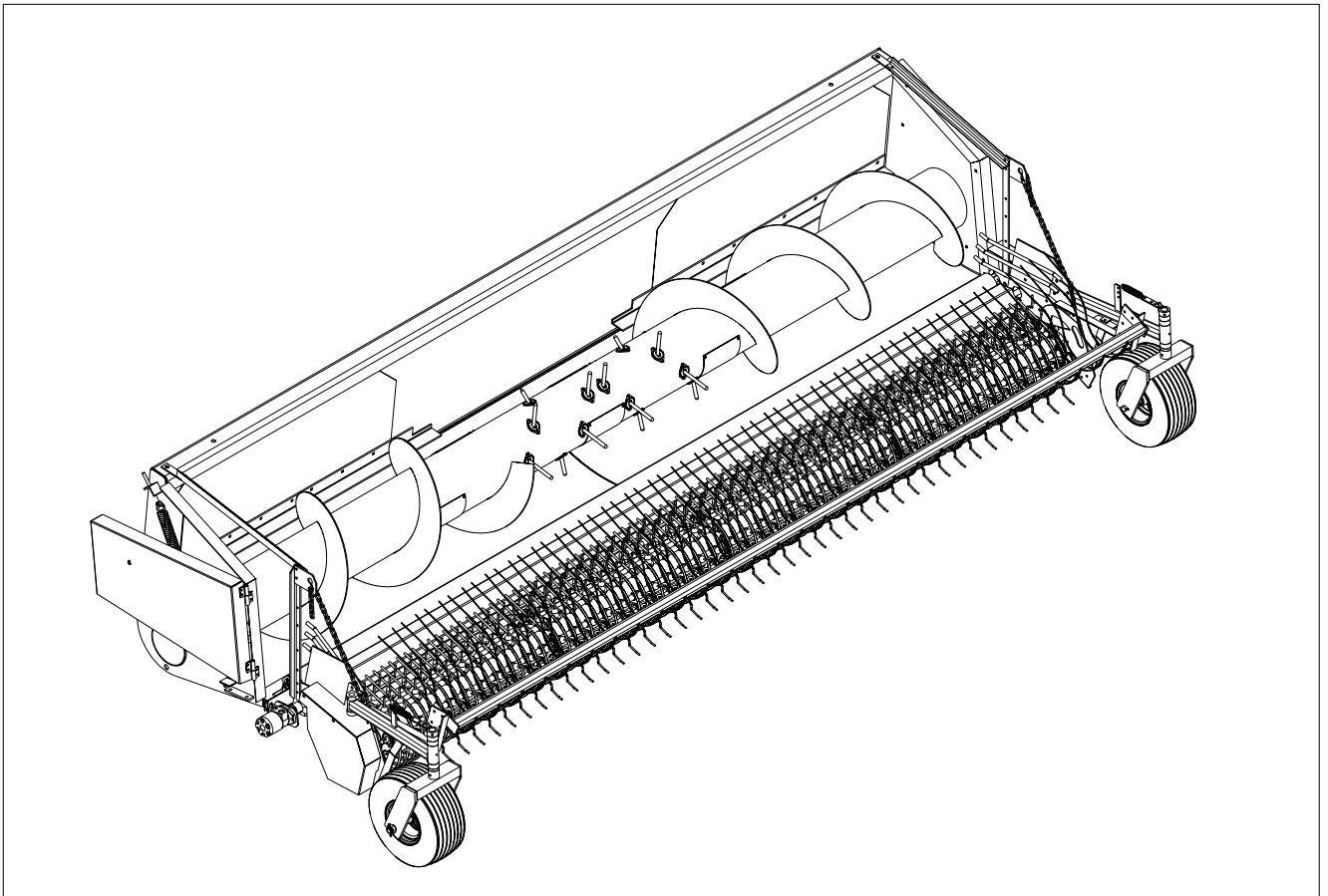

# PICKETT EQUIPMENT

## Operator's Manual



### Universal Combine Platform & Pickup



#### **Pickett Equipment**

976 East Main Street \* Phone: 208-678-0855 \* [www.pickettequipment.com](http://www.pickettequipment.com)  
Burley, Idaho 83318 \* Fax: 208-678-1404 \* [pickett@rvmi.com](mailto:pickett@rvmi.com)



# TABLE OF CONTENTS

Pickett Equipment Warranty .....	2
Warranty Disclaimers .....	3
Delivery Checklist .....	4
After Sale Checklist .....	4
Safety .....	5-7
Set Up .....	8
Machine Adjustments and Operation .....	9
Maintenance and Lubrication .....	9
Combine Pickup Head (diagram) .....	10
Rotor Rod Adjustment and Cam Bearing Replacement .....	11
Universal Platform & Pickup Head (diagram) .....	12
Trouble Shooting .....	13
Storage .....	14
Specifications .....	14



# PICKETT FARM EQUIPMENT WARRANTY

Pickett Equipment warrants to the original purchaser of each item of new Pickett Farm Equipment that the product be free from defects in material and workmanship under normal use and service. If such equipment is found to be defective within one season or 350 acres, whichever shall occur first, the obligation of **PICKETT EQUIPMENT** under this warranty is limited to the repairing or replacing of (exclusive of the cost of labor and transportation), any equipment or parts, in the judgment of **PICKETT EQUIPMENT** to be defective in material or workmanship.

All equipment or parts claimed to be defective in material or workmanship must be made available for inspection at the place of business of a dealer authorized to handle the equipment covered by this warranty, or, upon request by **PICKETT EQUIPMENT**, shipped to the **PICKETT EQUIPMENT** factory in Burley, Idaho. **PICKETT EQUIPMENT shall have no obligation to bear the cost of labor or transportation in connection with replacement or repair of any such defective parts.** **PICKETT EQUIPMENT** will pay internal shop rates on the modification or repair of defective parts in the setup procedure.

This warranty covers only defects in material and workmanship. It does not cover depreciation or damage caused by normal wear, accident, improper assembly, improper adjustments, improper maintenance including lack of proper lubrication, or improper use. Therefore, **PICKETT EQUIPMENT** liability under this warranty shall not be effective or actionable unless the equipment is assembled, maintained and operated in accordance with the Operating instructions accompanying the equipment. **PICKETT EQUIPMENT** shall have no liability if the equipment has been altered or reworked without the written authorization of **PICKETT EQUIPMENT**.

Damages resulting from rocky conditions are not covered by this warranty.

**PICKETT EQUIPMENT** does not warrant commercial components not manufactured by **PICKETT EQUIPMENT**. But, if new, these components may be warranted by the manufacturer thereof.

The only remedies any purchaser has in connection with the breach or performance of any warranty of Pickett Farm Equipment are those set forth in this warranty. In no event shall **PICKETT EQUIPMENT** be liable for incidental or consequential damages or injuries including, but not limited to, loss of crops, loss of profits, rental of substitute equipment or other commercial loss.

This warranty is expressly in lieu of any other express or implied warranties including any implied warranty of merchantability or fitness for particular purpose and of any other obligation on the part of **PICKETT EQUIPMENT**.

**PICKETT EQUIPMENT** makes no warranties, representations or promises, express or implied as to the quality or performance of Pickett Farm Equipment other than those set forth in this warranty. Neither the dealer nor any other person has any authority to make any representations, warranties or promises on behalf of **PICKETT EQUIPMENT** or to modify the item manufactured or sold by **PICKETT EQUIPMENT** or any other time unless he delivers to the purchaser a separate written warranty specifically warranting the same, in which case **PICKETT EQUIPMENT** shall have no obligation thereunder.

**PICKETT EQUIPMENT** parts, which are furnished under this warranty and properly installed, shall be warranted to the same extent as the original parts under this warranty if, and only if, such parts are found to be defective within the original warranty period covering the original equipment.

No warranty request will be considered, and **PICKETT EQUIPMENT** will have no liability under this warranty, unless the Pickett Equipment Delivery Checklist and Warranty Registration Forms have been properly filled out and returned to **PICKETT EQUIPMENT**, at Burley, ID. Pickett warranty forms must be filled out with every claim. Claims must be submitted by the dealer to Pickett Equipment's home office, no later than December 1<sup>st</sup> of the year for which the claim is being made.



## Warranty Disclaimers

The following conditions will void the warranty for the Floating Combine Pickup Head

Removing *safety* shields, guards or safety instructional stickers

Not maintaining or operating equipment according to Operator's Manual

Operating equipment in a malicious or reckless manner

Using replacement parts not of Pickett Equipment origin

Making modifications to the equipment other than those recommended by Pickett Equipment

Not signing and sending in the warranty registration to Pickett Equipment within 30 days of delivery

Pickett Equipment will strive to make product improvements every year, but we cannot be responsible for making updates or additions to equipment previously sold

# DELIVERY CHECKLIST

Review the Operators Manual with the customer. Explain the following:

- Pickett Equipment Warranty.
- Warranty disclaimers.
- Safe and correct operation and service.
- Daily and periodic inspections.
- Warranty registration including registration of unit serial number and returning it to Pickett Equipment
- Combine or tractor tire pressure.
- Correct machine transport procedure.
- Operator's manual and parts listings.
- Correct machine servicing and maintenance.
- Correct procedure for adjusting the hold down rods and explain that they should never be removed.

---

Date Checked

---

Signature

# AFTER SALE CHECKLIST

Dealer / Customer

It is suggested that the following items be completed and then checked sometime prior to operation.

- Inspect for loose or missing bolts.
- Check to ensure that decals are intact and legible.
- Review the entire Operator's Manual with the customer and stress the importance of correct and regular lubrication as well as safety precautions.
- Run the machine to see if it is functioning properly.
- Verify that all chains and sprockets are aligned and tightened correctly.
- Inspect for broken or damaged parts.
- Ensure that all safety shields and all safety stickers are in place.

---

Date Checked

---

Signature



## FOLLOW SAFETY INSTRUCTIONS

Carefully read all safety messages in this manual and safety signs on your machine. Maintain safety signs in good condition. Replace missing or damaged safety signs.

Learn how to operate the machine and how to use the controls properly. Do not let anyone operate the machine without instruction.

Keep your machine in proper working condition. Unauthorized modifications to the machine may impair the function and/or safety of the machine and affect machine life.



## UNDERSTAND SIGNAL WORDS

A signal word - DANGER, WARNING, or CAUTION - is used with each safety-alert symbol. DANGER identifies the most serious hazards.

Safety signs with the signal word DANGER or WARNING are typically near specific hazards.

General precautions are listed on CAUTION safety signs. CAUTION also calls attention to safety messages in this manual.

**▲ DANGER**

**▲ WARNING**

**▲ CAUTION**

## RECOGNIZE SAFETY INFORMATION

This is the safety-alert symbol. When you see this symbol on your machine or in this manual, be alert to the potential for personal injury.

Follow recommended precautions and safe operating practices.



## DISPOSE OF WASTE PROPERLY

Improperly disposing of waste can threaten the environment and ecology. Potentially harmful waste used with equipment include such items as: oil, fuel, coolant, brake fluid, filters and batteries.

Use leakproof containers when draining fluids. Do not use food or beverage containers that may mislead someone into drinking from them.

Do not pour waste onto the ground, down a drain, or into any water source.

Inquire on the proper way to recycle or dispose of waste from your local environmental or recycling center, or from your dealer.

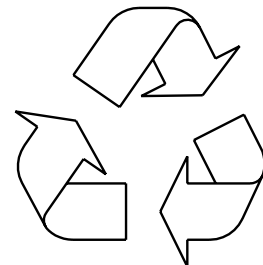

## WEAR PROTECTIVE CLOTHING

Wear close fitting clothing and safety equipment appropriate to the job.

Protective clothing may include; hard hat, dust mask, safety goggles, hearing protection, face shield, gloves and boots.



## USE SAFETY LIGHTS AND DEVICES

When transporting your machine on a road or highway at night or during the day, use necessary safety lights. Check local government regulations. A safety lighting kit is available from your equipment dealer.

Keep safety items in good condition. Replace missing or damaged items.

A - Lights  
B - Slow Moving Vehicle Emblem  
C - Reflector Tape  
D - Reflectors

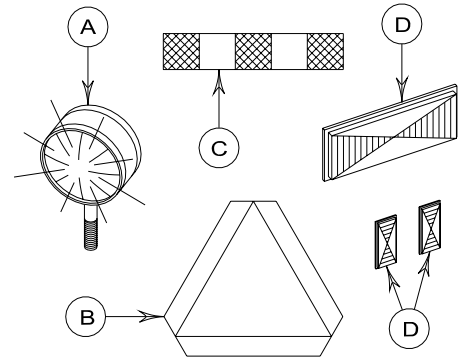

## STAY CLEAR OF ROTATING DRIVELINES

Entanglement in rotating driveline can cause serious injury or death.

Keep tractor master shield and driveline shields in place at all times. Make sure rotating shields turn freely.

Wear close fitting clothing. Stop the engine and be sure PTO driveline is stopped before making adjustments, connections, or cleaning out PTO driven equipment.

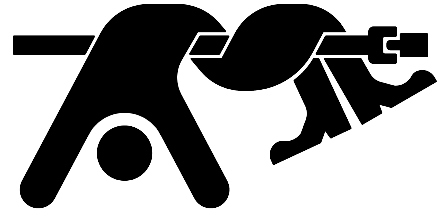

## AVOID HEATING NEAR PRESSURIZED FLUID LINES

Flammable spray can be generated by heating near pressurized fluid lines, resulting in severe burns to yourself and bystanders. Do not heat by welding, soldering, or using a torch near pressurized fluid lines or other flammable materials. Pressurized lines can be accidentally cut when heat goes beyond the immediate flame area.



## PREPARE FOR EMERGENCIES

Be prepared if a fire starts.

Keep a first aid kit and fire extinguisher handy.

Keep emergency numbers for doctors, ambulance service, hospital, and fire department near your telephone.

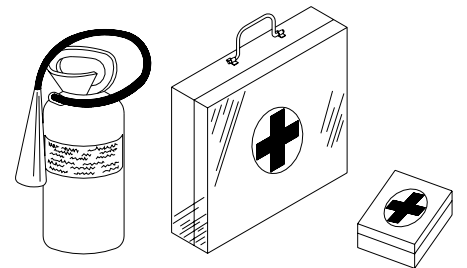

## SERVICE TIRES SAFELY

Explosive separation of a tire and rim parts can cause serious injury or death.

Do not attempt to mount a tire unless you have the proper equipment and experience to perform the job.

Always maintain the correct tire pressure. Do not inflate the tires above the recommended pressure.

When inflating tires, use a clip-on chuck and extension hose long enough to allow you to stand to one side and NOT in front of or over the tire assembly. Use a safety cage if available.

Check wheels for low pressure, cuts, bubbles, damaged rims or missing lug bolts and nuts regularly.

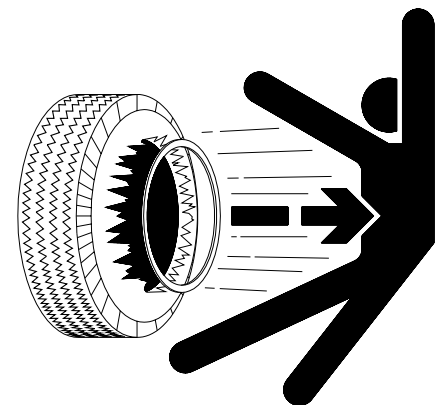

## OPERATE SAFELY

Never ride or permit others to ride on the machine.

Stay clear of ditches or creeks during operation.

Always lower machine to ground when not in use.

Always have tractor or combine stopped on level ground when working around machine.

Always shut off tractor or combine and shift to "Park" or set brakes when leaving tractor or combine.

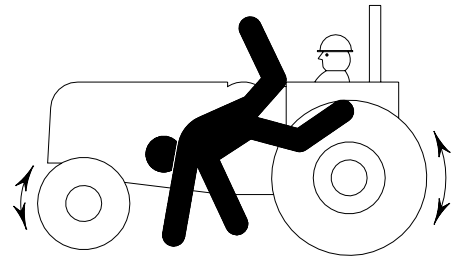

## PRACTICE SAFE MAINTENANCE

Understand service procedure before doing work. Keep area clean and dry.

Never lubricate or service machine while it is moving. Keep hands, feet, and clothing from power-driven parts. Disengage all power and operate control to relieve pressure. Lower equipment to the ground. Stop the engine. Remove the key. Allow machine to cool.

Securely support any machine elements that must be raised for service work.

Keep all parts in good condition and properly installed. Fix any damage immediately. Replace worn or broken parts. Remove any buildup of grease, oil, or debris.

Disconnect battery ground cable (-) before making any adjustments on electrical systems or welding on machine.

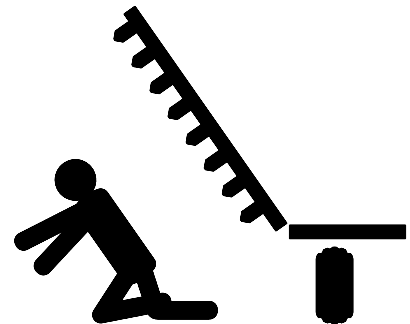

## AVOID HIGH PRESSURE FLUIDS

Escaping fluid under pressure can penetrate the skin causing serious injury.

Avoid the hazard by relieving pressure before disconnecting hydraulic or other lines. Tighten all connections before applying pressure.

Search for leaks with a piece of cardboard. Protect hands and body from high pressure fluids.

If an accident occurs, see a doctor immediately. Any fluid injected into the skin must be surgically removed within a few hours or gangrene may result. Doctors unfamiliar with this type of injury should reference a knowledgeable medical source.

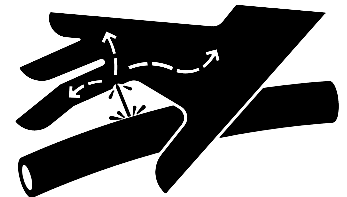

## REMOVE PAINT BEFORE WELDING OR HEATING

Avoid potentially toxic fumes and dust.

Hazardous fumes can be generated when paint is heated by welding, soldering, or using a torch.

Do all work outside or in a well ventilated area. Dispose of paint and solvent properly.

Remove paint before welding or heating:

- If you sand or grind paint, avoid breathing the dust. Wear an approved respirator.
- If you use solvent or paint stripper, remove stripper with soap and water before welding. Remove solvent or paint stripper containers and other flammable material from the area. Allow fumes to disperse at least 15 minutes before welding or heating.

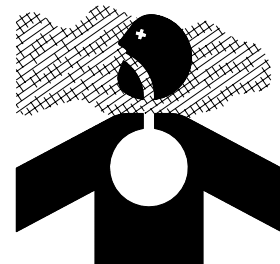

The Pickett Equipment Universal Combine Platform & Pickup Head has been fully assembled and tested prior to delivery. Upon receipt of this machine it is necessary to check and tighten all fasteners, set screws, etc. Take all safety precautions while unloading.

## SET UP

1. Remove any shipping stands or brackets. If any of the platform's or pickup head's components were removed for shipping reinstall them now. Take a few minutes to inspect the entire machine for loose parts or fasteners.
2. Attach Universal Platform and Pickup Head to the combine. Ensure that the lower lock pins engage into their locked position. Adjust lock plates on the platform if necessary.
3. Check the position of the hydraulic motor and mount. Torque arm should move freely in the torque arm slot. Check the Allen head bolts in the 1" split motor coupler.
4. Connect the hydraulic hoses from the combine pickup head to the combine. Ensure pickup head turns the correct direction. Failure to do so can result in extensive damage to the pickup head. A one way check valve has been provided to prevent this from occurring, but take care to ensure that all connections are correct.
5. Connect PTO driveline from Universal Platform to combine. Driveline is equipped with a radial pin safety clutch.
6. If the machine is to be operated in normal conditions set combine and platform on a firm level surface. Adjust platform's height until the pickup head's gauge wheel arms are level with the ground. Now check the distance between the end of the pickup head fingers and the ground. 1" clearance is the recommended starting setting. If the machine will be operating in rocky conditions follow the above instructions except have the gauge wheel arm higher in the rear than in the front.
7. Lift chains are equipped with heavy-duty float springs. Adjust these springs until the pickup head floats. With platform at operating height these springs will allow the pickup head to float. Each spring has been supplied with a 3/16" cable clamp on each end to keep the springs from disengaging from the lift chains.
8. Adjust hold down rods so that they are as close as possible to the windrow without impeding the flow of the material onto the pickup head.
9. Check the platform augers float spring adjustment. You should be able to manually lift the auger.
10. Check and adjust the distance from the auger flighting to the platform bottom.
11. Check and adjust the distance from the auger flighting to the clean off scrapers.
12. Check and adjust platform's auger finger retract position. Fingers need to retract at the point the foliage moves from the auger to the combine's feed chain. If the fingers retract to late the material will be carried over the auger. Fingers that retract to soon will cause foliage to hesitate and bunch under the auger. (see page 12)

**NOTE: Pickett Equipment does not supply one point quick couplers.**

**NOTE: Never operate the combine pickup head without the hold down rod mount in place. It is an important part of the pickup head frame.**

## MACHINE ADJUSTMENTS AND OPERATION

### Gauge Wheels-

Gauge wheel height can be adjusted up or down to meet varying field conditions. Pick up teeth should be operated as high off the ground, as possible and still pick up all of the windrow. Under most conditions operate with the gauge wheels' 2" square mounting arms level with the ground. In rocky conditions operate with these mounts higher in the rear than in the front. This will allow rocks to travel under the pickup head

### Pickup Head Speed-

Pickup head speed is adjusted hydraulically from the combine. **Important:** Always operate the pickup head at half of ground speed. This is the gentlest, most efficient way to operate your pickup head.

### Lift Chains-

Lift chains should be adjusted in conjunction with the float springs so that under normal operation the pickup head is floating on the gauge wheels.

### Hold-Down Rods-

**Important: The hold-down rod, mounting tube is part of the main frame of the pickup head and must remain securely in place at all times.**

The hold-down rods are adjustable to meet various conditions. When foliage is light move the rods as close to the windrow as possible. In heavier crops, the hold down rods can be moved up. Operate with the rods as low as possible without causing damage to the crop or impeding the flow onto the pickup head.

## MAINTENANCE AND LUBRICATION

### Daily Maintenance

- ◆ Maintain tire pressure at 24 psi.
- ◆ Check tension and alignment of drive chains and lubricate.
- ◆ Check for excessive wear throughout machine.
- ◆ Check for bent, loose or missing rotor rods or hold down rods. Tighten, straighten or replace rods as needed.
- ◆ Inspect for loose or missing bolts or components.
- ◆ Remove crop residue from rotors and slingers. Check for excessive mud build-up in cam tracks.
- ◆ Replace any broken or worn out fingers.
- ◆ Check cam bearings for wear. (see page 11)
- ◆ Check platform auger for missing or worn fingers or guides.
- ◆ Lubricate machine as listed.

### LUBRICATION

Ensure that all lubrication points are all well greased before operating the machine. Do not allow excessive grease to collect on or around parts, especially when operating in sandy soil.

#### Lubrication areas and amounts are:

1. Wheel bearings-repack hubs after the end of each season.
2. Driveline bearing crosses grease daily or 10 hrs.
3. Driveline radial pin clutch grease every 100 hrs. or after the clutch releases.
4. Wheel fork vertical pivot shafts grease every 100 hrs.
5. Slinger roller pivot rings-light amount of lubricating oil daily.
6. Lubricate chains on drive sprockets daily.

Support Chain  
(Count the links to make sure  
the Pickup Head is lifting and  
operating level.)

Float Spring

Tire Self-Aligning Spring

Adjustable Plate for  
Hold Down Rod  
Mounting Bracket

Lubrication Points

Spacers

Angle Brace Mount

To Header: (Drill mounts so upright angles  
form a 90 degree angle off the  
Platform and are in line with  
each other.)

Upright Angle & Chain Anchor  
(For Pickup Head height.)

Pickup Head  
Mounting  
Assembly

# COMBINE PICKUP HEAD

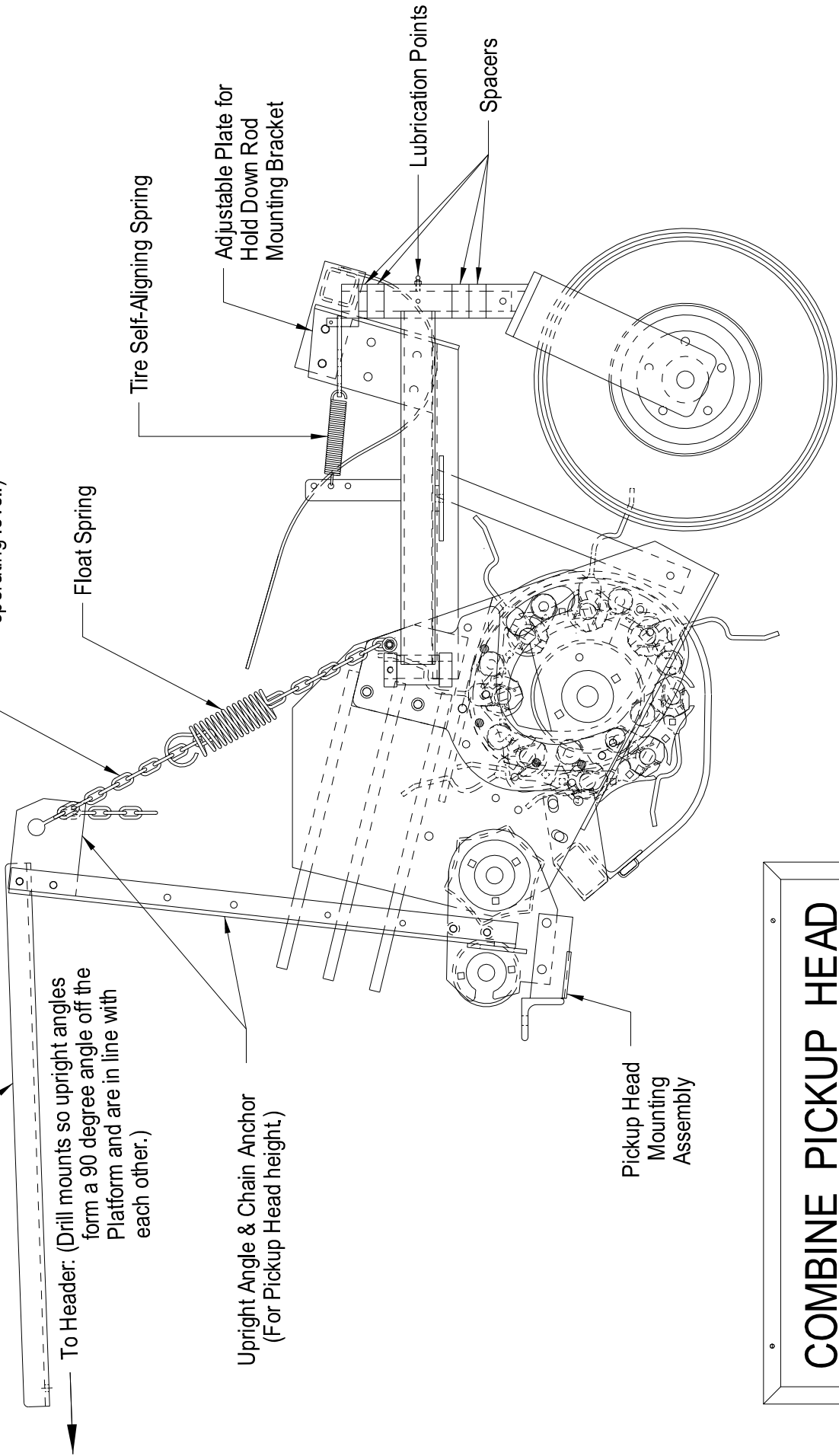

## CAM ARM BEARING REPLACEMENT

TOOLS THAT ARE NEEDED TO REPLACE CAM ARM BEARINGS:

- (1)--LARGE FLAT BLADED SCREWDRIVER
- (1)--15/16" OPEN-END WRENCH
- (1)--3/4" OPEN-END WRENCH

STEP #1: REMOVE THE INNER SHIELD FROM OVER THE TOP OF THE CAM TRACK. ROTATE THE PICKUP HEAD UNTIL THE CAM BEARING TO BE REPLACED ALIGNS WITH THE BEARING REMOVAL SLOT.

STEP #2: REMOVE THE JAM NUT WITH THE 15/16" OPEN-END WRENCH.

STEP #3: LOOSEN THE CAM BEARING WITH THE 3/4" OPEN-END WRENCH. (USING A NARROW-PROFILE 3/4" END WRENCH WILL EASE THIS OPERATION.)

STEP #4: INSERT A LARGE SCREWDRIVER INTO THE SLOT AT THE THREADED END OF THE BEARING, TURN SCREWDRIVERS HANDLE CLOCKWISE UNTIL THE BEARING CLEAR THE CAM ARM. REMOVE THE BEARING THROUGH THE BEARING REMOVAL SLOT.

STEP #5: REVERSE STEPS 2 THRU 4 TO INSTALL THE NEW BEARING. ENSURE THE JAM NUT HAS BEEN TIGHTENED SECURELY.

## ROTOR ROD ADJUSTMENT & CAM ARM BEARING REPLACEMENT INSTRUCTIONS

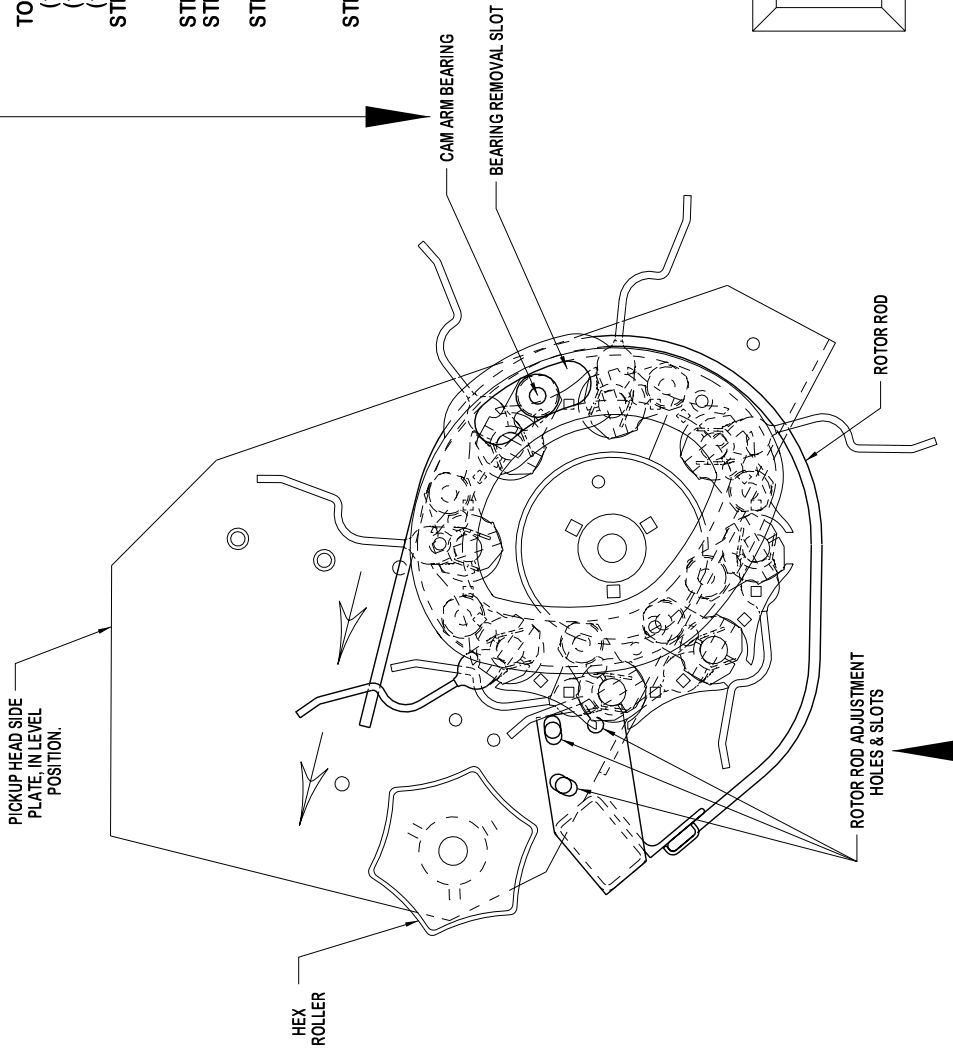

## ROTOR ROD ADJUSTMENT\*\*

- STEP #1: LOOSEN THE 6 ROTOR ROD ADJUSTMENT BOLTS (3 PER SIDE).
- STEP #2: FIRMLY GRAB ROTOR RODS WITH YOUR HANDS AND ROTATE INTO DESIRED POSITION.
- STEP #3: TIGHTEN ALL BOLTS.

\*\* THIS ADJUSTMENT IS IMPORTANT TO PREVENT BEAN VINES FROM WRAPPING AROUND THE HEX ROLLER.

Adjust Spring Tension Until  
Auger Can Be Raised By Hand

Adjust Handle Clockwise For Fingers to Retract Sooner  
Adjust Handle Counterclockwise For Fingers to Retract Later

Under Normal Conditions Gauge Wheel  
Arm Should Be Parallel With The Ground.  
In Rocky Conditions Operate With The  
Rear Of This Arm Higher Than The Front.

Auger Can Be Moved Forward and Back  
In These Slots For Proper Clearance Between  
The Auger And The Clean Off Scraper

Up And Down Adjustment For Clearance  
Between The Auger and The Platform Bottom

## Universal Combine Platform With Pickup Head

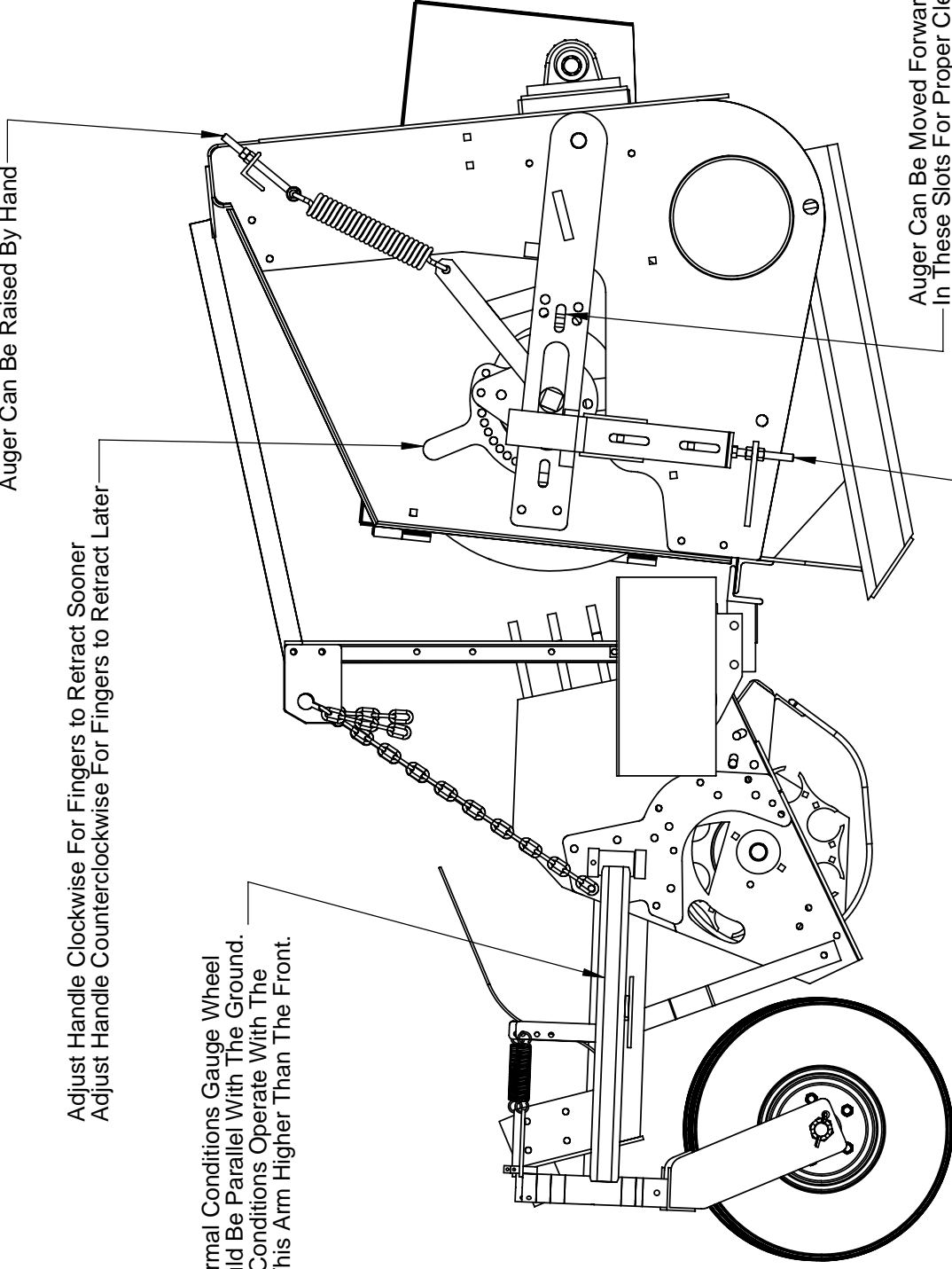



## TROUBLE SHOOTING

Problem	Cause	Remedy
Excessive shattering of crop	Pickup running too fast.  Pickup running too low.	Dry conditions, run slower.  If the fingers are too low they can bend when they contact the soil then spring forward with enough force to shatter the crop when they come out of the soil. Operate pickup head 1/2" to 2" above ground surface.
Excessive finger tooth breakage	Pickup is running too low to ground.	See machine adjustments to adjust height. Operate pickup head 1/2" to 2" above ground surface.
Excessive finger shaft wear	Rotor rods or rotor rod mount is loose or improperly adjusted.  Rotor rods are bent or misaligned.	Tighten and adjust rotor rods and rotor rod mount.  Straighten or replace with new rotor rods.
Picking up rock	Pickup head speed too fast.  Operating too close to ground.  Operating pickup head too level.  Operating with hard fingers in rocky conditions.	Slow pickup head speed down to 1/2 ground speed.  Using gauge wheel spacers raise or lower gauge wheels to keep teeth out of dirt.  Operate platform higher and pickup head down in a slanted position. Adjust pickup head chain supports and spacers on gauge wheels to accomplish this.  Switch to soft fingers Pickett Equipment part # 106052.
Material returning over the auger	Retractable fingers not retracting soon enough.	Rotate Finger adjustment handle clockwise. (see page 12)
Material hesitating between auger and combine feeder chain	Retractable fingers retracting too soon.  Retractable finger broken or missing.	Rotate Finger adjustment handle counterclockwise. (see page 12)  Replace fingers as needed.

## STORAGE

- ◆ Store machine in a dry sheltered area if possible.
- ◆ Chains should be removed, cleaned, lubricated, and re-installed.
- ◆ Remove trash from shafts, etc., steam clean if possible.
- ◆ Re-paint any scuffed areas or treat with anti-rust lubricants.
- ◆ Lubricate entire machine.
- ◆ Check tire pressure.
- ◆ Block machine off ground.
- ◆ Make any notes of all repair parts needed for next season and order early.
- ◆ Make any needed repairs if possible.
- ◆ If machine must be stored outside, block up machine, remove the wheels and store them inside.

## SPECIFICATIONS

Model Number	Usable Pickup Width	Weight Aprox.	Overall Width Outside of Tires	
			Wide Setting	Narrow Setting
UP14-148	148"	3004 lbs.	187"	176"
UP16-172	174"	3380 lbs.	213"	202"
UP20-222	222"	4305 lbs.	261"	250"
UP22-246	246"	4770 lbs.	285"	274"
UP25-282	278"	5410 lbs.	317"	306"

- Length of machine .....89" (Front to back)
- Hydraulic Requirements .....8 GPM @ 2000 PSI





## **Pickett Equipment**

976 East Main Street \* Phone: 208-678-0855 \* [www.pickettequipment.com](http://www.pickettequipment.com)  
Burley, Idaho 83318 \* Fax: 208-678-1404 \* [pickett@rvmi.com](mailto:pickett@rvmi.com)