

One Step Rod Cutter Rear Pull

Main Frame

Section 4

Model Years 1988 - 1990	2-5
Model Year 1991	6-9
Model Year 1992	10-11
Model Year 1993	12-13
Model Years 1994 – Present.....	14-15
Model Years 2005 – Present (12 Row 30) Offset “Y” Main Frame & Underneath Gauge Wheel.....	16-17
Model Years 2005 – Present (12 Row 30) Center “Y” Main Frame & Center Rear Gauge Wheel	18-19

Return to this page by clicking the upper right corner of any page in this section.

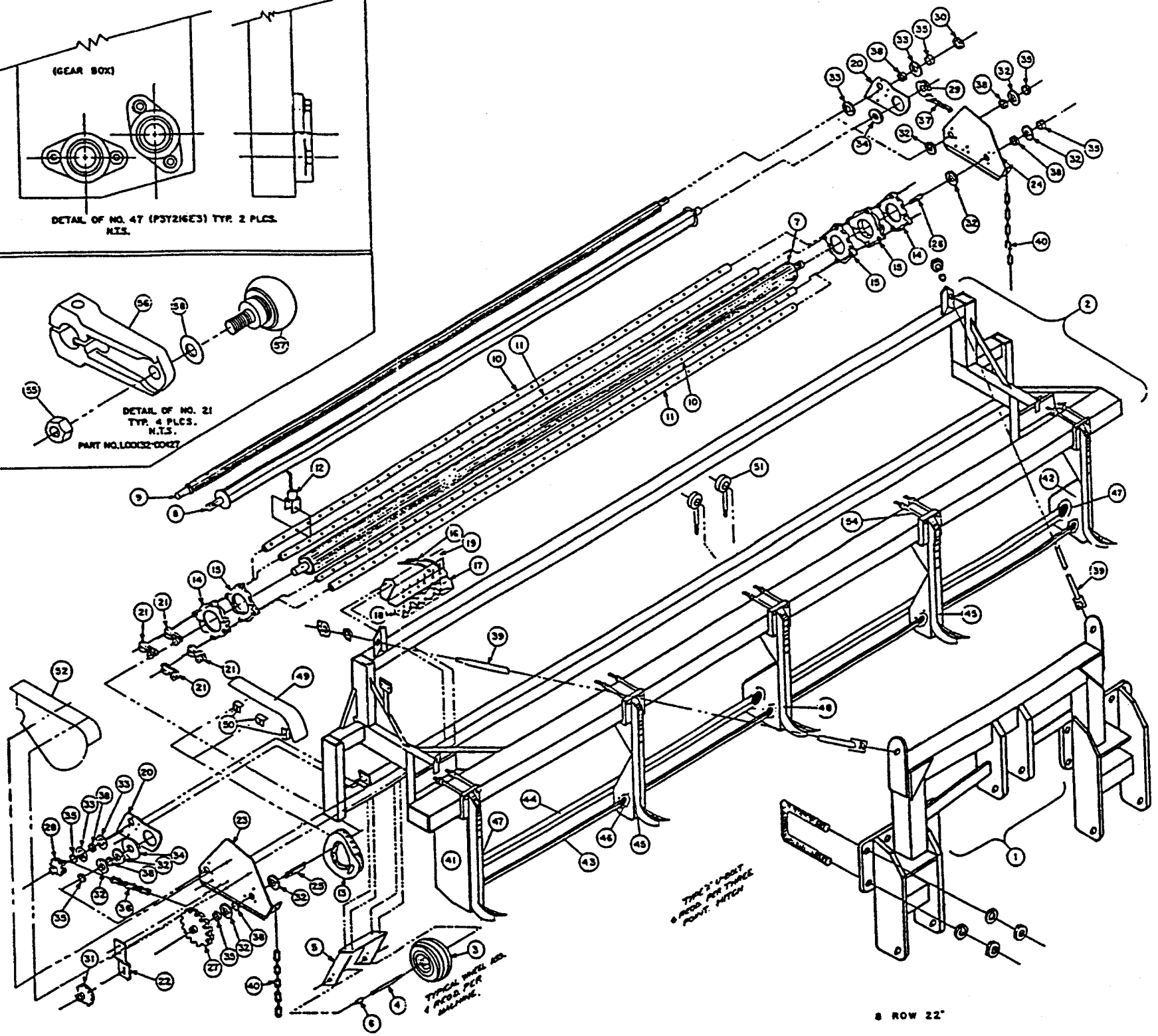
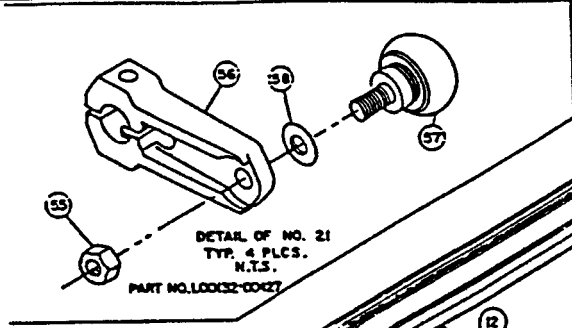
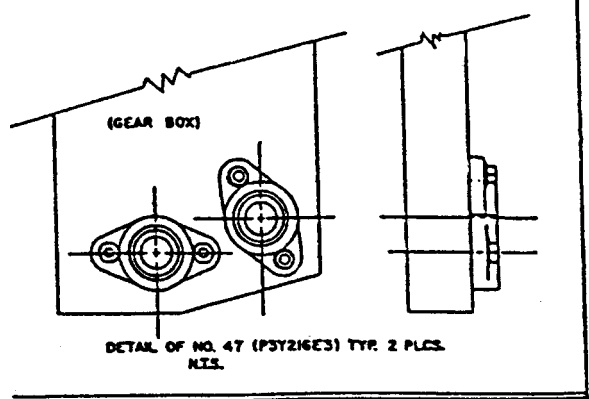

8 ROW 22"

BASIC MACHINE

ONE STEP PARTS LIST (1988–1990)

Parts List

<u>Item No.</u>	<u>Obsolete No.</u>	<u>Order No.</u>	<u>Description</u>
1.	80000	800000★	Three Point Hitch
	800100	116001	Three Point Pin
2.	900099	900099	Main Frame
3.	227-23	120002	Tire and Wheel (obsolete, requires kit # 405020)
4.	215-209	990080	Wheel Axle
5.	435-39	900249★	Wheel Mounting Assembly
6.	313-348	990173	Wheel Guard Spacer
7.	210-268	900361★	Pickup Head Roller
8.	240-691	900317★	Hex Roller
9.	240-635	900357★	4" Rear Roller
10.	900003	900003	Finger Shaft (167 ⁷ / ₈ "
11.	900004	900004	Finger Shaft (167 ⁷ / ₈ "
12.	504-67	106000	Rubber Finger
13.	461-41	103001	Cam Track–Right Hand
Not Shown	461-40	103000	Cam Track–Left Hand
14.	461-33	119027	Spider Cast End
15.	461-34	119028	Spider Cast Center
16.	504-68	118015	Rotor Rod
17.	118-3	103023	Clip, 3-hole Rotor Rod
18.	118-4	103024	Clip, 2-hole Rotor Rod
19.	20-1911	900243★	Rotor Rod Mount
20.	20-1907	900572	Right Hand Hinge Bracket} Replaced by 900573
21.	132-427	103044	Cam Arm
22.	20-2879	900334	Idler Sprocket Mount
23.	900019-R	900019-R	End Plate - Right Hand
24.	900019-L	900019-L	End Plate - Left Hand
25.	313-445	900377	Rotor Rod Spacer, R.H.
26.	313-446	No longer mfg.	Rotor Rod Spacer, L.H.
27.	SP50BS60	119008	Sprocket, Pickup Head R.H.
28.	SP50BS15	119006	Sprocket, Hex Tube R.H.
29.	SP40BS26	119003	Sprocket, Hex Tube L.H.
30.	SP40BS15	119004	Sprocket, Pickup Head L.H.
31.	SP50BS13	119010	Sprocket Idler
32.	13-72	106004	Flangett 52 MS
33.	13-39	106013	Flangett 52 MST
34.	313-410	900570	Spacer Hinge
35.	124-24	102005	1" Lock Collar (See Item 38)

★ This part is manufactured on a built-to-order basis only. Call Pickett Equipment for availability and lead time.

ONE STEP PARTS LIST (1988–1990)

Parts List

<u>Item No.</u>	<u>Obsolete No.</u>	<u>Order No.</u>	<u>Description</u>
36.	237-360	103012	Chain, #50 Roller 38 Links
37.	CO4020	103007	Chain, #40 Roller 20 Links
38.	202-20	102005	1" Bearing Insert with Lock Collar
39.	900120	900120★	Guy Rods Front and Rear
40.	684-41	103039	Proof Coil Chain 3/16"
41.	900023-B★	900565	Chain Case Shank R.H.(♦ See Note)
42.	900020★	900950	End Shank Slotted(♦ See Note)
43.	900026	900461–188	Cutter Rod 1" Solid
44.	900027	900027	Kicker Rod 83"–8-22 Drive
Not Shown		900026	Kicker Rod 85"–8-22 End
Not Shown		900028	Kicker Rod 55½"–6-30
Not Shown		900029	Kicker Rod 57½"–6-30
Not Shown		900030	Kicker Rod 57½"–6-30
45.	900022★	900407-R	Single Hole Shank(♦ See Note)
46.	DS208TT6	102000	Bearing 1" Square
47.	P3Y216E3	102016	Bearing 2-Hole Flange
48.	900021★	900950	Center Double Hole Shank(♦ See Note)
49.	900118	900413	Shroud, Left Hand
		900414	Shroud, Right Hand
51.	REC-197	118000	Rod End
52.		900316	Outer Chain Guard
54.	¾" x 9"	106009	Bolt ¾" x 9" Grade 8
57.	200-107	102015	Bearing Cam with 5/8" Jam Nut & Washer

To use shanks no.'s 900565, 900950, 900407-R, contact Pickett Equipment or your local dealer for conversion update information.

★ This part is manufactured on a built-to-order basis only. Call Pickett Equipment for availability and lead time.

Conversion Kits available for this machine (See Service Update Section)

<u>Kit No.</u>	<u>Description</u>	<u>Kit No.</u>	<u>Description</u>
405021	Gauge Wheel Conversion Kit (converts model '88–'91 to '92)	900800-822	Chain Case Update (8 row 22")
900754	Center Dump Table Kit★ (converts model-'91–'92 to '93)	900800-630	Chain Case Update (6 row 30")
900755	Semi-end Table Kit★ (converts model '91–'92 to '93)	901246	Pick up Head Conversion Kit
900605	Shank Point Conversion Kit (shear point)	Obsolete Kit No. UPH 940003	(6 row 30" & 8 row 22")
		900606	Shank Point Conversion Kit (45° rock point)
		405020	Small Wheel Conversion Kit

★ Also used in conjunction with kit no. 405022 & 405023 to convert models '91–'92 to '93.

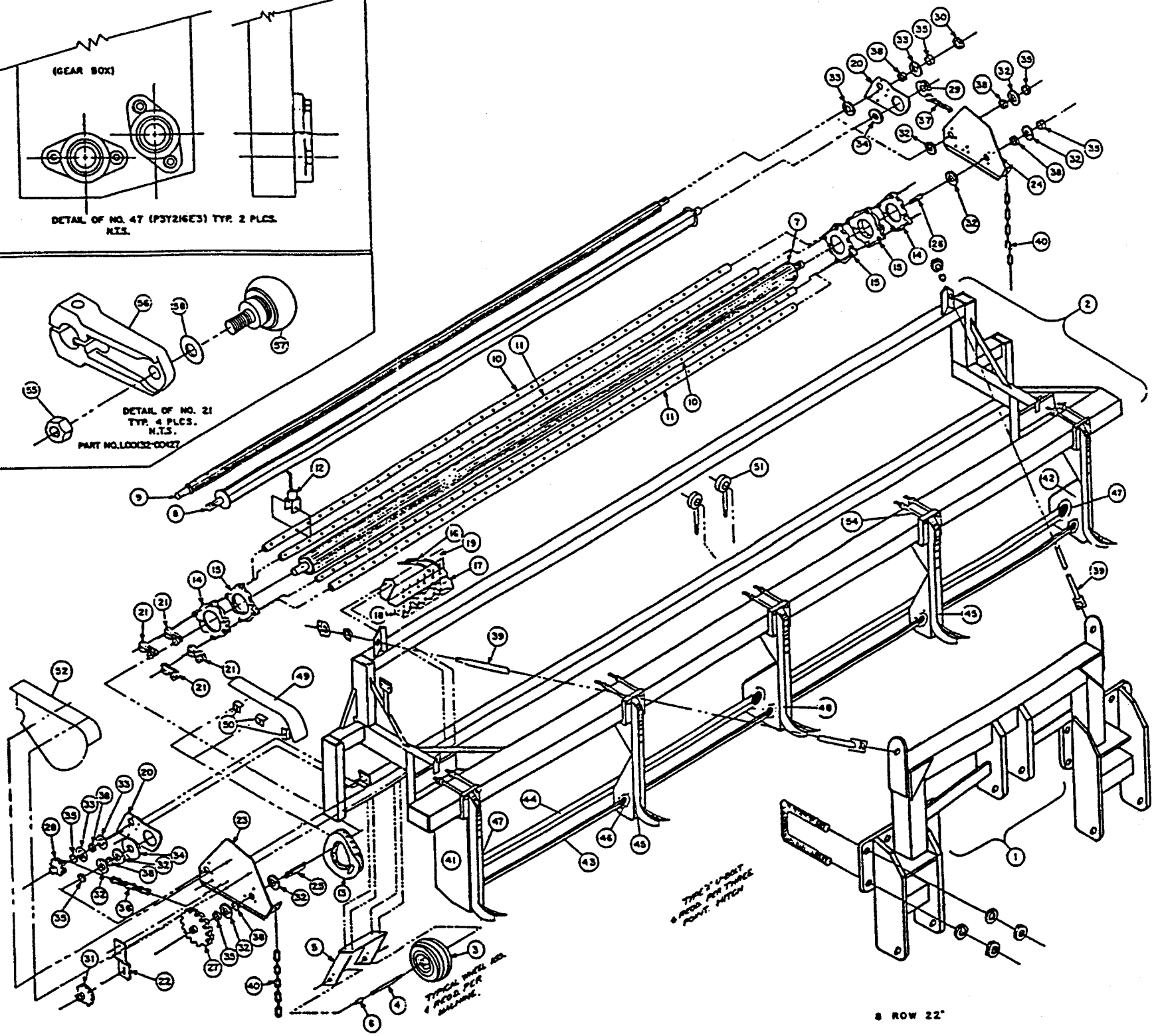
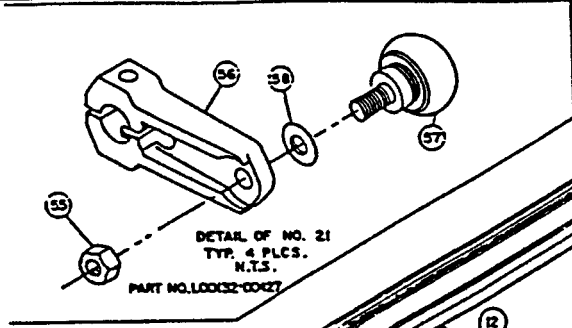
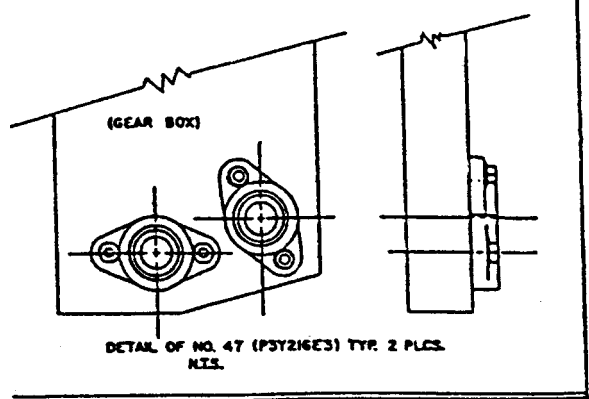

TYP. 1/2 LB. WT.
8 Pcs. PER TYPICAL
POINT. FITTING

TYPICAL WHEEL NO.
1 Pcs. PER
MACHINE.

8 ROW 22"

BASIC MACHINE

DETAILED VIEW OF ITEM NO.69

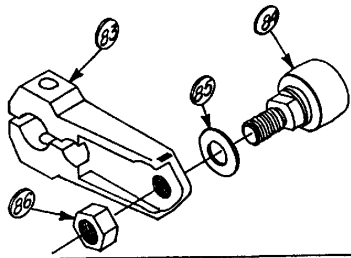

DETAILED VIEW OF PTO GEAR BOX

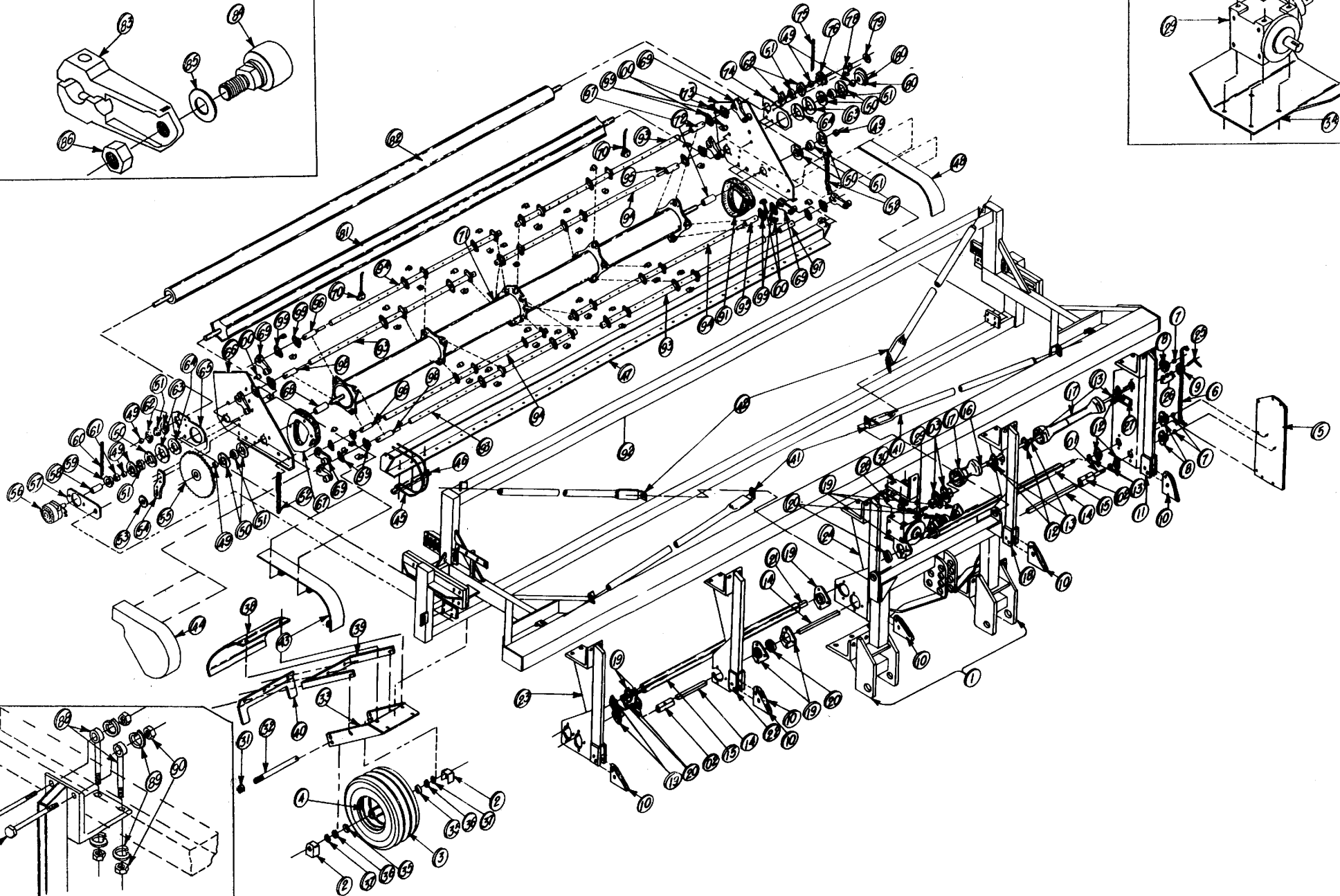
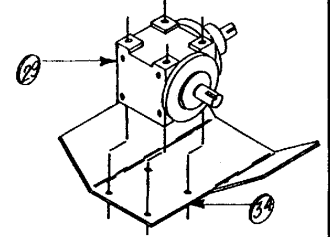

TYPICAL MOUNTING HARDWARE FOR 6x4 TOOL BAR

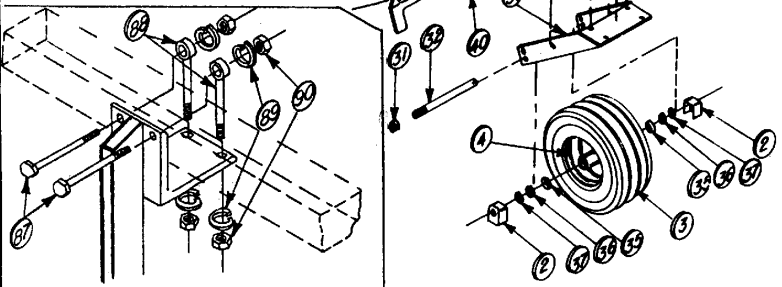

ONE STEP PARTS LIST (1991)

Parts List

<u>Item No.</u>	<u>Obsolete No.</u>	<u>Order No.</u>	<u>Description</u>
1.	800000	800000★	Three Point Hitch
Not Shown	800100	116001	Three Point Pin
2.	900243	990173	Wheel Guard
3.	18 x 9.5-8	120000	Tire
4.	101148-4600	123000	Steel Wheel (obsolete, requires kit # 405020)
6.	CO6036	103013	Chain, #60 Roller 36
8.	SP60BS12	119014	Sprocket Chain Case
9.	G160-13	119017	Sprocket Idler
10.	900372	116006	Point, Shear
Not Shown	116007	116023	Point, Rock
11.	900403★	900565	Left Hand Chain Case(♦ See Note)
12.	P3Y216E3	102016	Bearing 2 Hole Flange
14.		900461-82291	1" Cutter Rod 8-2291
		900461-63091	1" Cutter Rod 9-3091
15.	900027	900027	Kicker Tube 83" Drive
	900026	900026	Kicker Tube 85" End (900026 & 900027 Used on 8 row 22")
	900028	900028	Kicker 55½" Drive
	900029	900029	Kicker 57½" Center
	900030	900030	Kicker 57½" End (900028, 900029, 900030 Used on 6 row 30")
16.	900182	900182	PTO Drive Shaft 74½" 8-22
	900182	900182	PTO Drive Shaft 80" 6-30
17.	303-1248	103031	PTO Plastic Cover
18.	900406★	900585	Shank 1 Hole with Drive Hole(♦ See Note)
19.	F80-MS	106007	Flangett Housing
20.	0208-TT6	102000	Bearing 1" Square
21.	900032	900032	Kicker Key 7"
22.	900407	900407	Shank 1 Hole without PTO
23.	900408	900405	Shank End 2 Hole without PTO
24.	900405	900405	Shank Center 2 Hole without PTO
25.	900033	900033	Idler Sprocket Bolt

Conversion Kits available for this machine (See Service Update Section)

<u>Kit No.</u>	<u>Description</u>	<u>Kit No.</u>	<u>Description</u>
405022	Gauge Wheel Conversion Kit (converts model '91 to '93)	900800-822	Chain Case Update (8 row 22")
		900800-630	Chain Case Update (6 row 30")
900754	Center Dump Table Kit★ (converts model '91 to '93)	901246	Pick Up Head Conversion Kit
		Obsolete No. UPH 940003	(6 row 30" & 8 row 22")
900755	Semi-end Table Kit★ (converts model '91 to '93)	405020	Small Wheel Conversion Kit

ONE STEP PARTS LIST (1991)

Parts List

<u>Item No.</u>	<u>Obsolete No.</u>	<u>Order No.</u>	<u>Description</u>
27.	900170	900170	Idler Sprocket Plate
28.	900181	900181	PTO Spacer
29.	A101-E	107001	Gear Box Left Hand
30.	900180	900180★	Gear Box Mount (can be updated)
32.	215-209	990080	Axle
33.	900249	900249★	Wheel Mount
34.	900254	900254★	PTO Shield (can be updated)
35.	L44610	102002	Bearing Race
36.	L44643	102001	Wheel Bearing
37.	204029	119024	Bearing Seal
38.	900247	900247★	Fender
39.	900252	900252★	Scraper Bracket
40.	900210	900210★	Mud Scraper
41.	900335	900335★	Guy Rod Front
42.	900336	900336★	Guy Rod Rear
43.	900414	900414	Shroud Right Hand
44.	900316	900316	Chain Guard 50 Chain
45.	504-68-2	118015	Rotor Rod
46.	118-3	103023	Clip Rotor Rod 3 Hole
47.	900203	900203	Rotor Rod Mount
48.	900413	900413	Shroud Left Hand
50.	52 MS	106004	Flangett 3 Hole
51.	202-20	102005	Bearing 1" Insert with Lock Collar
52.		103039	Chain Pickup Head
53.	SP50BS13	119010	Sprocket Idler
54.	20-2879	900334	Idler Sprocket Mount
55.	SP50BS60	119008	Sprocket Pickup Tube
56.	110A001-ASO	113023	Hydraulic Pickup Motor
	110A-071-ASO		
57.	609010	900225	Hydraulic Motor Mount
58.	P-100-100	103017	Coupler 1" × 1" × 3" Split
59.	SP50BS15	119006	Sprocket Hex Tube R.H.
60.	237-60	103012	Chain #50 Roller 39
62.	F52-MST	106013	Flangett 2 Hole
63.	733-30	900571	Hinge Lock
64.	313-410	900570	Hinge Spacer
65.	20-1907	900572	Hinge Bracket R.H. } Replaced by 900573
66.	900010-4	900019-R	Mounting End Plate R.H.
67.	461-41	103001	Cam Track R.H.
68.	900377	900377	Spacer Rotor R.H.

ONE STEP PARTS LIST (1991)

Parts List

<u>Item No.</u>	<u>Obsolete No.</u>	<u>Order No.</u>	<u>Description</u>
69.	900281-A	103044	Cam Arm
70.	504-67	106000	Finger Rubber
71.	900400	900400★	Pickup Tube Assembly
72.	900378	900378	Spacer Rotor L.H.
73.	900019-4	900019-L	Mounting End Plate L.H.
74.	20-19075	900573	Hinge Bracket L.H. Slotted
75.	CO4038	103007	Chain #40 Roller
76.	SP40BS15	119004	Sprocket 4" Roller
78.	900137	900137	Idler Sprocket Mount
79.	SP4017	119005	Sprocket Idler
80.	SP40BS26	119003	Sprocket Hex Roller
81.	900401	900401	Hex Roller
82.	900402	900402	Roller 4"
84.	200-107	102015	Bearing Cam
87.	7509-G8	106009	Bolt 3/4" x 9"
88.	REC-197	118000	Rod End
91.	461-40	103000	Cam Track L.H.
92.	900099	900099-91	Main Frame
93.	900360	900360	Finger Rod 86 ³ / ₄ "
94.	900359	900359	Finger Rod 84 ³ / ₄ "
95.	900275L	119068	Shaft Plug Finger Rod
96.	900275R	119069	Shaft Plug Finger Rod
97.	900276L	119070	Shaft Plug Finger Rod
98.	900276R	119071	Shaft Plug Finger Rod
99.	40 MST	106002	Flangett Two Hole
00.	900333	102034	Plastic Bushing End
Not Shown	900333-S	102035	Plastic Bushing Center
01.	900211	900211	Stub Shaft
02.	900373	900373	Cutter Rod Coupler
03.	999-2000	103025	Clutch, Shear (PTO)

*Also used in conjunction with kit no. 405022 to convert model '91 to '93

◆ To use shank No.'s 900565 and 900585, contact Pickett Equipment or your local dealer for conversion update information.

★ This part is manufactured on a built-to-order basis only. Call Pickett Equipment for availability and lead time.

MODEL 92
ONE-STEP (MAIN FRAME)

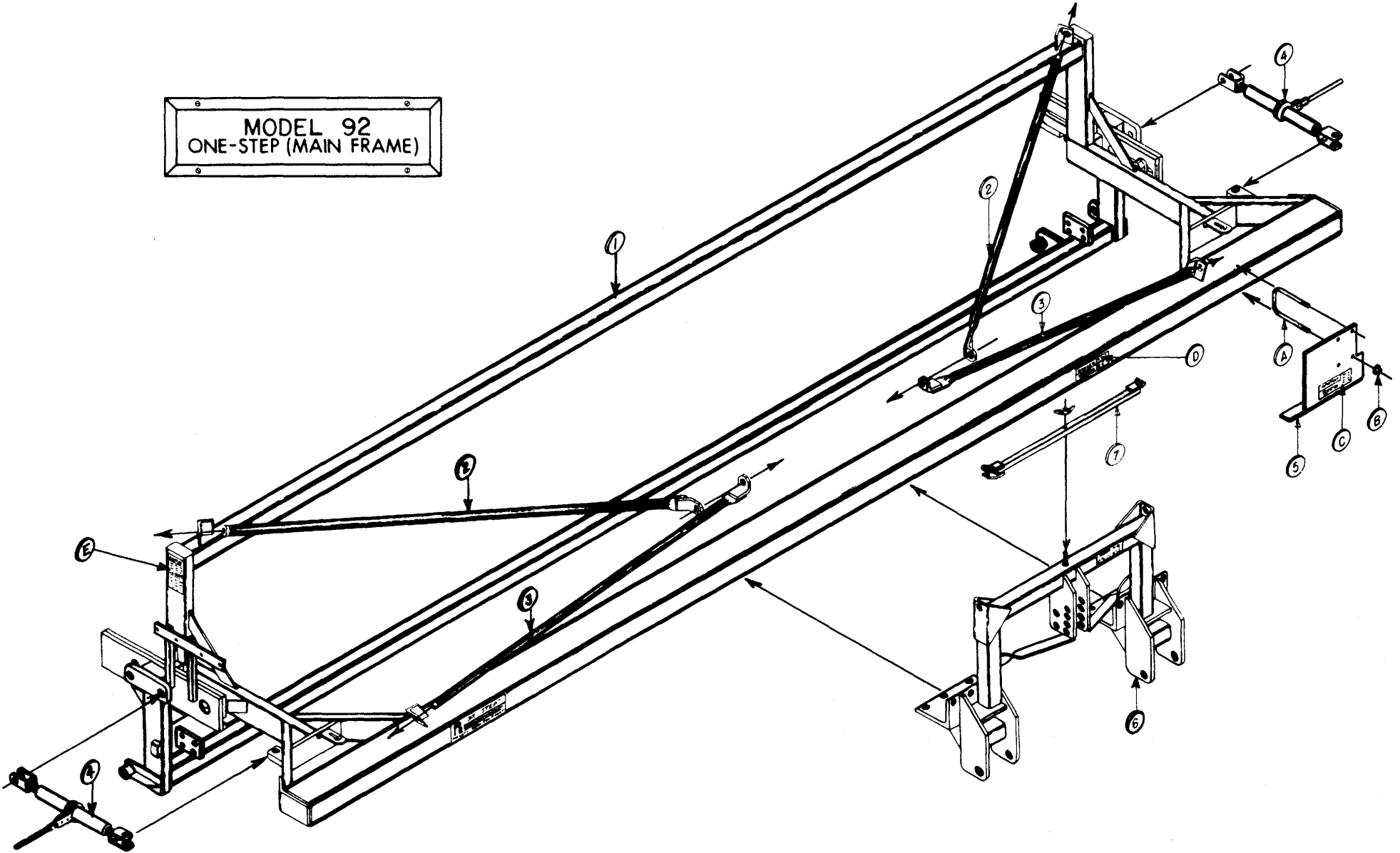

ONE STEP MAIN FRAME 6-30 & 8-22 (1992)*Parts List*

<u>Item No.</u>	<u>Part No.</u>	<u>Description</u>
1.	900099-92	Main Frame, Standard (6 row 30" & 8 row 22")
2.	900336	Rear Guy Rod (78") See Three Point Hitch Section for mounting hardware
3.	900335	Front Guy Rod (59½") See Three Point Hitch Section for mounting hardware
4.	120003	Turnbuckle Ratchet Jack Option (Kit No. 405000)
5.	900613	Driveline Shear Clutch Shield
6.	800000	Three Point Hitch See Three Point Hitch Section for mounting hardware
7.	900287	Divider Point Adjustment / Pick Up Head Tool

Hardware List

<u>Item No.</u>	<u>Part No.</u>	<u>Description</u>
A.	121010	U-Bolt, Type H— $\frac{3}{8}$ " \times $4\frac{1}{16}$ " \times $6\frac{5}{8}$ "
B.		$\frac{3}{8}$ " NC Whiz Nut
C.	112004	Chain Tension Warning Label
D.	112005	Driveline Warning Label
E.	112006	Operation & Safety Warning Label

ONE STEP MAIN FRAME 6-30 & 8-22 (1993)

Parts List

<u>Item No.</u>	<u>Part No.</u>	<u>Description</u>
1.	900099-93	Main Frame, Standard (6 row 30" & 8 row 22")
2.	900336	Rear Guy Rod (78") See Three Point Hitch Section for mounting hardware
3.	900335	Front Guy Rod (59 1/2") See Three Point Hitch Section for mounting hardware
4.	120003	Turnbuckle Ratchet Jack
5.	900613	Driveline Shear Clutch Shield
6.	800000	Three Point Hitch See Three Point Hitch Section for mounting hardware
7.	900287	Divider Point Adjustment / Pick Up Head Tool

Hardware List

<u>Item No.</u>	<u>Part No.</u>	<u>Description</u>
A.	121010	U-Bolt, Type—3/8" × 4 1/16" × 6 5/8"
B.		3/8" NC Whiz Nut
C.	112004	Chain Tension Warning Label
D.	112005	Driveline Warning Label
E.	112006	Operation & Safety Warning Label

One Step Main Frame

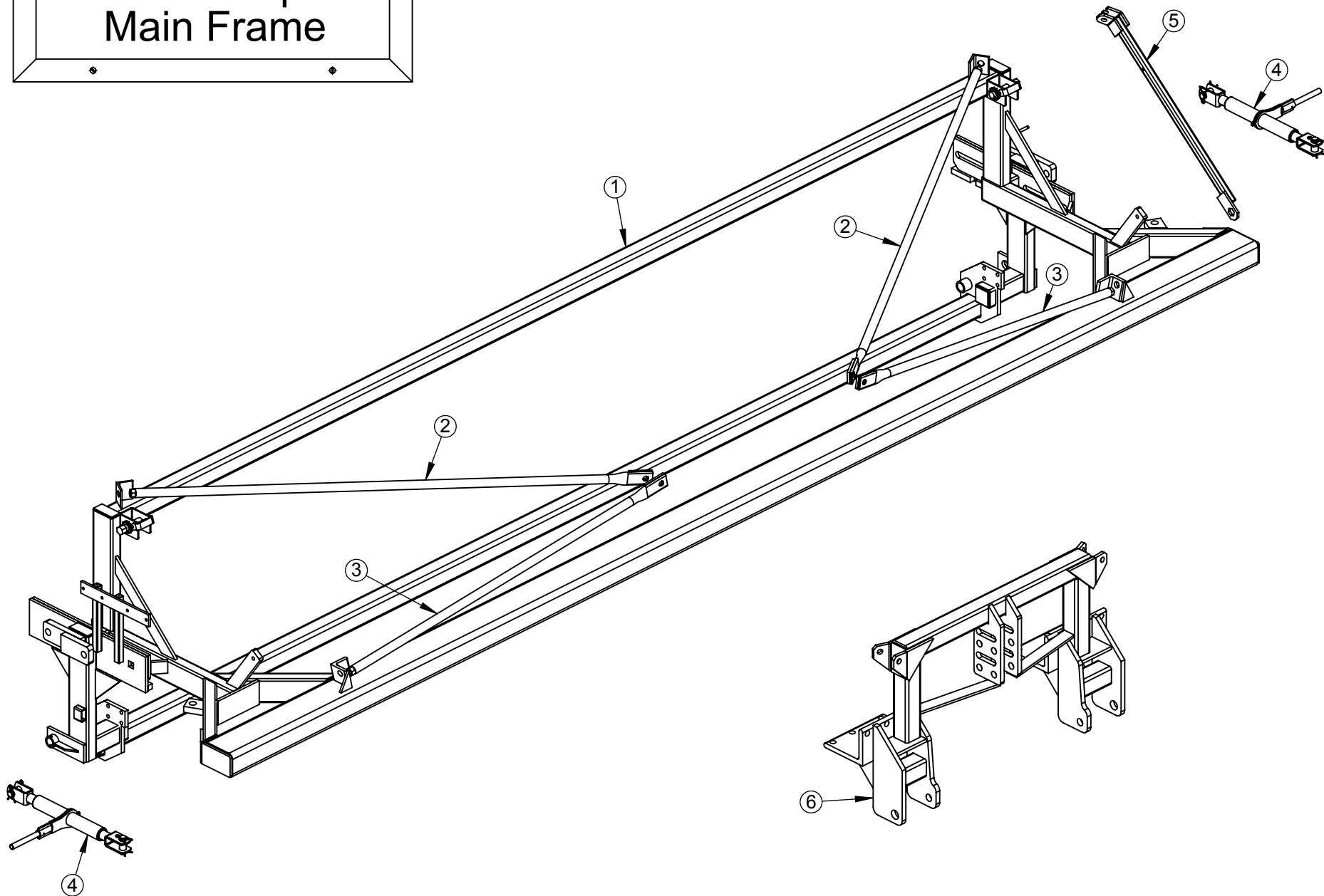

ONE STEP MAIN FRAME 6 Row 30 & 8 Row 22**Parts List**

<u>Item No.</u>	<u>Part No.</u>	<u>Description</u>
1.	900099-630	Main Frame, Standard
2.	800040	Rear Guy Rod
3.	800039	Front Guy Rod
4.	120003	Turnbuckle Ratchet Jack
5.	901475	Divider Point Adjustment / Pickup Head Tool
6.	800001	Three Point Hitch

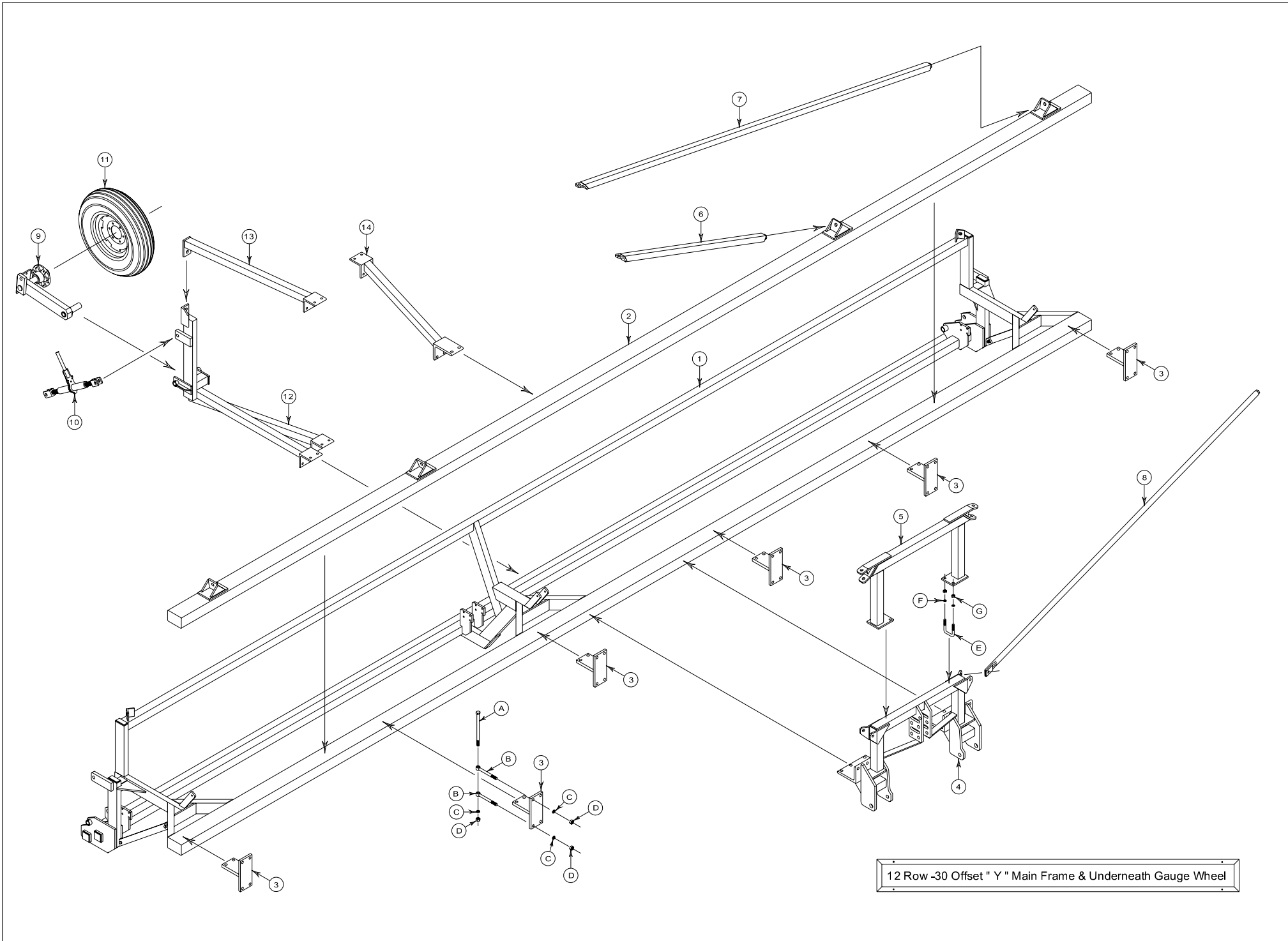

12 ROW 30 Offset “Y” Main Frame & Underneath Gauge Wheel

Parts List

<u>Item No.</u>	<u>Part No.</u>	<u>Description</u>
1.	901663	Offset “Y” Main Frame
2.	901650	Top Tool Bar (Bolt-on)
3.	901590	Tool Bar T-Mount
4.	800001	Three Point Hitch
5.	800150	Guy Rod Extension Mount
6.	800145	Inside Front Guy Rod (66” long) 2 Required
7.	800146	Outside Front Guy Rod (153” long) 2 Required
8.	800160	Rear Guy Rod (161” long) 2 Required
9.	901750	R.H. Pivot Arm Assembly – Includes Hub (L.H. Arm – Including Hub # 901751)
10.	120003	Turnbuckle, Gauge Wheel Ratchet Jack
11.	123014	Tire Assembly (includes Steel Wheel # 123003, Tire # 120008)
12.	804230	Underneath Rear Gauge Wheel Mount (for use with 42” Wide Trays)
13.	804227	Gauge Wheel Brace Tube
14.	804221	Front Tool Bar Brace

Hardware List

<u>Item No.</u>	<u>Part No.</u>	<u>Description</u>
A.	106059	$\frac{3}{4}$ ” x 12” NC Hex Bolt–Grade 8
B.	118032	$\frac{3}{4}$ ” x 8” NC Eye Bolt–Grade 8
C.		$\frac{3}{4}$ ” Lock Washer
D.		$\frac{3}{4}$ ” NC Hex Nut–Grade 8
E.	121003	U-Bolt, Type D ($\frac{5}{8}$ ” x 3” x 4 $\frac{1}{2}$ ”)
F.		$\frac{5}{8}$ ” Lock Washer
G.		$\frac{5}{8}$ ” NC Hex Nut–Grade 5

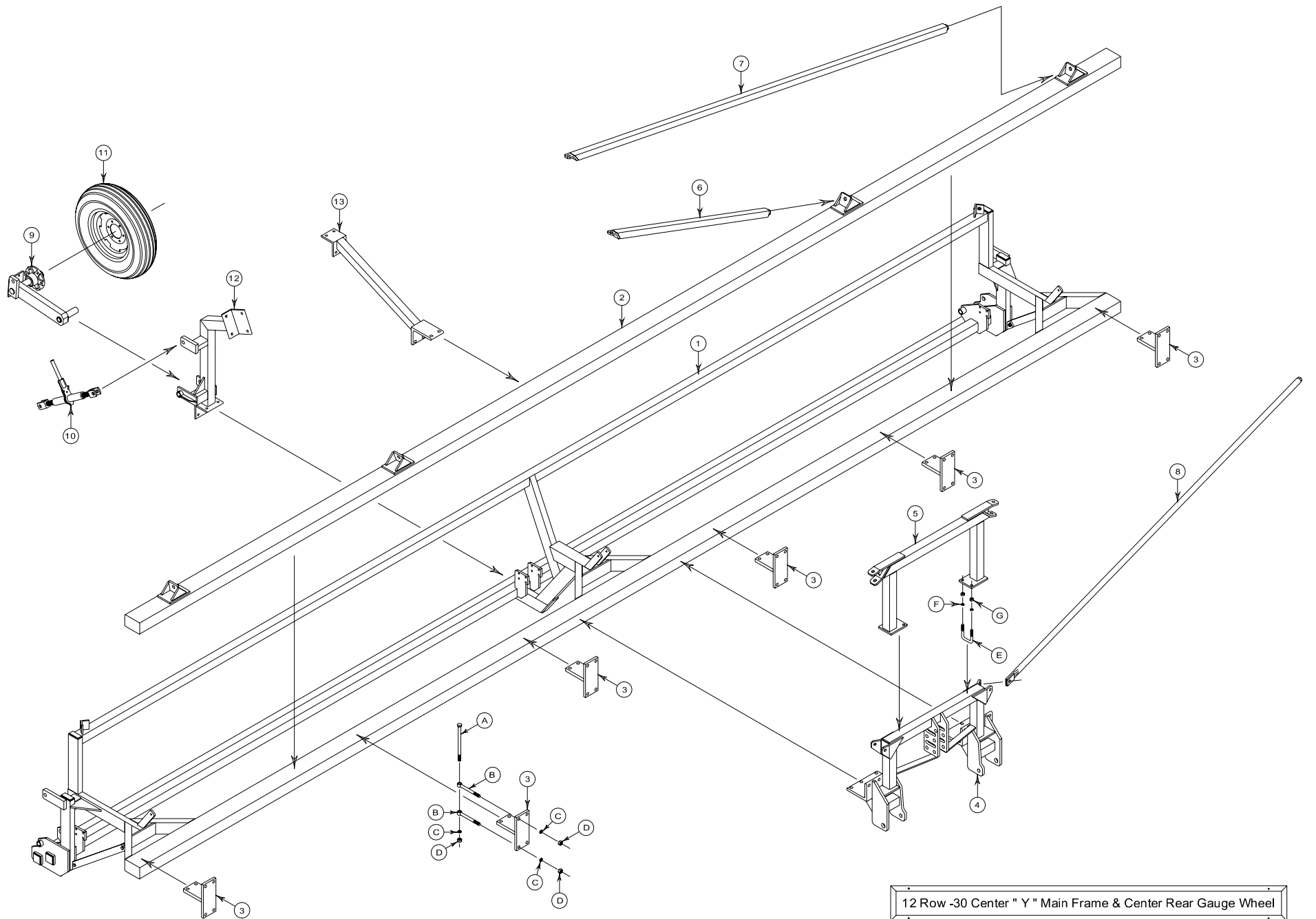

12 Row -30 Center "Y" Main Frame & Center Rear Gauge Wheel

12 ROW 30 Center “Y” Main Frame & Center Rear Gauge Wheel

Parts List

<u>Item No.</u>	<u>Part No.</u>	<u>Description</u>
1.	901633	Center “Y” Main Frame
2.	901650	Top Tool Bar (Bolt-on)
3.	901590	Tool Bar T-Mount
4.	800001	Three Point Hitch
5.	800150	Guy Rod Extension Mount
6.	800145	Inside Front Guy Rod (66” long) 2 Required
7.	800146	Outside Front Guy Rod (153” long) 2 Required
8.	800160	Rear Guy Rod (161” long) 2 Required
9.	901750	R.H. Pivot Arm Assembly – Includes Hub (L.H. Arm – Including Hub # 901751)
10.	120003	Turnbuckle, Gauge Wheel Ratchet Jack
11.	123014	Tire Assembly (includes Steel Wheel # 123003, Tire # 120008)
12.	804235	Center Gauge Wheel Mount (for use with Center Dump Trays)
13.	804221	Front Tool Bar Brace (optional on this model)

Hardware List

<u>Item No.</u>	<u>Part No.</u>	<u>Description</u>
A.	106059	¾” x 12” NC Hex Bolt–Grade 8
B.	118032	¾” x 8” NC Eye Bolt–Grade 8
C.		¾” Lock Washer
D.		¾” NC Hex Nut–Grade 8
E.	121003	U-Bolt, Type D (5/8” x 3” x 4 ½”)
F.		5/8” Lock Washer
G.		5/8” NC Hex Nut–Grade 5