

# One Step Rod Cutter Rear Pull

## **Cutter Rods & Kicker Rods**

## **Section 12**

Model Years 1988 – 1990 .....	2-5
Model Year 1991 .....	6-9
Model Years 1992 – 1993 .....	10-11
Model Years 1994 – 1995 (Standard Shank Layout) Inside Chain Case .....	12-15
Model Years 1994 – 1995 (C-Shank Layout) Inside Chain Case .....	16-17
Model Year 1994 (C-Shank Layout).....	18-19
Model Years 1996 – Present (Standard Shank Layout) Inside Chain Case .....	20-23
Model Years 1996 – Present (C-Shank Layout) Inside Chain Case.....	24-25
Model Years 1996 – Present (C-Shank Layout) Outside Chain Case .....	26-27
Optional C-Shank w/Belly Shank Layout (8 Row 22 & 8 Row 30).....	28
Optional C-Shank w/Belly Shank Layout (8 Row 30 & 12 Row 12).....	29
Model Years 2005 – Present (12 Row 30) Standard Shank Layout .....	30-31
Model Years 2005 – Present (12 Row 30) Standard Shank w/Belly Shank Layout .....	32-33
Model Years 2005 – Present (12 Row 30) C-Shank Layout.....	34-35
Two 1 1/4" Cutter Rods (8 Row 30) Standard Shank w/Belly Shank Layout.....	36-37
Two 1 1/4" Cutter Rods (12 Row 22) Standard Shank w/Belly Shank Layout.....	38-39

Return to this page by clicking the upper right corner of any page in this section.

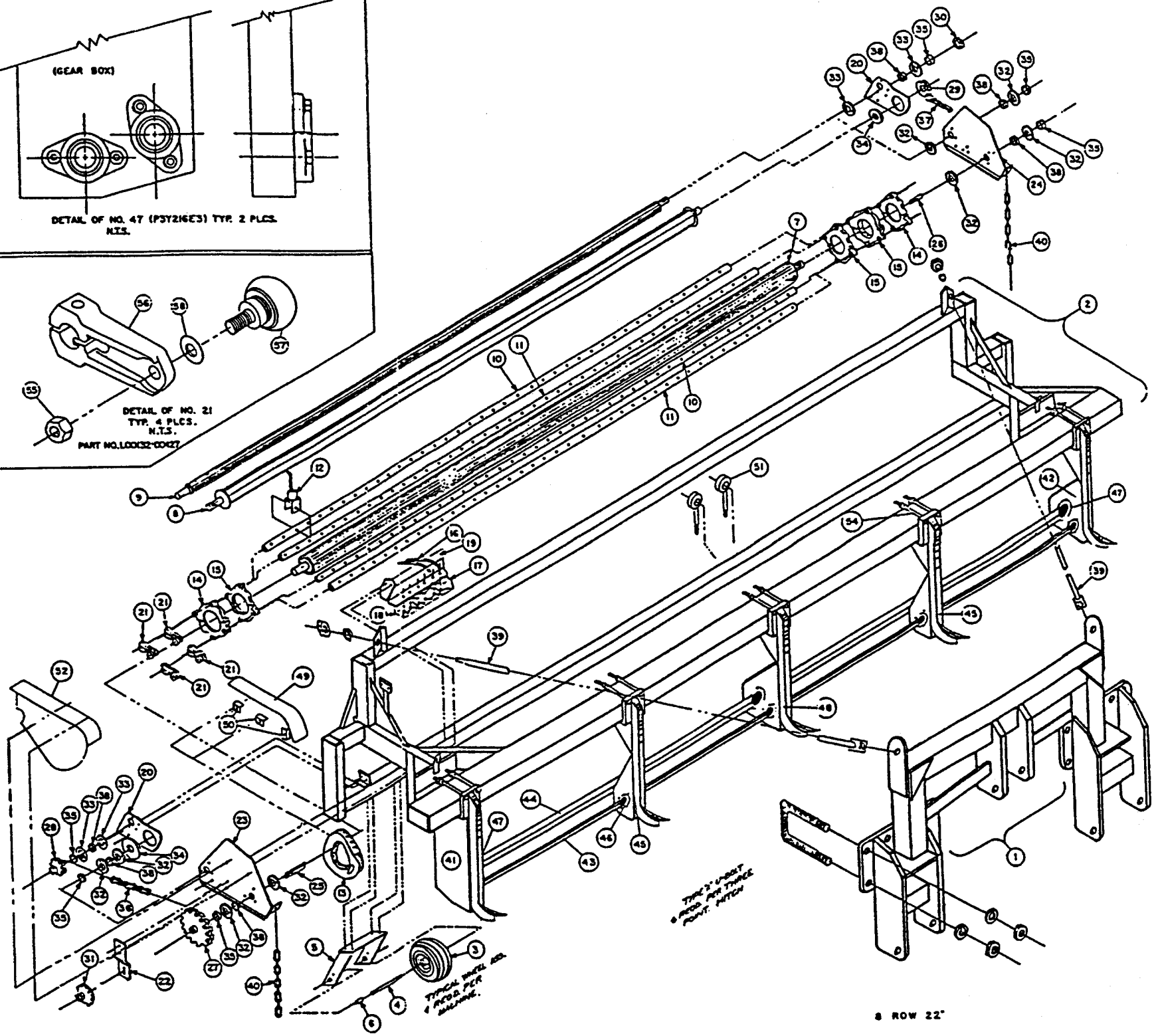
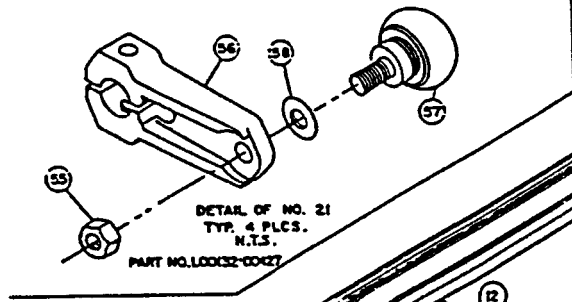
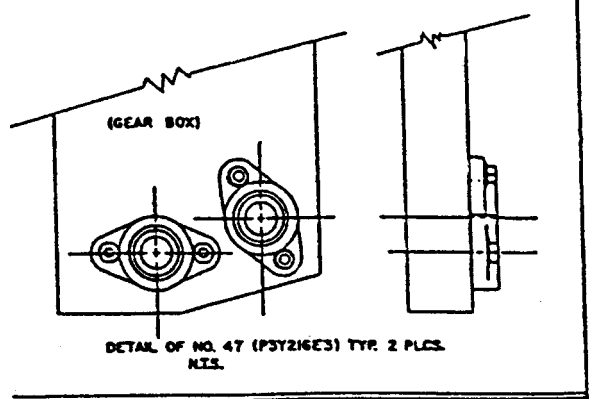

BASIC MACHINE

## ONE STEP PARTS LIST (1988–1990)

### Parts List

<u>Item No.</u>	<u>Obsolete No.</u>	<u>Order No.</u>	<u>Description</u>
1.	80000	800000★	Three Point Hitch
	800100	116001	Three Point Pin
2.	900099	900099	Main Frame
3.	227-23	120002	Tire and Wheel (obsolete, requires kit # 405020)
4.	215-209	990080	Wheel Axle
5.	435-39	900249★	Wheel Mounting Assembly
6.	313-348	990173	Wheel Guard Spacer
7.	210-268	900361★	Pickup Head Roller
8.	240-691	900317★	Hex Roller
9.	240-635	900357★	4" Rear Roller
10.	900003	900003	Finger Shaft (167 <sup>7</sup> / <sub>8</sub> "
11.	900004	900004	Finger Shaft (167 <sup>7</sup> / <sub>8</sub> "
12.	504-67	106000	Rubber Finger
13.	461-41	103001	Cam Track–Right Hand
Not Shown	461-40	103000	Cam Track–Left Hand
14.	461-33	119027	Spider Cast End
15.	461-34	119028	Spider Cast Center
16.	504-68	118015	Rotor Rod
17.	118-3	103023	Clip, 3-hole Rotor Rod
18.	118-4	103024	Clip, 2-hole Rotor Rod
19.	20-1911	900243★	Rotor Rod Mount
20.	20-1907	900572	Right Hand Hinge Bracket}Replaced by 900573
21.	132-427	103044	Cam Arm
22.	20-2879	900334	Idler Sprocket Mount
23.	900019-R	900019-R	End Plate–Right Hand
24.	900019-L	900019-L	End PlateLeft Hand
25.	313-445	900377	Rotor Rod Spacer, R.H.
26.	313-446	No longer mfg.	Rotor Rod Spacer, L.H.
27.	SP50BS60	119008	Sprocket, Pickup Head R.H.
28.	SP50BS15	119006	Sprocket, Hex Tube R.H.
29.	SP40BS26	119003	Sprocket, Hex Tube L.H.
30.	SP40BS15	119004	Sprocket, Pickup Head L.H.
31.	SP50BS13	119010	Sprocket Idler
32.	13-72	106004	Flangett 52 MS
33.	13-39	106013	Flangett 52 MST
34.	313-410	900570	Spacer Hinge
35.	124-24	102005	1" Lock Collar (See Item 38)
36.	237-360	103012	Chain, #50 Roller 38 Links
37.	CO4020	103007	Chain, #40 Roller 20 Links
38.	202-20	102005	1" Bearing Insert with Lock Collar

**ONE STEP PARTS LIST--(1988--1990)****Parts List**

<u>Item No.</u>	<u>Obsolete No.</u>	<u>Order No.</u>	<u>Description</u>
39.	900120	900120★	Guy Rods Front and Rear
40.	684-41	103039	Proof Coil Chain $\frac{3}{16}$ "
41.	900023-B★	900565	Chain Case Shank R.H.(♦ See Note)
42.	900020★	900950	End Shank Slotted(♦ See Note)
43.	900026	900461-188	Cutter Rod 1" Solid, 6-30 & 8-22 (1988-89)
Not Shown		900461-63	1" Cutter Rod 6 Row 30" (1990)
Not Shown		900461-60	1" Cutter Rod 6 Row 30" (1990)
Not Shown		900461-57.75	1" Cutter Rod 6 Row 30" (1990)
Not Shown		900461-47	1" Cutter Rod 8 Row 22" (1990)
Not Shown		900461-88	1" Cutter Rod 8 Row 22" (1990)
Not Shown		900461-41.75	1" Cutter Rod 8 Row 22" (1990)
44.	900027	900027	Kicker Rod 83"-8-22 Drive
Not Shown		900026	Kicker Rod 85"-8-22 End
Not Shown		900028	Kicker Rod 55 $\frac{1}{2}$ "-6-30
Not Shown		900029	Kicker Rod 57 $\frac{1}{2}$ "-6-30
Not Shown		900030	Kicker Rod 57 $\frac{1}{2}$ "-6-30
45.	900022★	900407-R	Single Hole Shank(♦ See Note)
46.	DS208TT6	102000	Bearing 1" Square
47.	P3Y216E3	102016	Bearing 2-Hole Flange
48.	900021★	900950	Center Double Hole Shank(♦ See Note)
49.	900118	900413	Shroud, Left Hand
		900414	Shroud, Right Hand
51.	REC-197	118000	Rod End
52.		900316	Outer Chain Guard
54.	$\frac{3}{4}$ " x 9"	106009	Bolt $\frac{3}{4}$ " x 9" Grade 8
57.	200-107	102015	Bearing Cam with $\frac{5}{8}$ " Jam Nut & Washer
Not Shown	900211	900211	Shaft, Stub (used with segmented cutter rod)
Not Shown	900373	900373	Coupler, Cutter Rod (used with segmented cutter rod)
Not Shown	103038	103038	Collar, 1" Lock (used with segmented cutter rod)

To use shanks no.'s 900565, 900950, 900407-R, contact Pickett Equipment or your local dealer for conversion update information.

★ This part is manufactured on a built-to-order basis only. Call Pickett Equipment for availability and lead-time.

## ONE STEP PARTS LIST--(1988--1990)

### Conversion Kits available for this machine (See Service Update Section)

<u>Kit No.</u>	<u>Description</u>	<u>Kit No.</u>	<u>Description</u>
405021	Gauge Wheel Conversion Kit (converts model '88-'91 to '92)	900800-822	Chain Case Update (8 row 22")
900754	Center Dump Table Kit*	900800-630	Chain Case Update (6 row 30")
900755	Semi-end Table Kit*	901246	Pick up Head Conversion Kit
900605	Shank Point Conversion Kit (shear point)	Obsolete Kit No. UPH 940003	(6 row 30" & 8 row 22")
		900606	Shank Point Conversion Kit (45° rock point)
		405020	Small Wheel Conversion Kit

\* Also used in conjunction with kit no. 405022 & 405023 to convert models '91-'92 to '93.

DETAILED VIEW OF ITEM NO.69

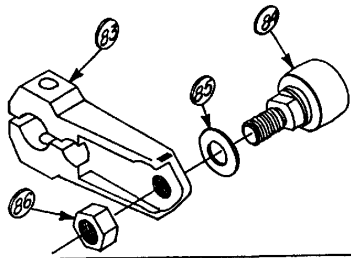

DETAILED VIEW OF PTO GEAR BOX

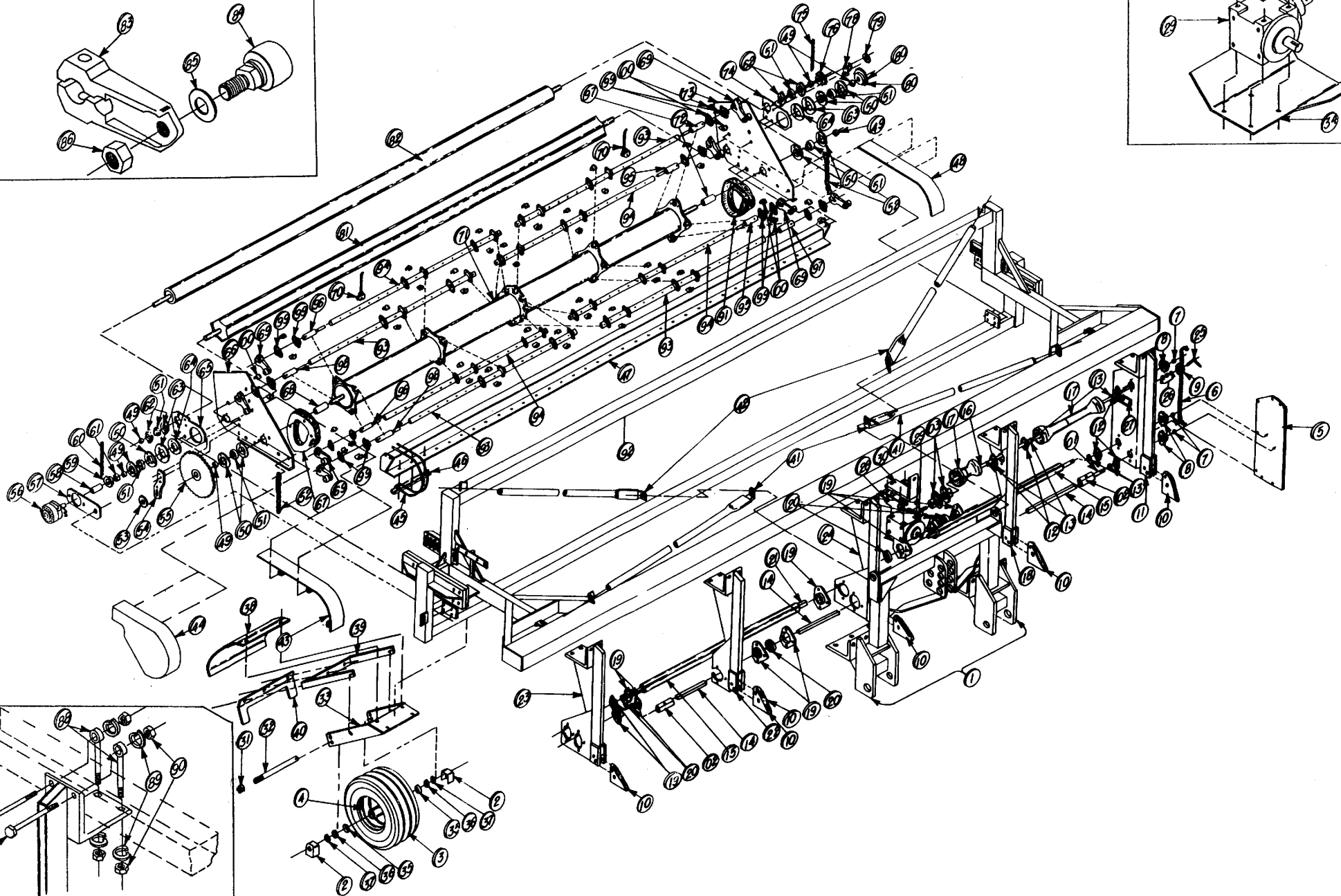
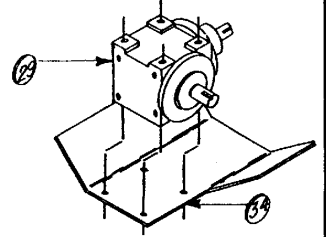

TYPICAL MOUNTING HARDWARE FOR 6x4 TOOL BAR

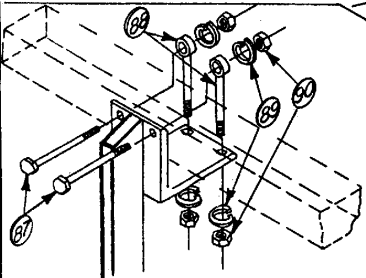

# ONE STEP PARTS LIST (1991)

## Parts List

<u>Item No.</u>	<u>Obsolete No.</u>	<u>Order No.</u>	<u>Description</u>
1.	800000	800000*	Three-Point Hitch
Not Shown	800100	116001	Three-Point Pin
2.	900243	990173	Wheel Guard
3.	18 x 9.5-8	120000	Tire
4.	101148-4600	123000	Steel Wheel (obsolete, requires kit # 405020)
6.	CO6036	103013	Chain, #60 Roller 36
8.	SP60BS12	119014	Sprocket Chain Case
9.	G160-13	119017	Sprocket Idler
10.	900372	116006	Point, Shear
Not Shown	116007	116023	Point, Rock
11.	900403*	900565	Left Hand Chain Case (**See Note)
12.	P3Y216E3	102016	Bearing 2 Hole Flange

14.		900461-82291	1" Cutter Rod 8-2291
		900461-63091	1" Cutter Rod 9-3091
15.	900027	900027	Kicker Tube 83" Drive
	900026	900026	Kicker Tube 85" End (900026 & 900027 Used on 8 row 22")
	900028	900028	Kicker 55½" Drive
	900029	900029	Kicker 57½" Center
	900030	900030	Kicker 57½" End (900028, 900029, 900030 Used on 6 row 30")

16.	900182	900182	PTO Drive Shaft 74½" 8-22
	900182	900182	PTO Drive Shaft 80" 6-30
17.	303-1248	103031	PTO Plastic Cover
18.	900406*	900585	Shank 1 Hole with Drive Hole (See Note)
19.	F80-MS	106007	Flangett Housing
20.	0208-TT6	102000	Bearing 1" Square
21.	900032	900032	Kicker Key 7"
22.	900407	900407	Shank 1 Hole without PTO
23.	900408	900405	Shank End 2 Hole without PTO
24.	900405	900405	Shank Center 2 Hole without PTO
25.	900033	900033	Idler Sprocket Bolt

## Conversion Kits available for this machine (See Service Update Section)

<u>Kit No.</u>	<u>Description</u>	<u>Kit No.</u>	<u>Description</u>
405022	Gauge Wheel Conversion Kit (converts model '91 to '93)	900800-822	Chain Case Update (8 row 22")
		900800-630	Chain Case Update (6 row 30")
900754	Center Dump Table Kit** (converts model '91 to '93)	901246	Pick Up Head Conversion Kit
900755	Semi-end Table Kit** (converts model '91 to '93)	Obsolete No. UPH 940003	(6 row 30" & 8 row 22")
		405020	Small Wheel Conversion Kit

# ONE STEP PARTS LIST (1991)

## Parts List

<u>Item No.</u>	<u>Obsolete No.</u>	<u>Order No.</u>	<u>Description</u>
27.	900170	900170	Idler Sprocket Plate
28.	900181	900181	PTO Spacer
29.	A101-E	107001	Gear Box Left Hand
30.	900180	900180*	Gear Box Mount (can be updated)
32.	215-209	990080	Axle
33.	900249	900249*	Wheel Mount
34.	900254	900254*	PTO Shield (can be updated)
35.	L44610	102002	Bearing Race
36.	L44643	102001	Wheel Bearing
37.	204029	119024	Bearing Seal
38.	900247	900247*	Fender
39.	900252	900252*	Scraper Bracket
40.	900210	900210*	Mud Scraper
41.	900335	900335*	Guy Rod Front
42.	900336	900336*	Guy Rod Rear
43.	900414	900414	Shroud Right Hand
44.	900316	900316	Chain Guard 50 Chain
45.	504-68-2	118015	Rotor Rod
46.	118-3	103023	Clip Rotor Rod 3-Hole
47.	900203	900203	Rotor Rod Mount
48.	900413	900413	Shroud Left Hand
50.	52 MS	106004	Flangett 3-Hole
51.	202-20	102005	Bearing 1" Insert with Lock Collar
52.		103039	Chain Pickup Head
53.	SP50BS13	119010	Sprocket Idler
54.	20-2879	900334	Idler Sprocket Mount
55.	SP50BS60	119008	Sprocket Pickup Tube
56.	110A001-ASO 110A-071-ASO	113023	Hydraulic Pickup Motor
57.	609010	900225	Hydraulic Motor Mount
58.	P-100-100	103017	Coupler 1" x 1" x 3" Split
59.	SP50BS15	119006	Sprocket Hex Tube R.H.
60.	237-60	103012	Chain #50 Roller 39
62.	F52-MST	106013	Flangett 2 Hole
63.	733-30	900571	Hinge Lock
64.	313-410	900570	Hinge Spacer
65.	20-1907	900572	Hinge Bracket R.H. } Replaced by 900573
66.	900010-4	900019-R	Mounting End Plate R.H.
67.	461-41	103001	Cam Track R.H.
68.	900377	900377	Spacer Rotor R.H.



# ONE STEP PARTS LIST (1991)

## Parts List

<u>Item No.</u>	<u>Obsolete No.</u>	<u>Order No.</u>	<u>Description</u>
69.	900281-A	103044	Cam Arm
70.	504-67	106000	Finger Rubber
71.	900400	900400*	Pickup Tube Assembly
72.	900378	900378	Spacer Rotor L.H.
73.	900019-4	900019-L	Mounting End Plate L.H.
74.	20-19075	900573	Hinge Bracket L.H. Slotted
75.	CO4038	103007	Chain #40 Roller
76.	SP40BS15	119004	Sprocket 4" Roller
78.	900137	900137	Idler Sprocket Mount
79.	SP4017	119005	Sprocket Idler
80.	SP40BS26	119003	Sprocket Hex Roller
81.	900401	900401	Hex Roller
82.	900402	900402	Roller 4"
84.	200-107	102015	Bearing Cam
87.	7509-G8	106009	Bolt 3/4" x 9"
88.	REC-197	118000	Rod End
91.	461-40	103000	Cam Track L.H.
92.	900099	900099-91	Main Frame
93.	900360	900360	Finger Rod 86 <sup>3</sup> / <sub>4</sub> "
94.	900359	900359	Finger Rod 84 <sup>3</sup> / <sub>4</sub> "
95.	900275L	119068	Shaft Plug Finger Rod
96.	900275R	119069	Shaft Plug Finger Rod
97.	900276L	119070	Shaft Plug Finger Rod
98.	900276R	119071	Shaft Plug Finger Rod
99.	40 MST	106002	Flangett Two Hole
00.	900333	102034	Plastic Bushing End
Not Shown	900333-S	102035	Plastic Bushing Center
01.	900211	900211	Stub Shaft
02.	900373	900373	Cutter Rod Coupler
03.	999-2000	103025	Clutch, Shear (PTO)

Not Shown	900461-42.1875	1" Cutter Rod 8 Row 22" (1991)
Not Shown	900461-87.625	1" Cutter Rod 8 Row 22" (1991)
Not Shown	900461-43	1" Cutter Rod 8 Row 22" (1991)
Not Shown	900461-58.125	1" Cutter Rod 6 Row 30" (1991)
Not Shown	900461-59.4375	1" Cutter Rod 6 Row 30" (1991)
Not Shown	900461-59.25	1" Cutter Rod 6 Row 30" (1991)

\*This part is manufactured on a built-to-order basis only. Call Pickett Equipment for availability and lead time.

\*\*Also used in conjunction with kit no. 405022 to convert model '91 to '93

\*\*\*To use shank No.'s 900565 and 900585, contact Pickett Equipment or your local dealer for conversion update information.

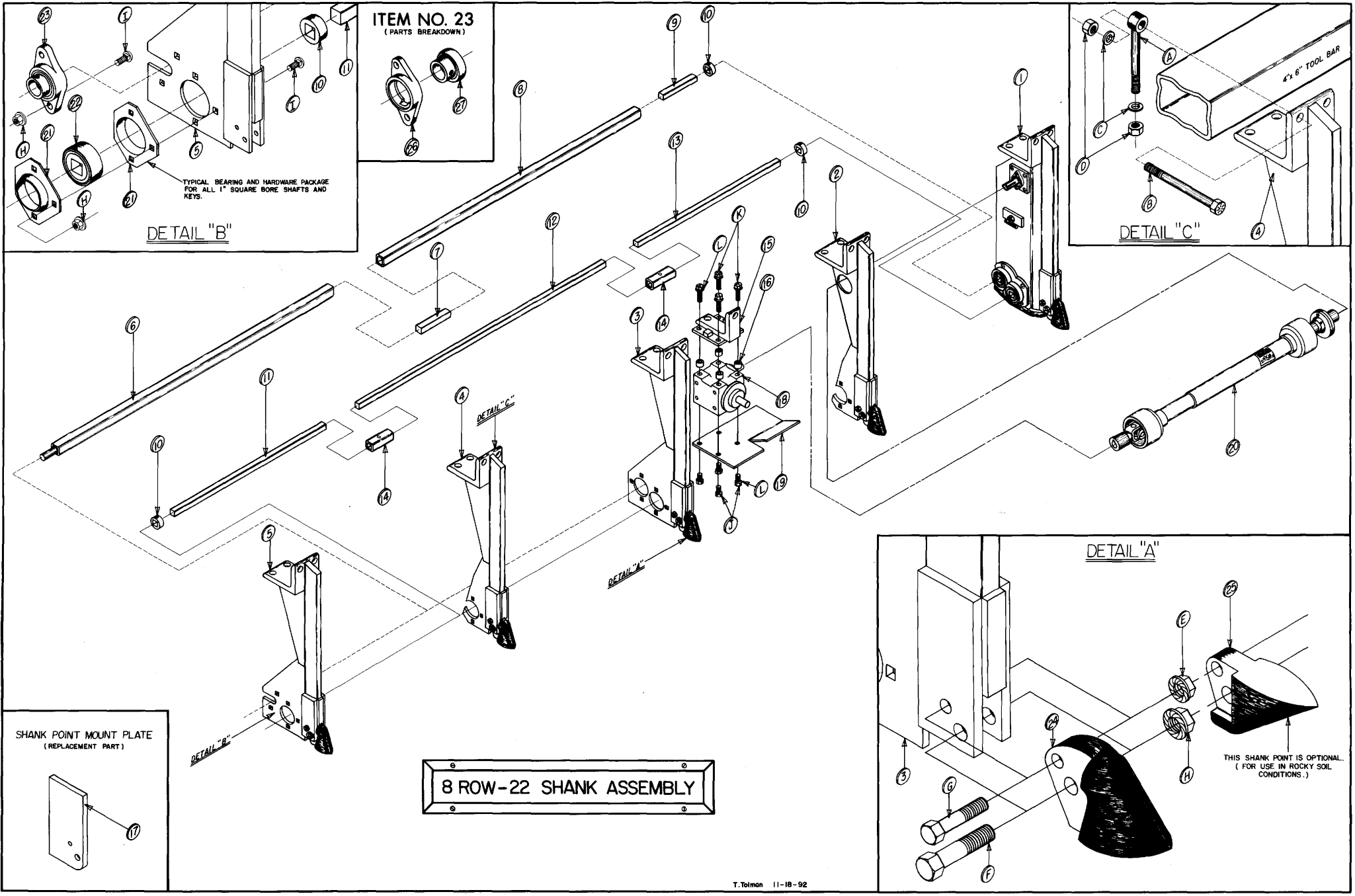

**8-ROW 22-SHANK ASSEMBLY (1992–1993)****Parts List**

<u>Item No.</u>	<u>Part No.</u>	<u>Description</u>
1.	900565	Universal Chain Case Shank—Complete
2.	900585★	One Hole Shank Assembly—with drive slot
3.	900405★	Two Hole Center Shank Assembly—without PTO
4.	900407★	One Hole Shank Assembly—without PTO
5.	900408★	End Shank Assembly
6.	900026	Kicker Rod
7.	900032	Kicker Rod Key
8.	900497	Kicker Rod—Universal Chain Case
9.	900562	Chain Case Kicker Rod Key
10.	103038	Collar, Lock 1" Square
11.	900461-43	1" Cutter Rod
12.	900461-87.625	1" Cutter Rod
13.	900461-49.875	1" Cutter Rod
14.	900373	Cutter Rod Coupler
15.	900180	PTO Gear Box Mount
16.	900181	PTO Mount Spacer
17.	900308	Shank Point Mount Plate
18.	107001	Gear Box, 1991 L.H. (brand may vary)
19.	900254★	PTO Gear Box Shield (can be updated)
20.	104006	Drive Line, Gear Box to Chain Case (brand may vary)
21.	106007	Flangett, 3-Hole Square
22.	102000	Bearing, 1" Square
23.	102016	Bearing, 1" 2-Hole Flange Triple Seal
24.	116006	Point, Shear
25.	116023	Point, Rock Point 45, Bolt-on (replaces 116007)
26.	106023	2-Hole Flange Bearing Housing
27.	102013	Bearing, 1" Triple Seal (Insert)

**Hardware List**

<u>Item No.</u>	<u>Part No.</u>	<u>Description</u>
A.	118000	$\frac{3}{4}$ " $\times$ 6" NC Eye Bolt Grade 8
B.	106009	$\frac{3}{4}$ " $\times$ 9" NC Hex Bolt Grade 8
C.		$\frac{3}{4}$ " Lock Washer
D.		$\frac{3}{4}$ " NC Hex Nut
E.		$\frac{3}{8}$ " NC Whiz Nut
F.		$\frac{1}{2}$ " $\times$ 2" Roll Pin
G.		$\frac{3}{8}$ " $\times$ 2 $\frac{1}{4}$ " NC Hex Bolt Grade 2
H.		$\frac{1}{2}$ " NC Whiz Nut
I.		$\frac{1}{2}$ " $\times$ 1" NC Carriage Bolt
J.		$\frac{1}{2}$ " $\times$ $\frac{3}{4}$ " NC Hex Bolt
K.		$\frac{1}{2}$ " $\times$ 2" NC Hex Bolt
L.		$\frac{1}{2}$ " Lock Washer

★ This part is manufactured on a built-to-order basis only. Call Pickett Equipment for availability and lead-time.

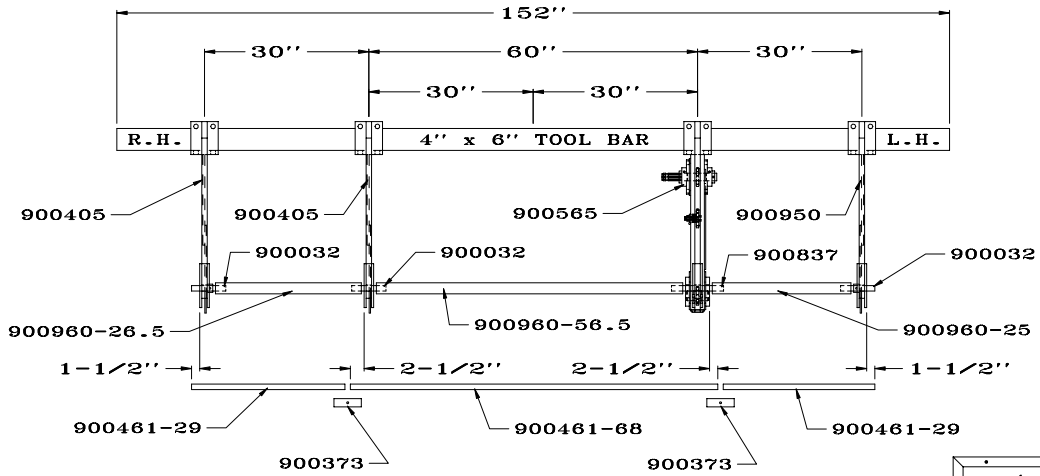

4 ROW-30  
SHANK LAYOUT

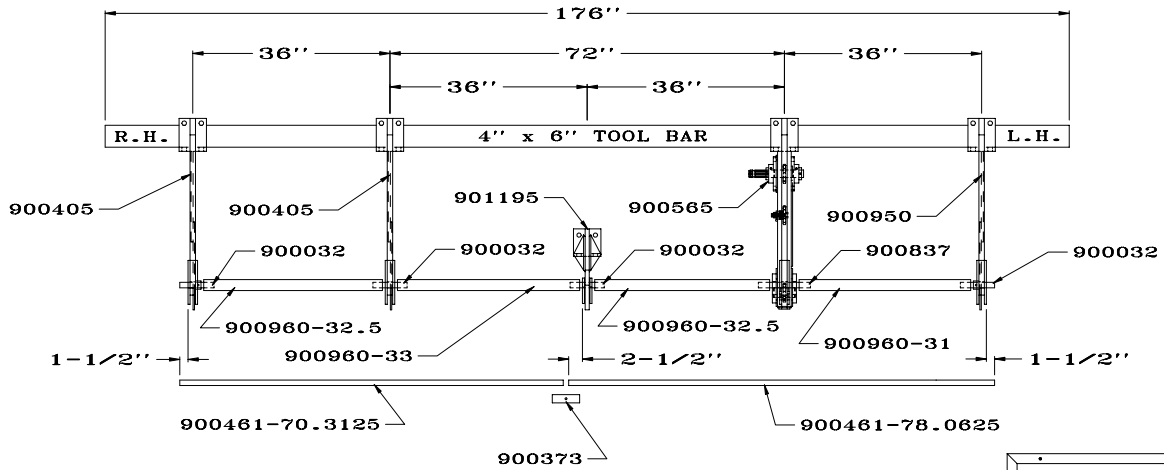

4 ROW-36  
SHANK LAYOUT

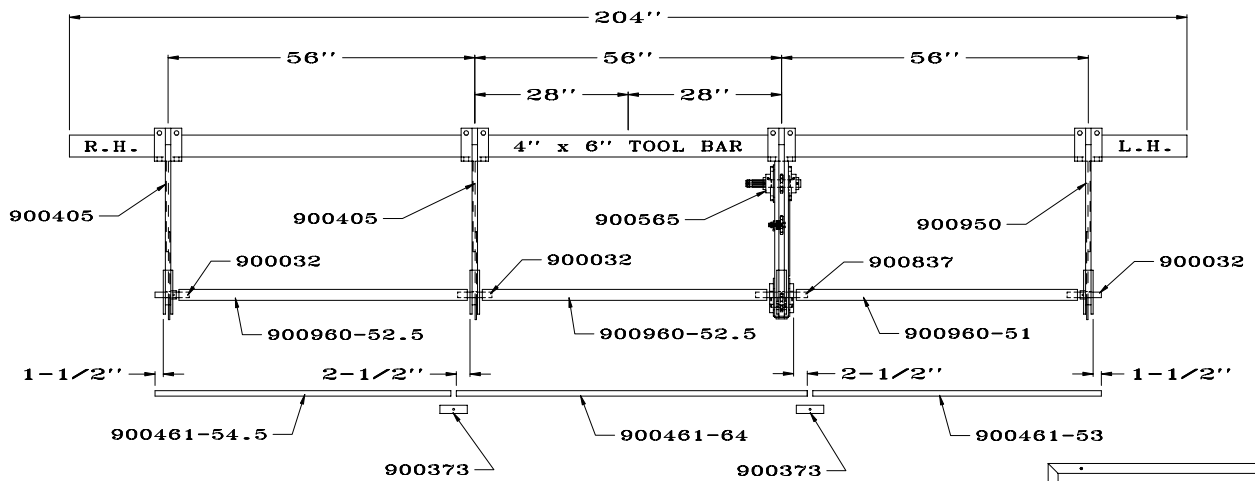

6 ROW-28  
SHANK LAYOUT

1994-1995

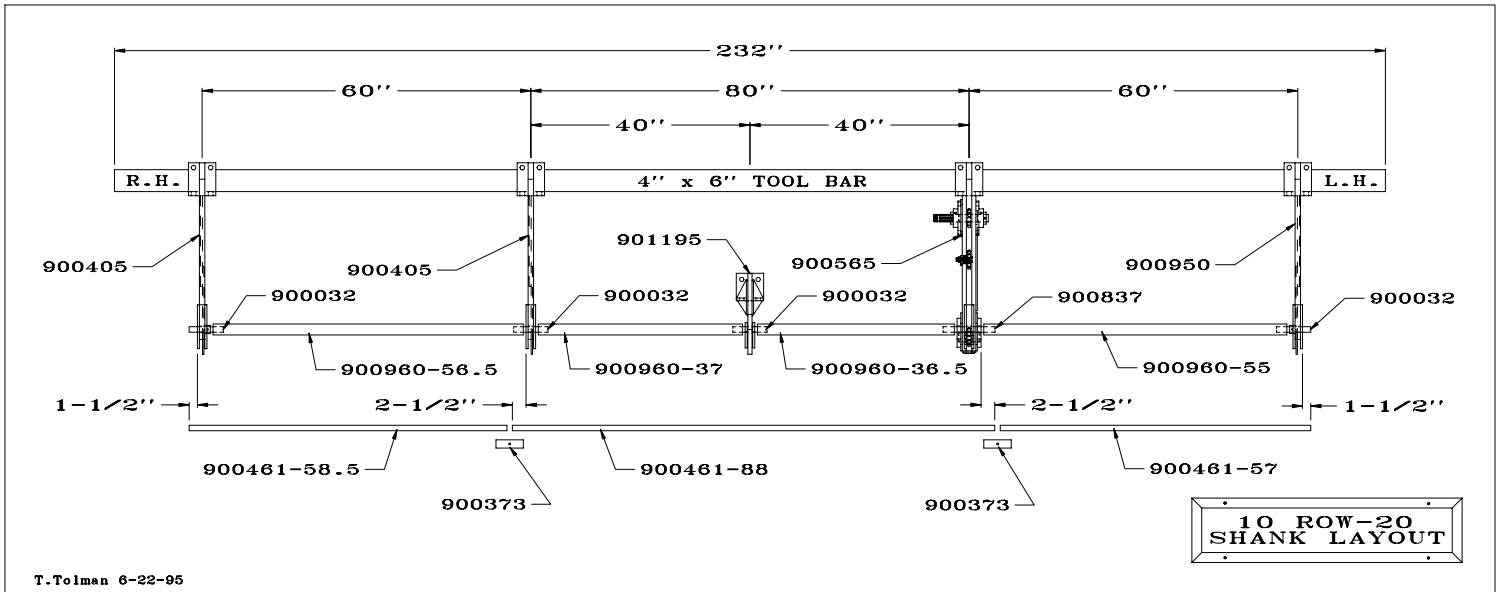
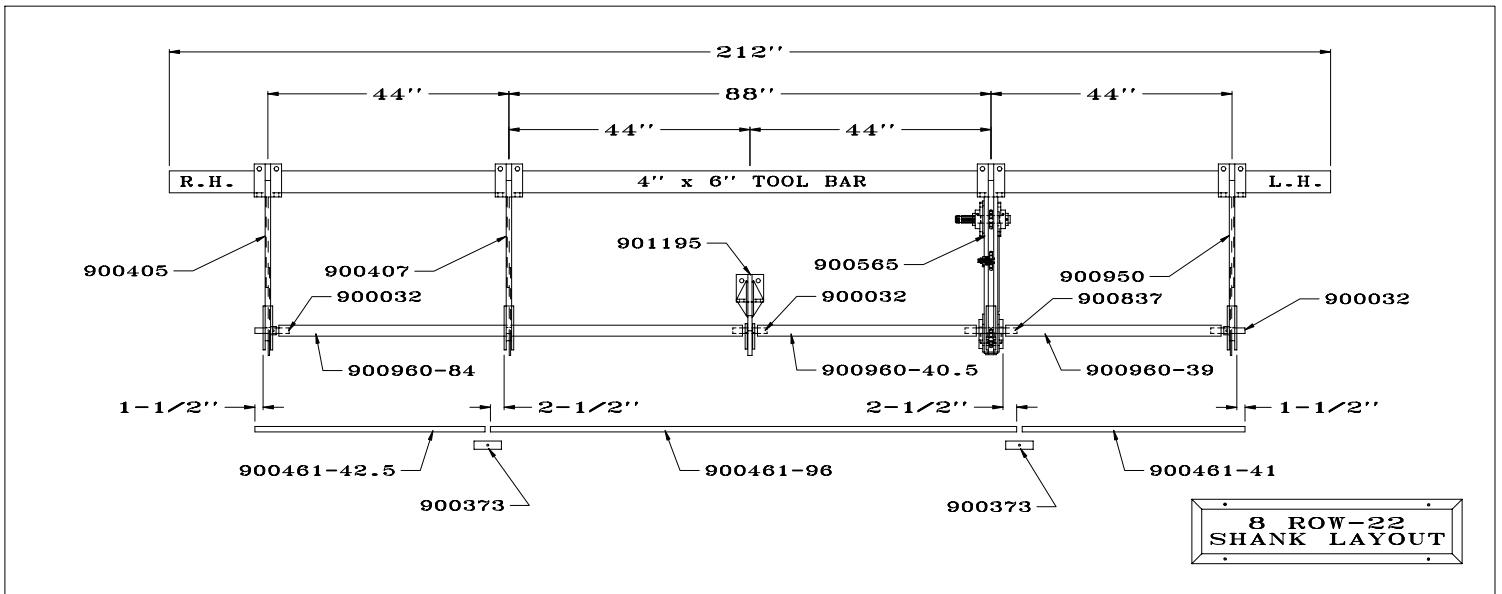
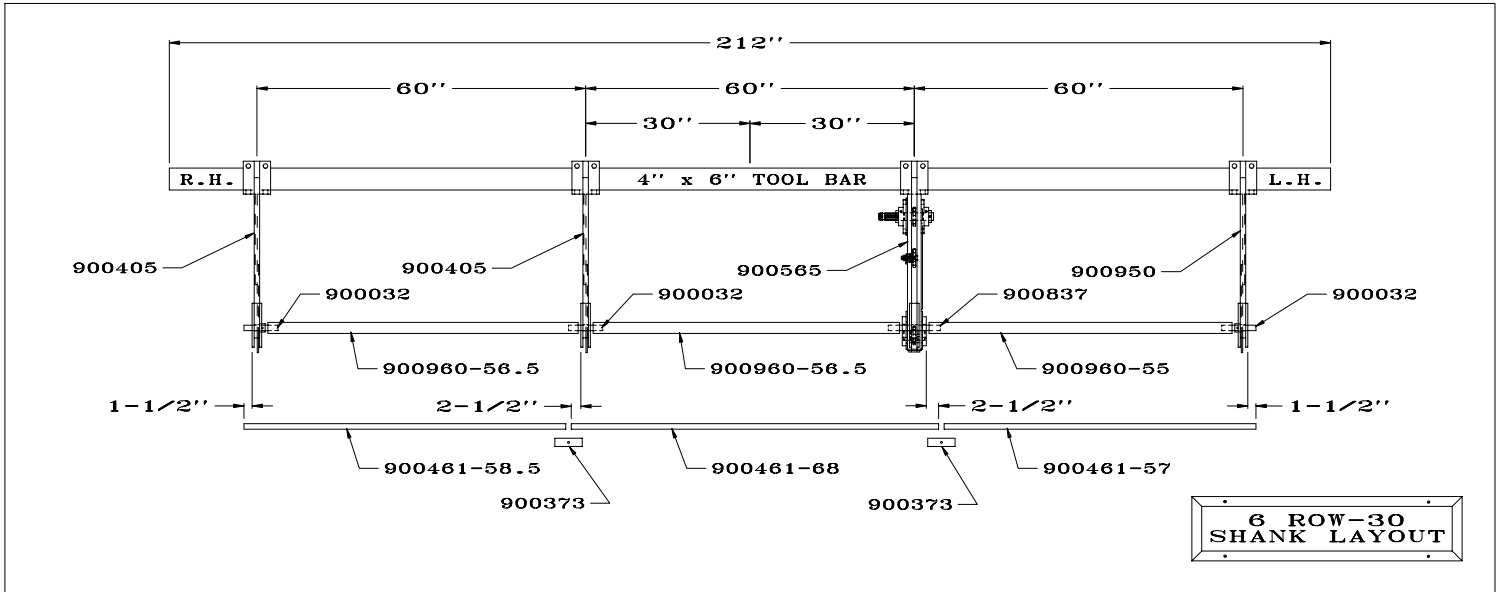

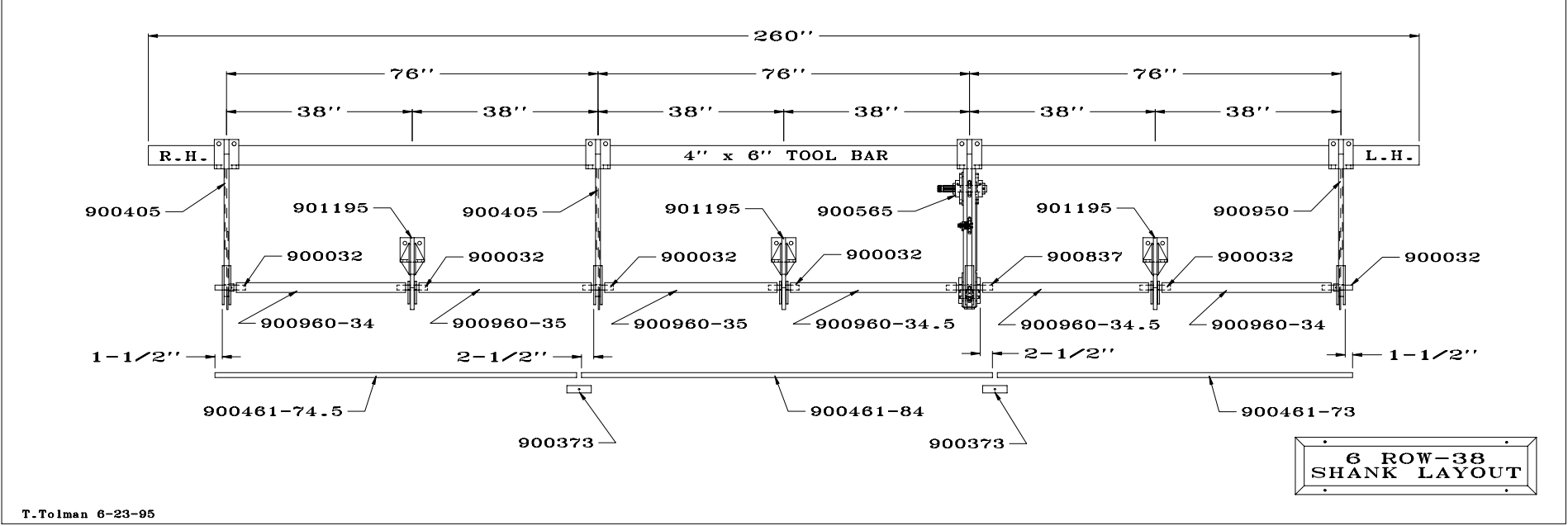
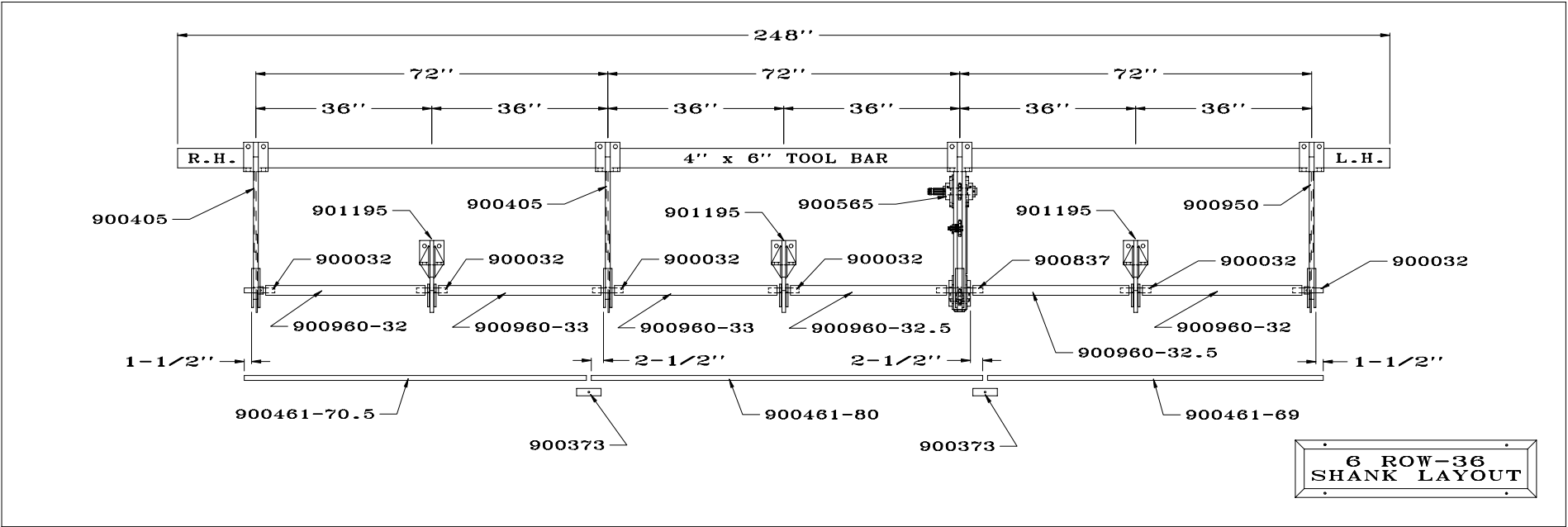

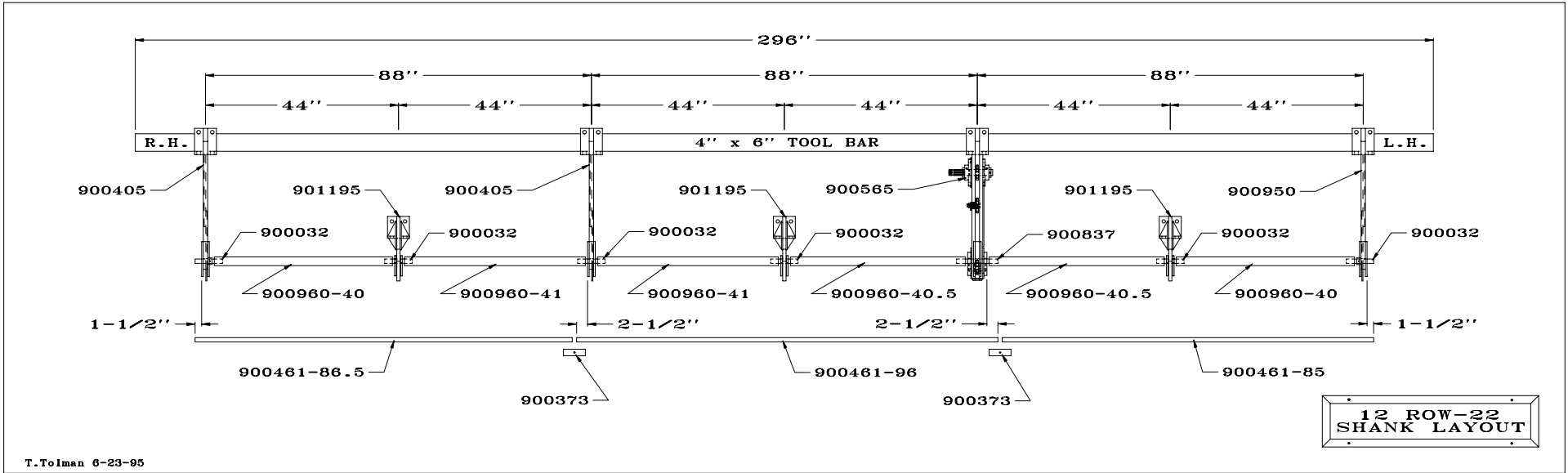
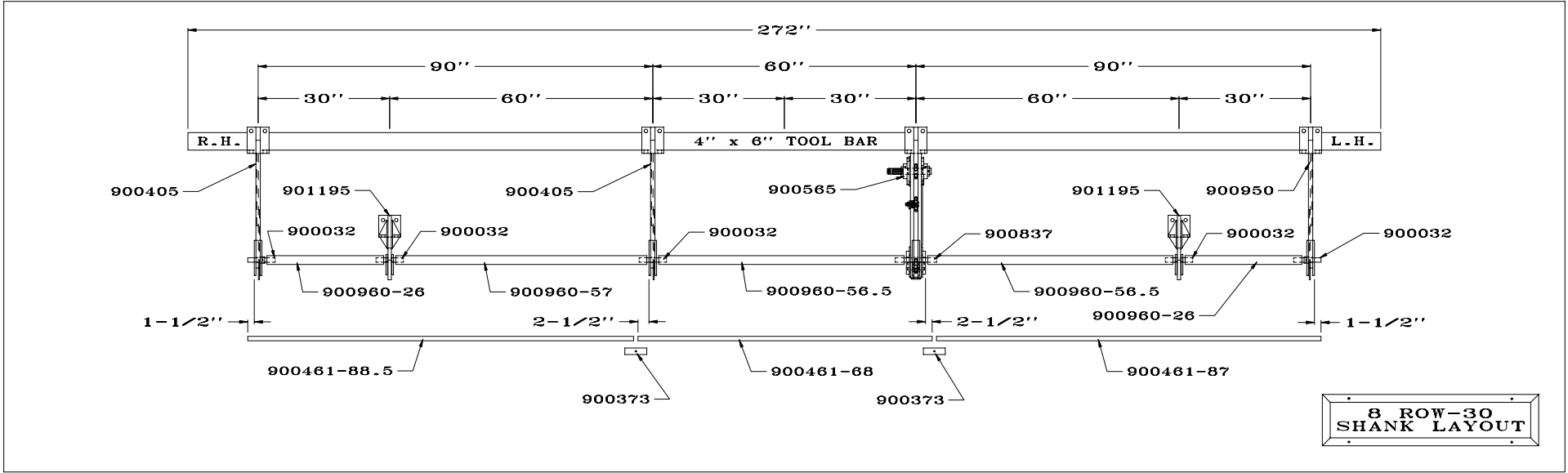

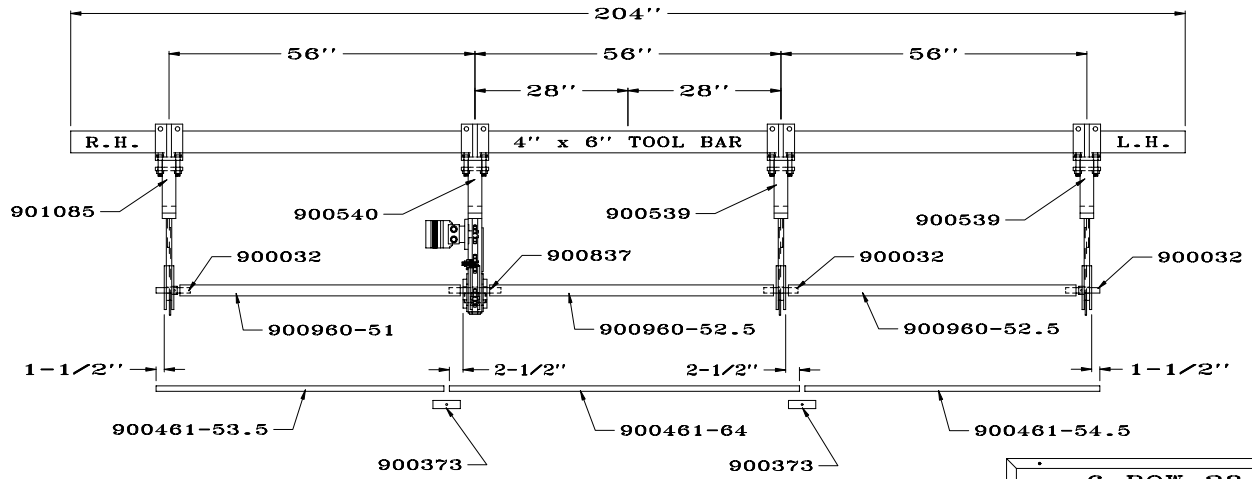

6 ROW-28  
C-SHANK LAYOUT

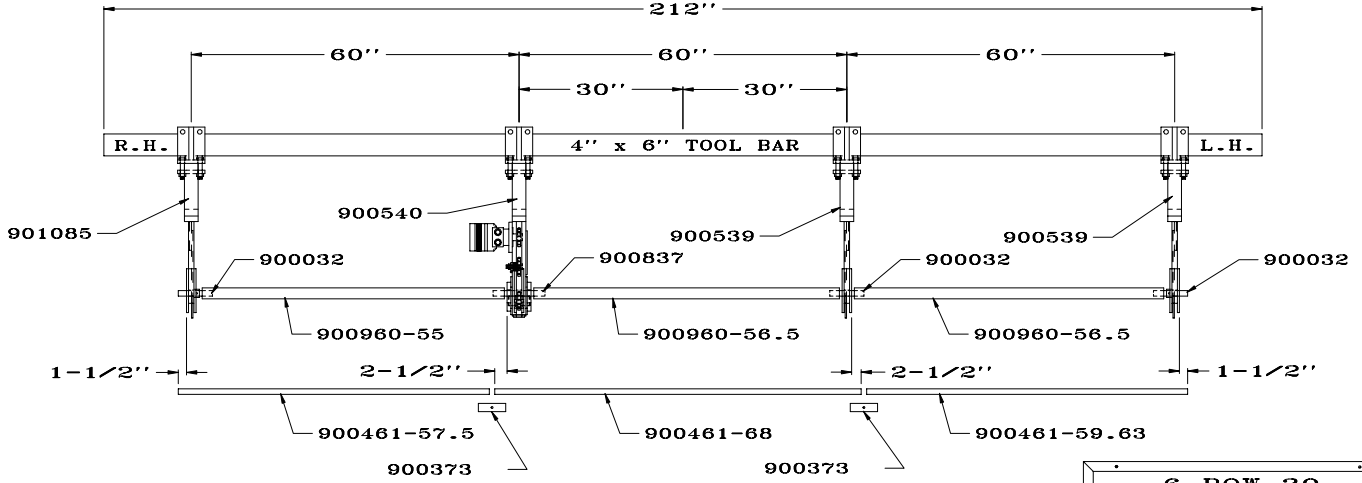

6 ROW-30  
C-SHANK LAYOUT

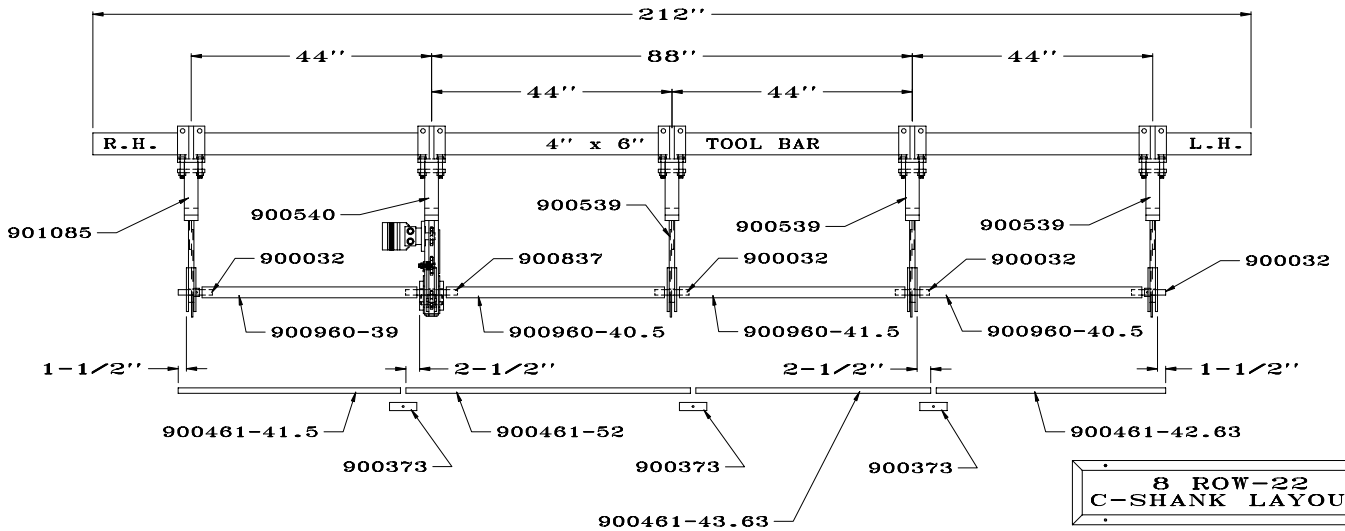

8 ROW-22  
C-SHANK LAYOUT



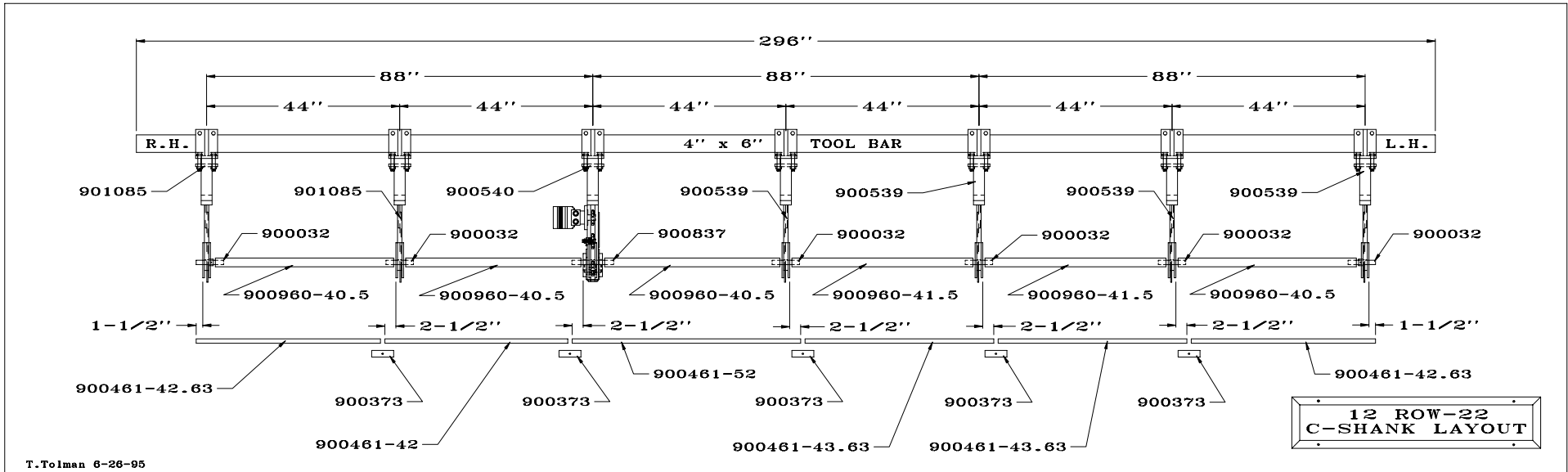
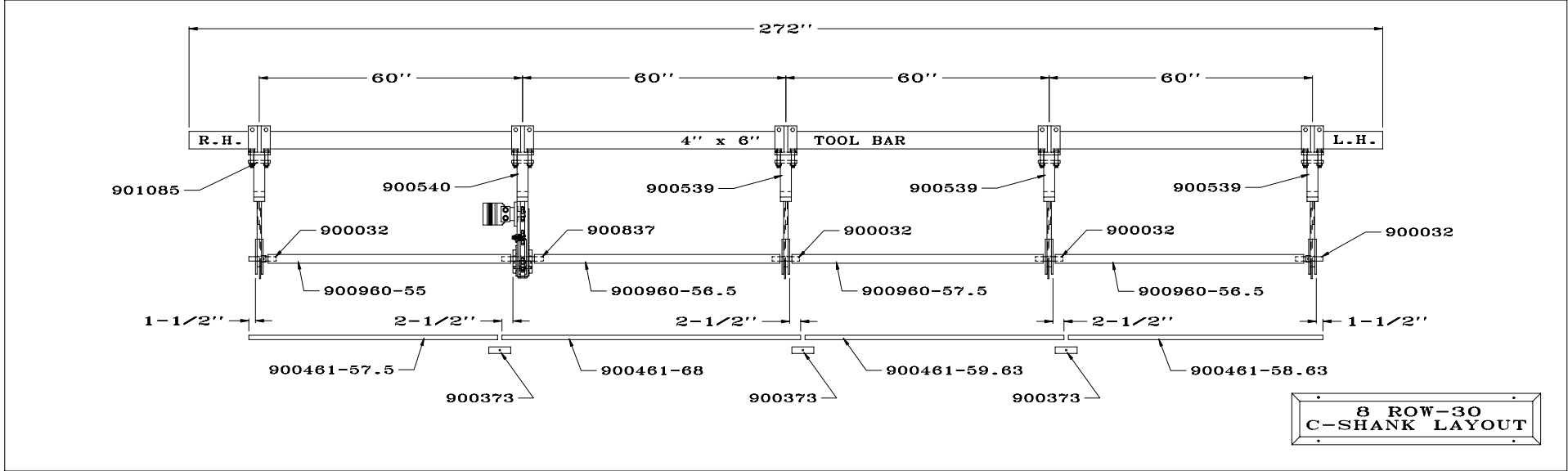

T.Tolman 6-26-95

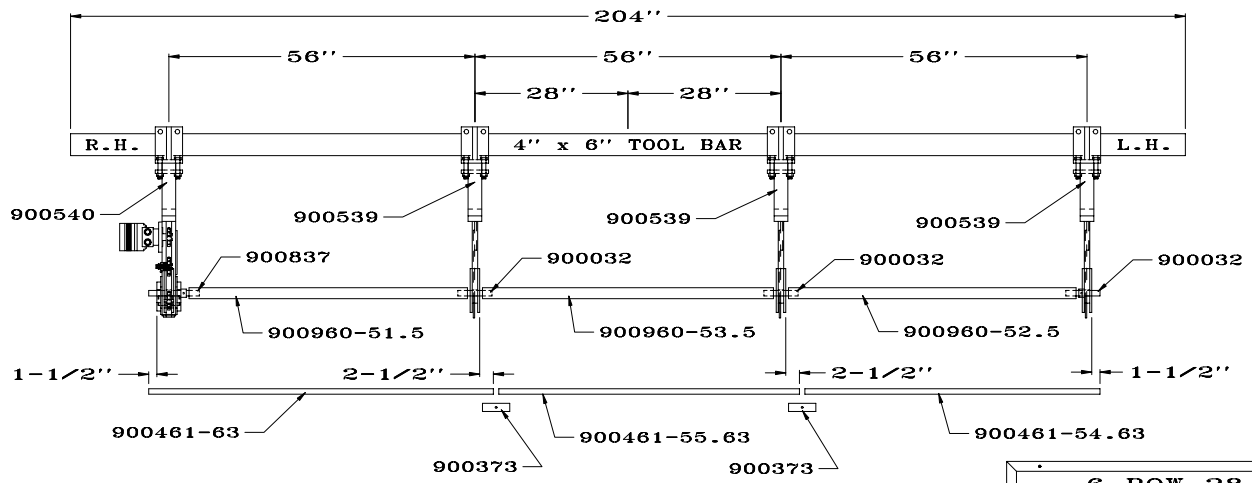

6 ROW-28  
C-SHANK LAYOUT

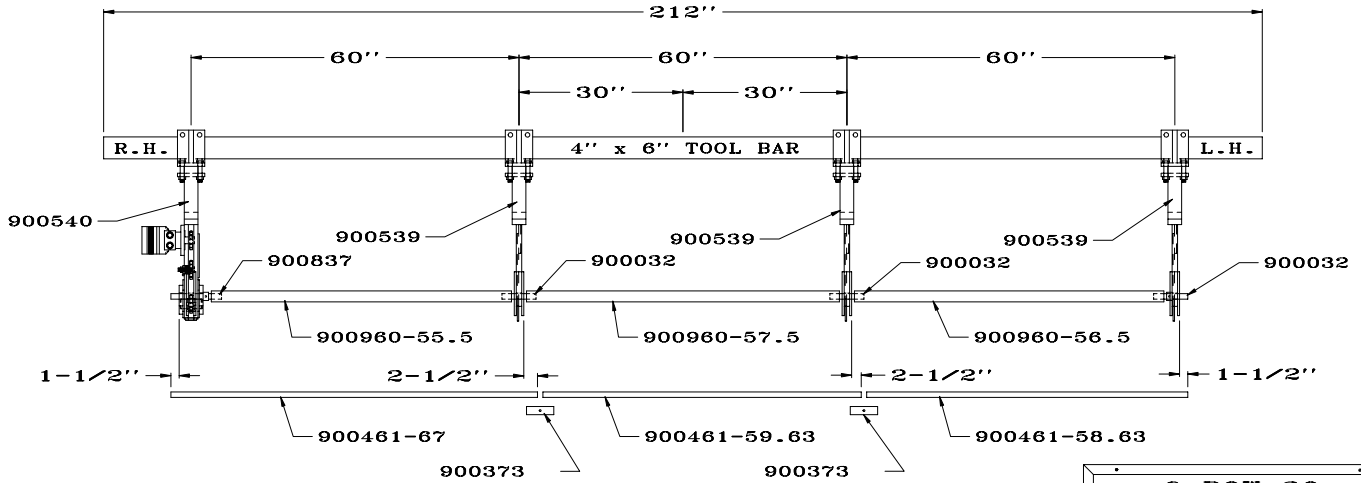

6 ROW-30  
C-SHANK LAYOUT

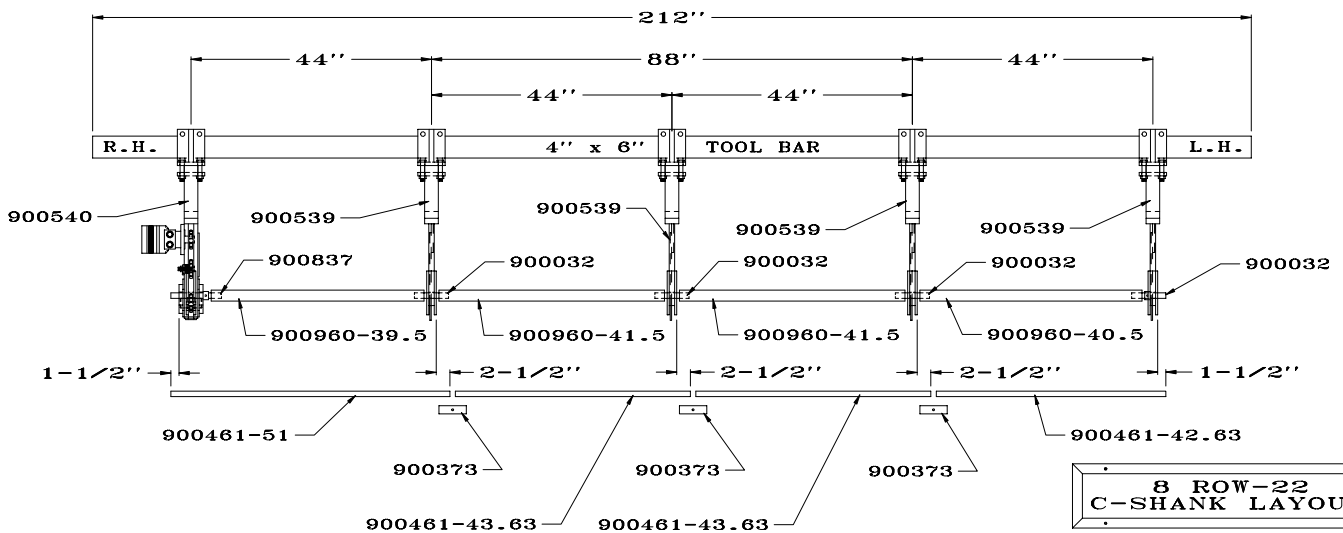

8 ROW-22  
C-SHANK LAYOUT

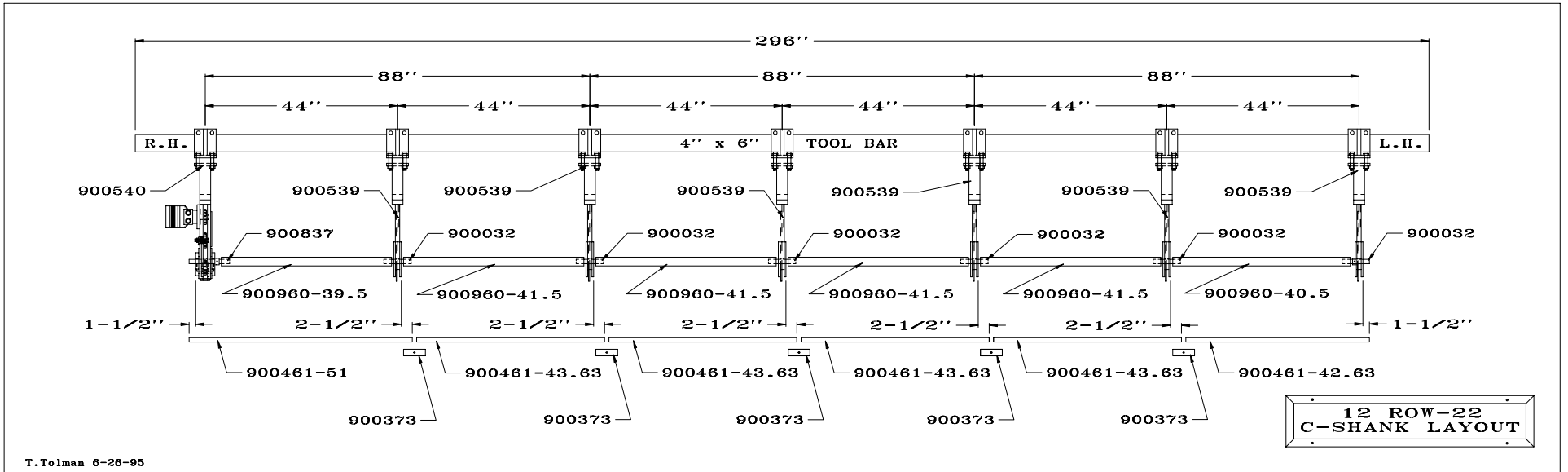
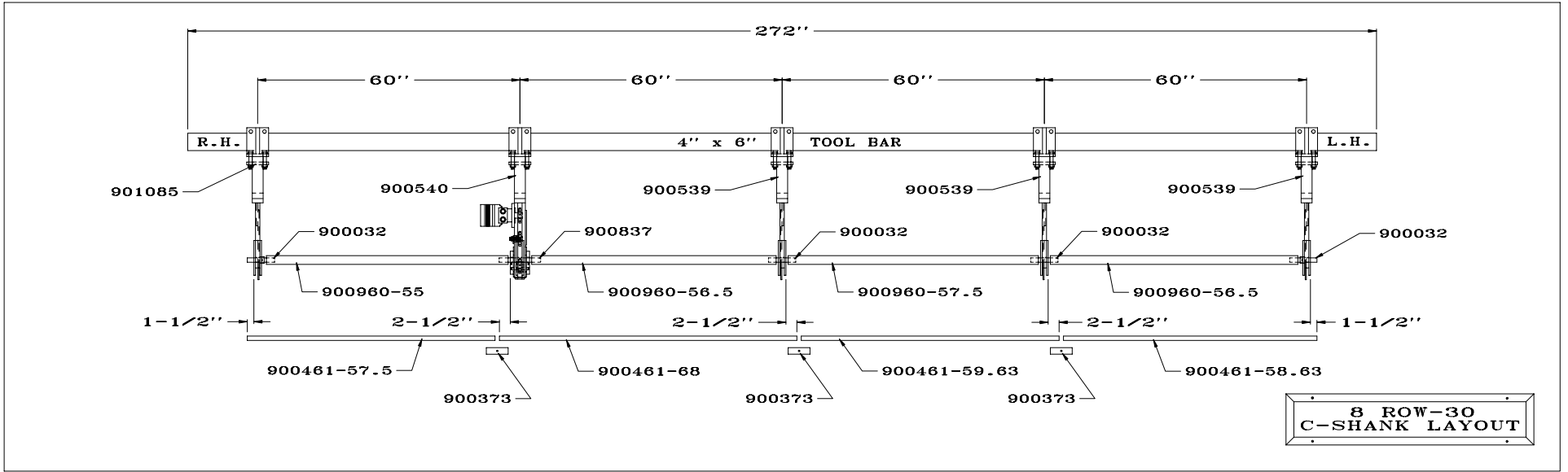

1996-Present

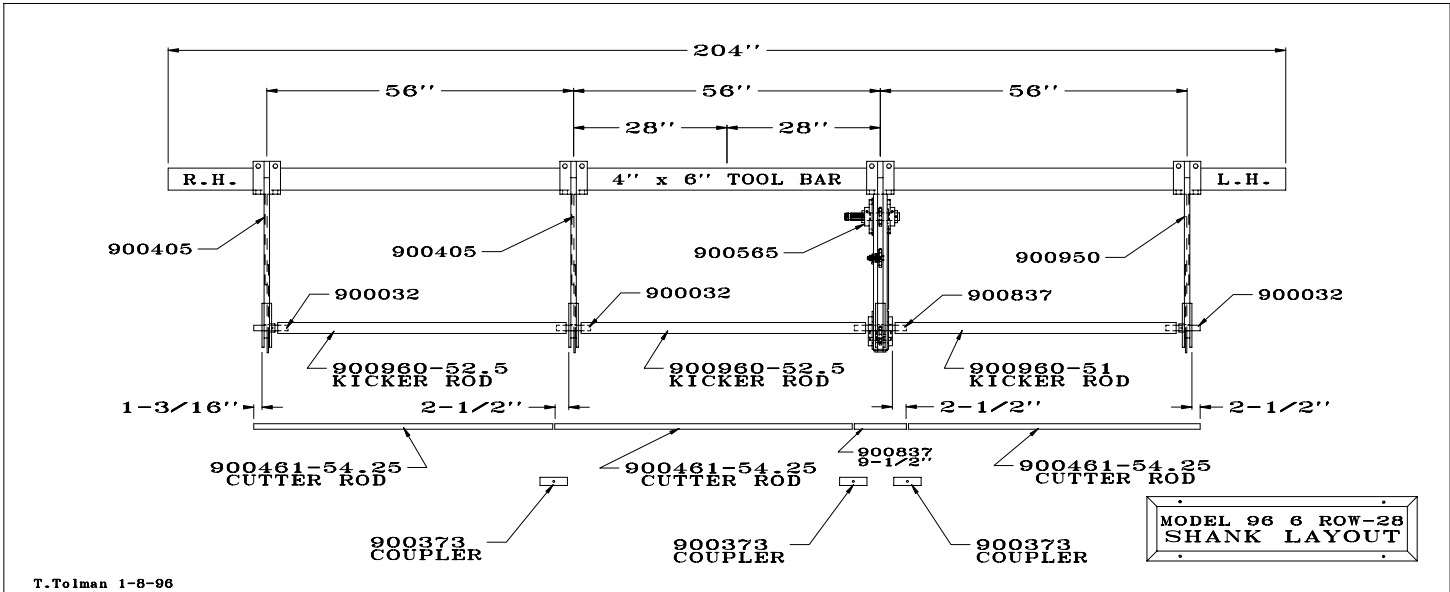
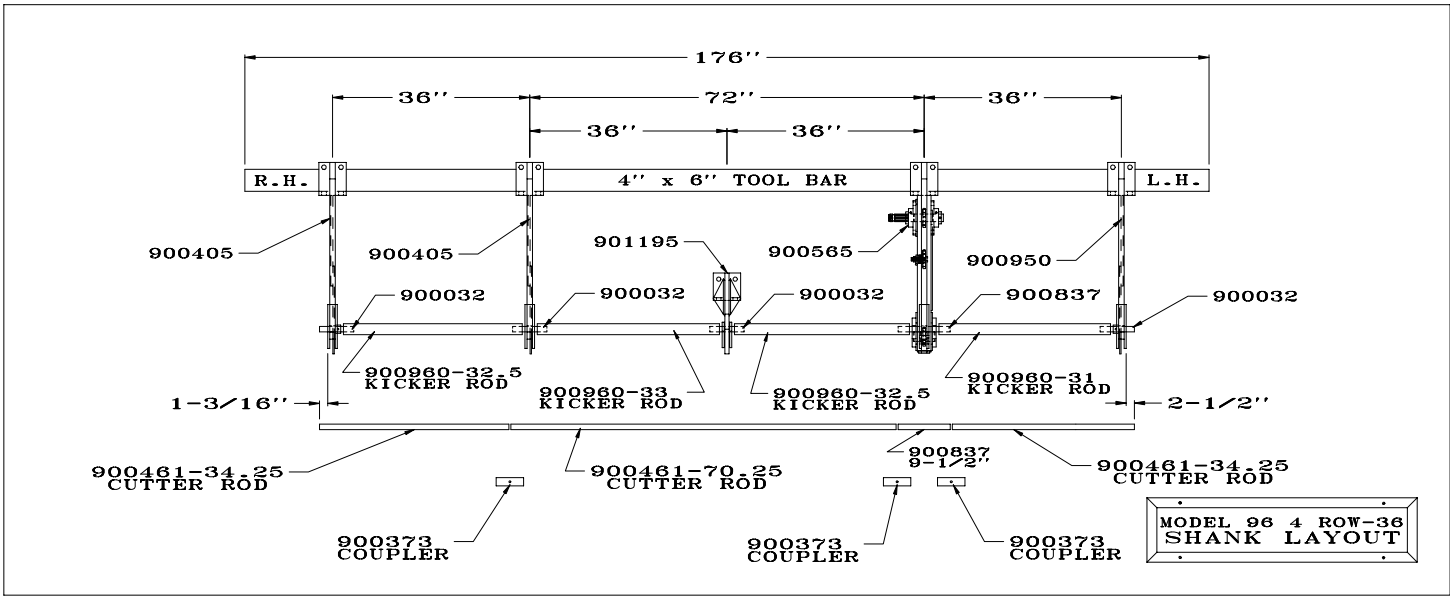
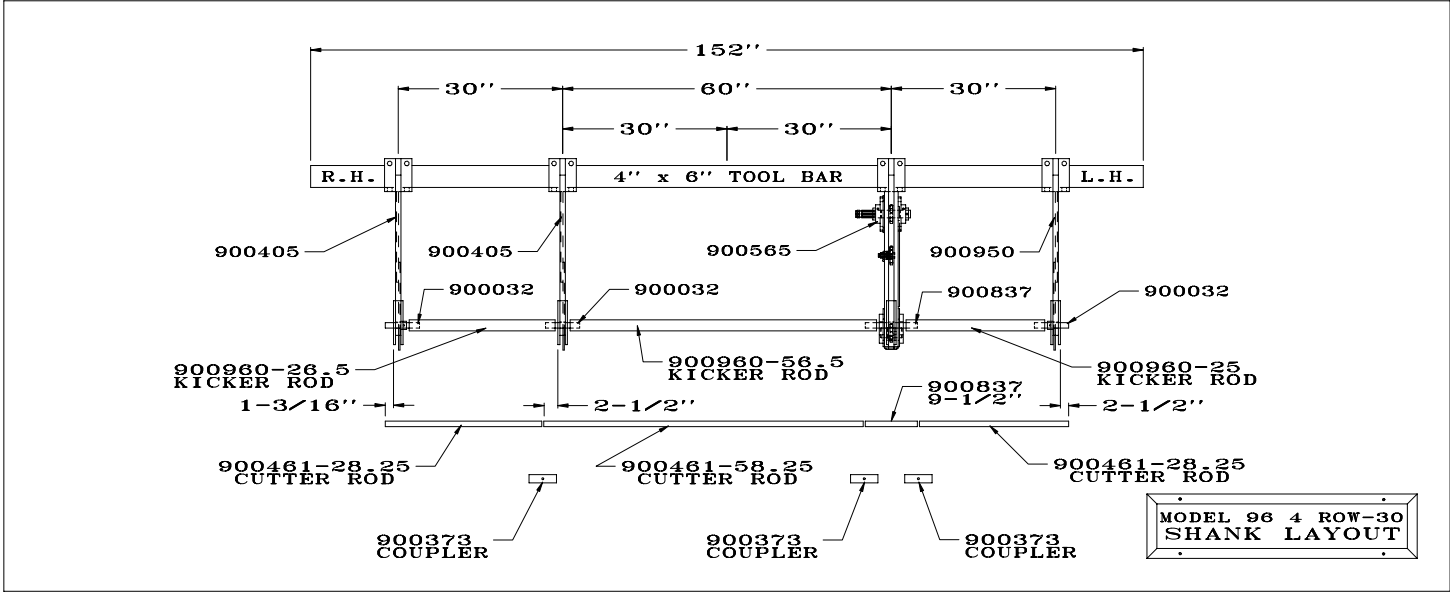

1996-Present

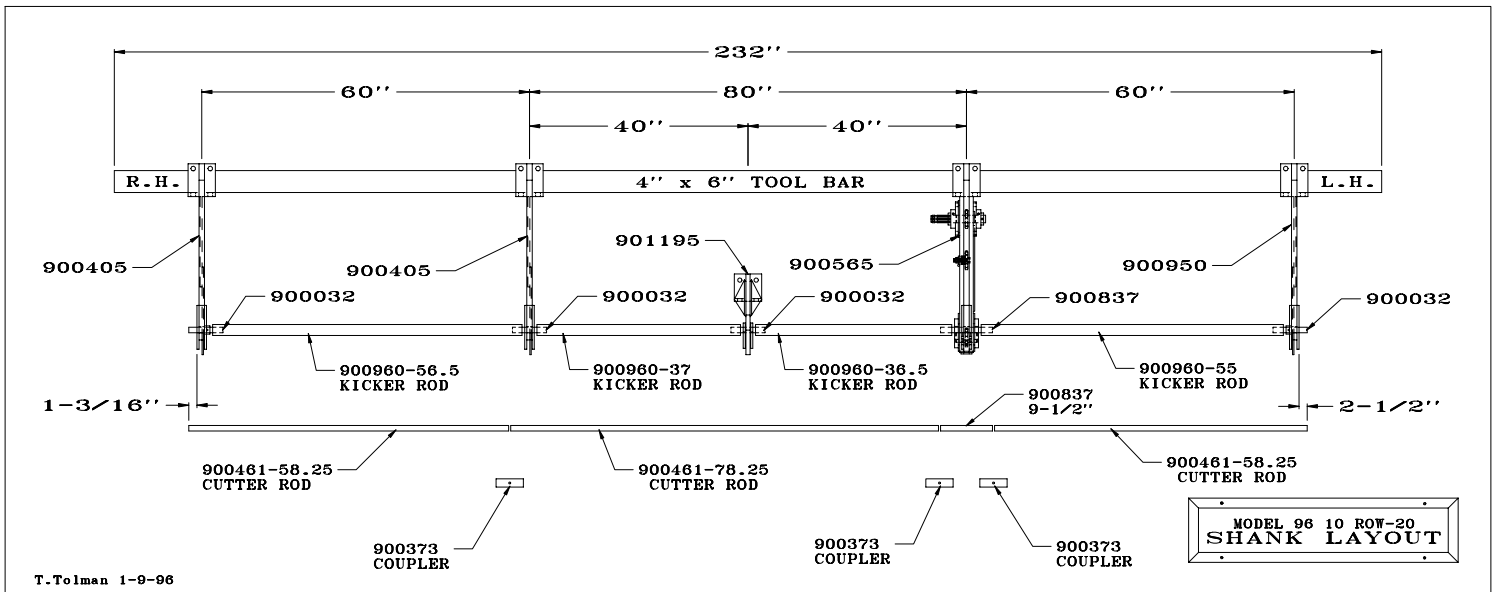
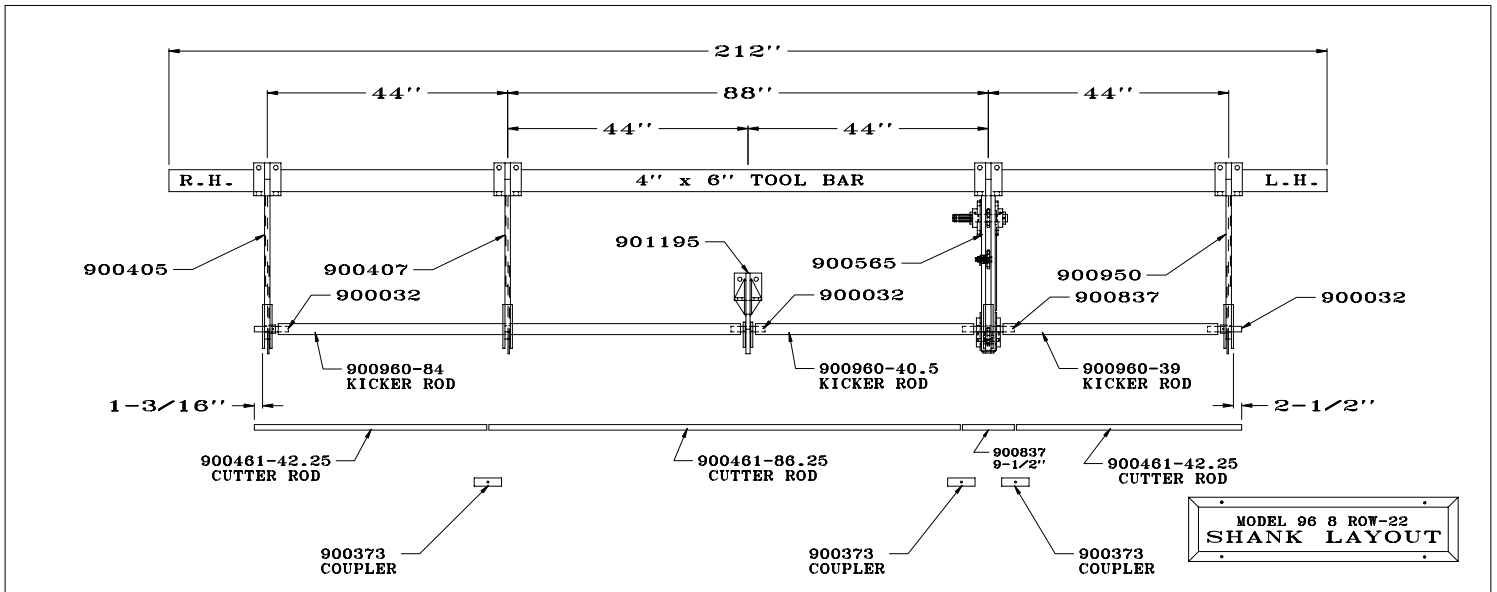
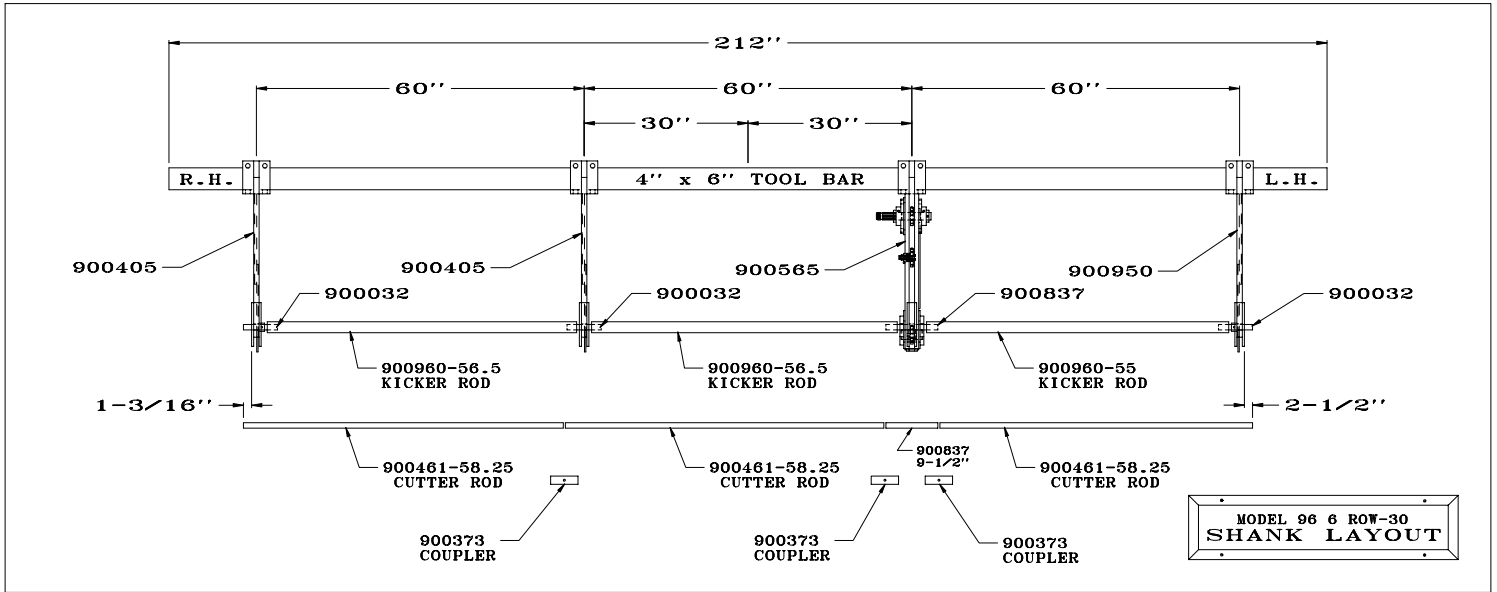

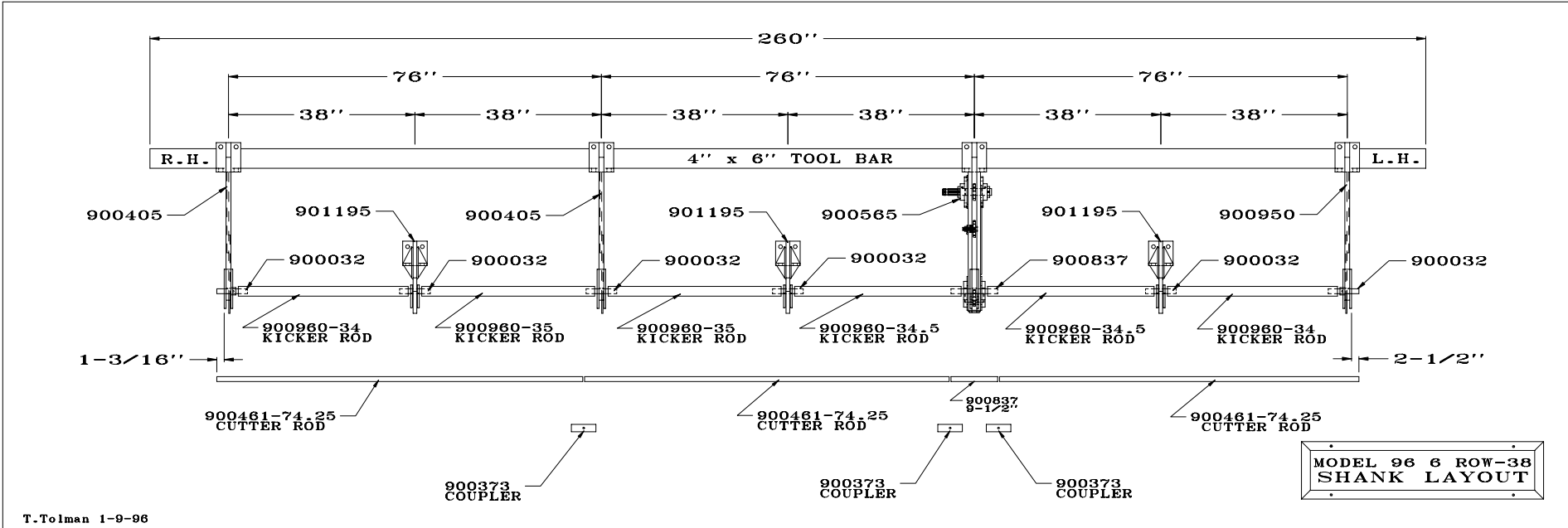
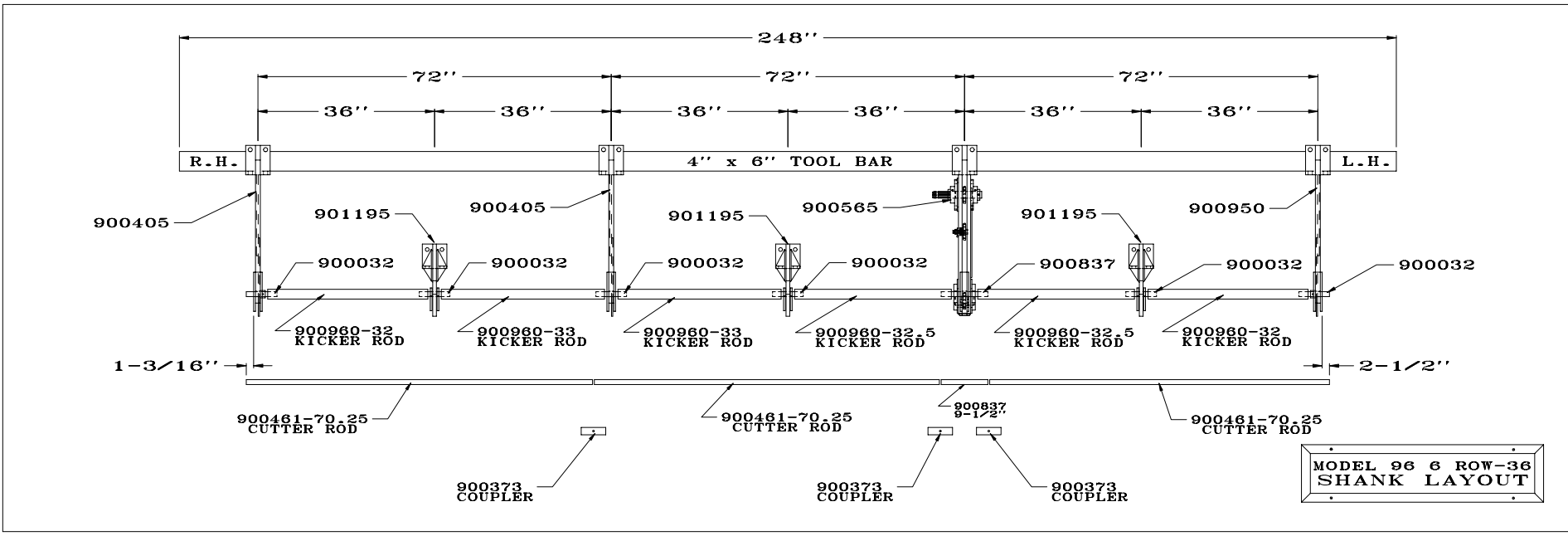

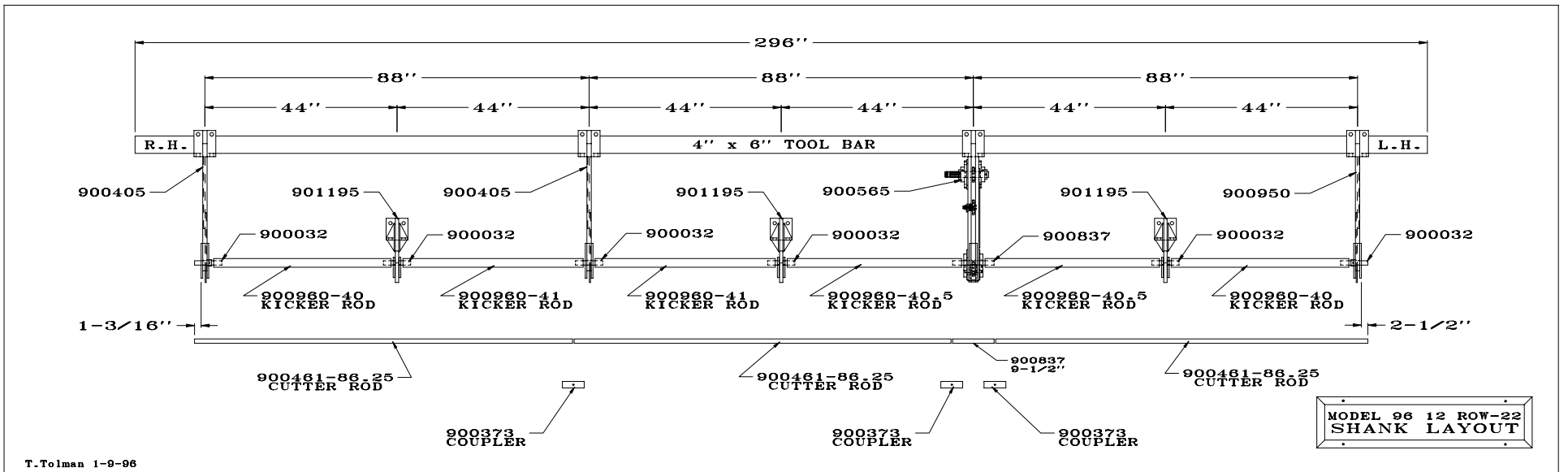
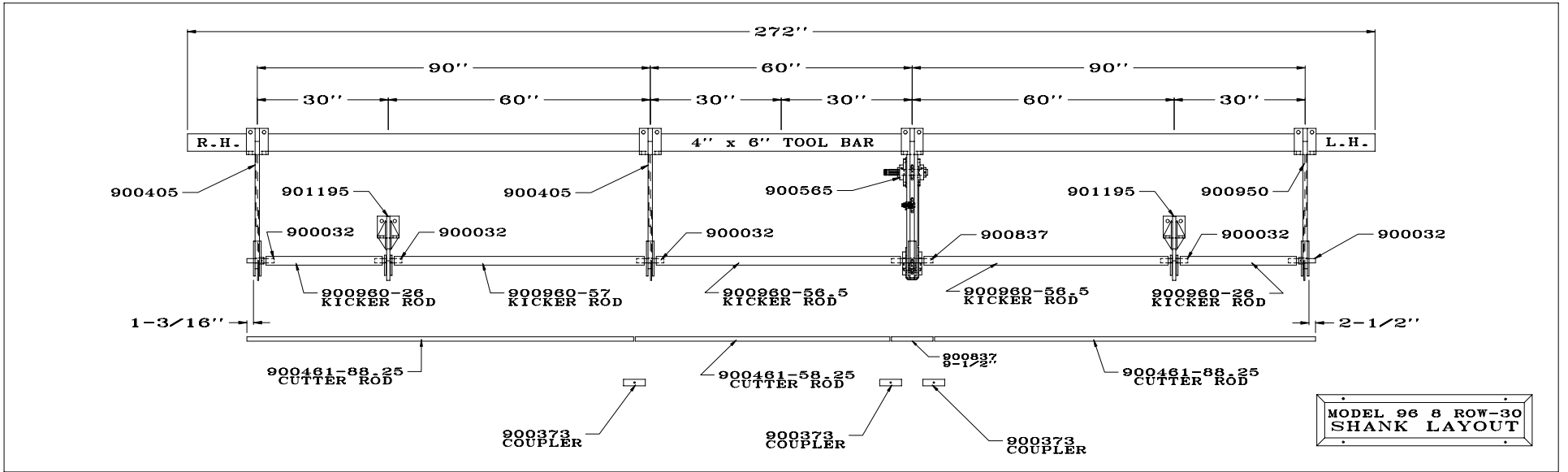

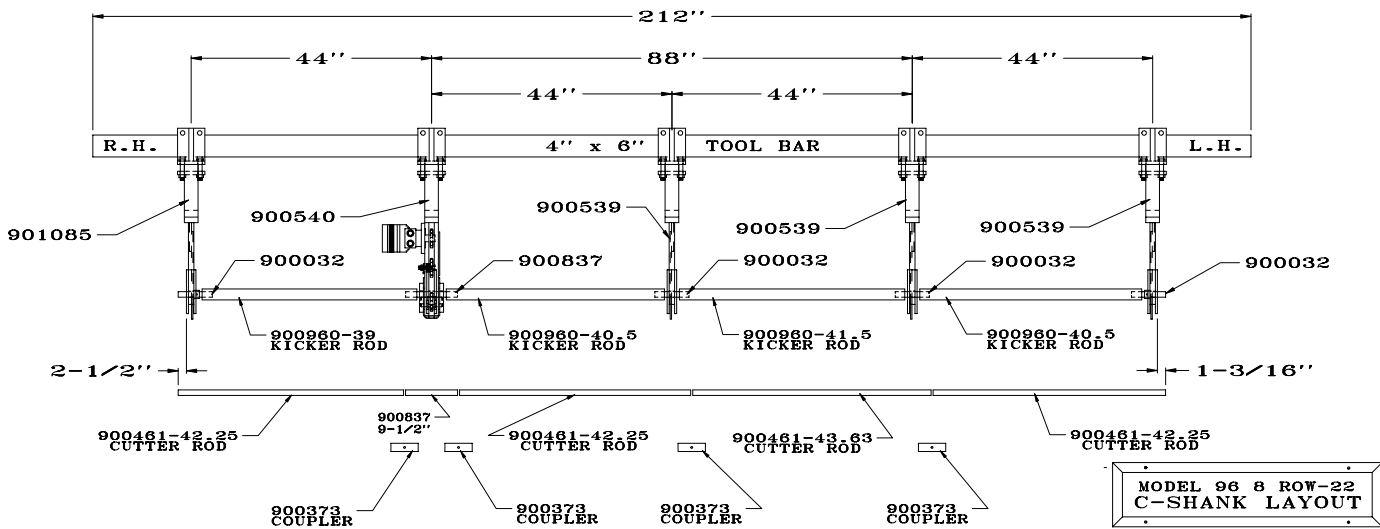
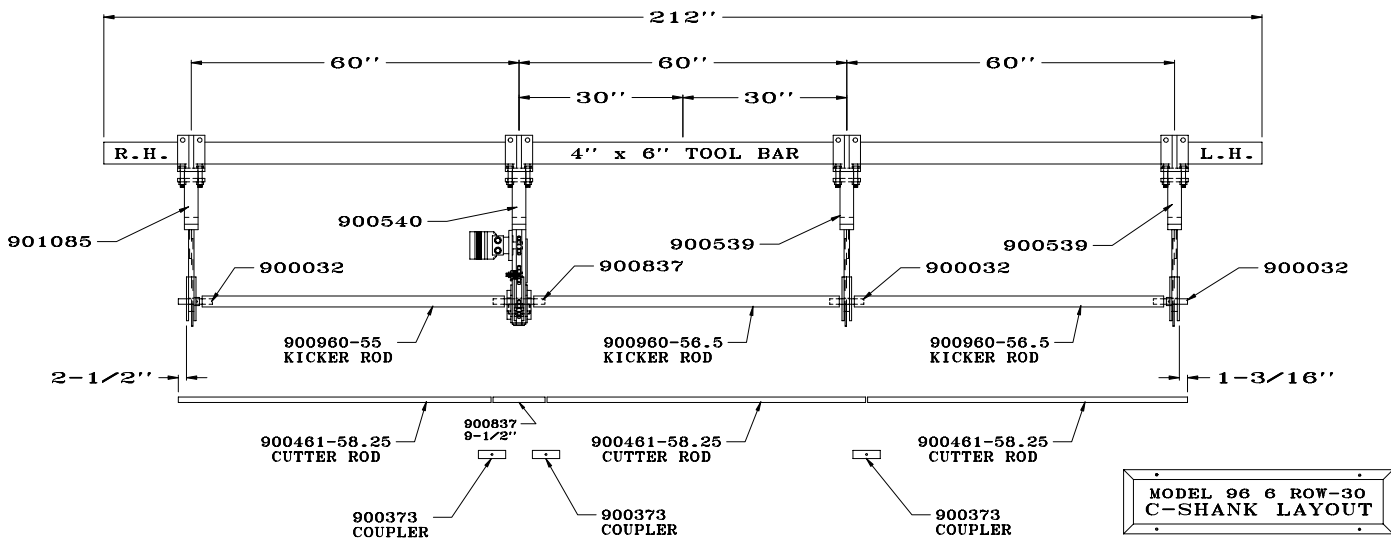
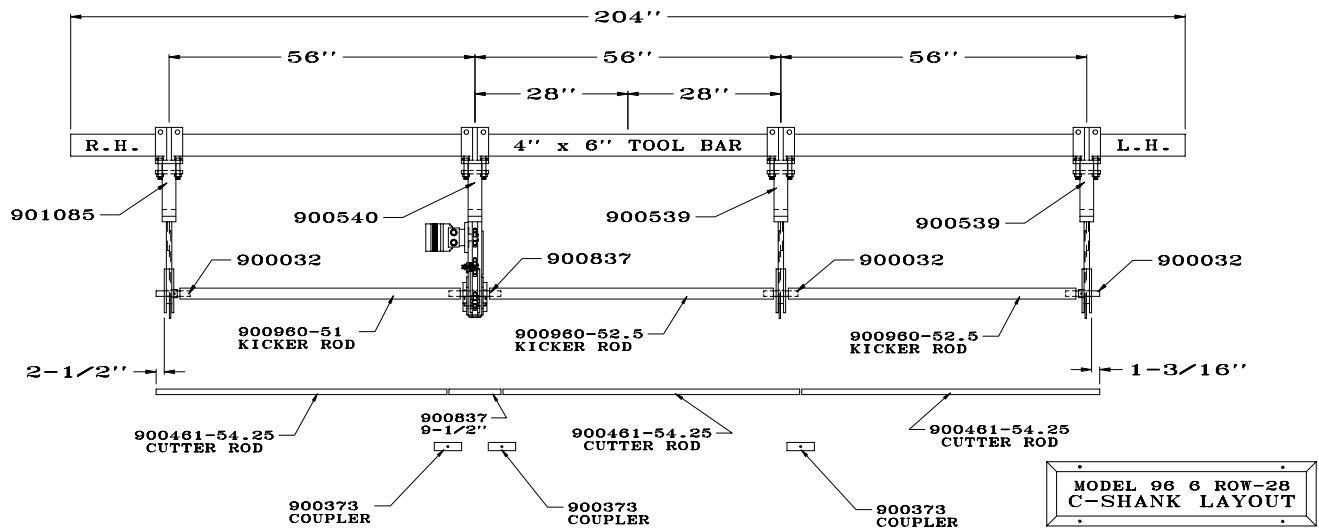



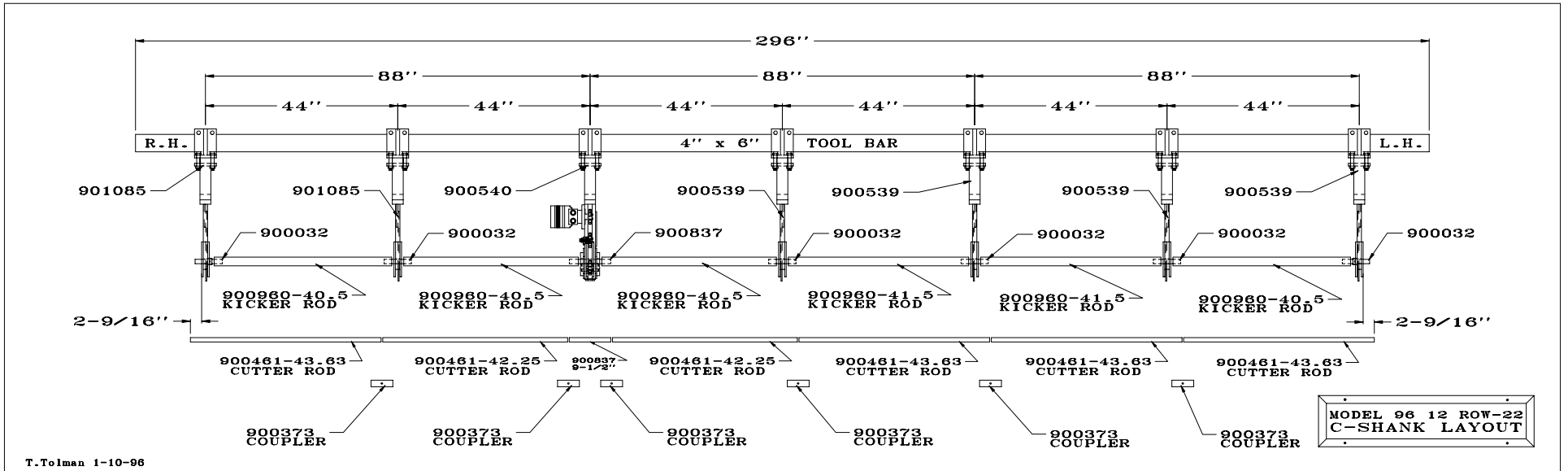
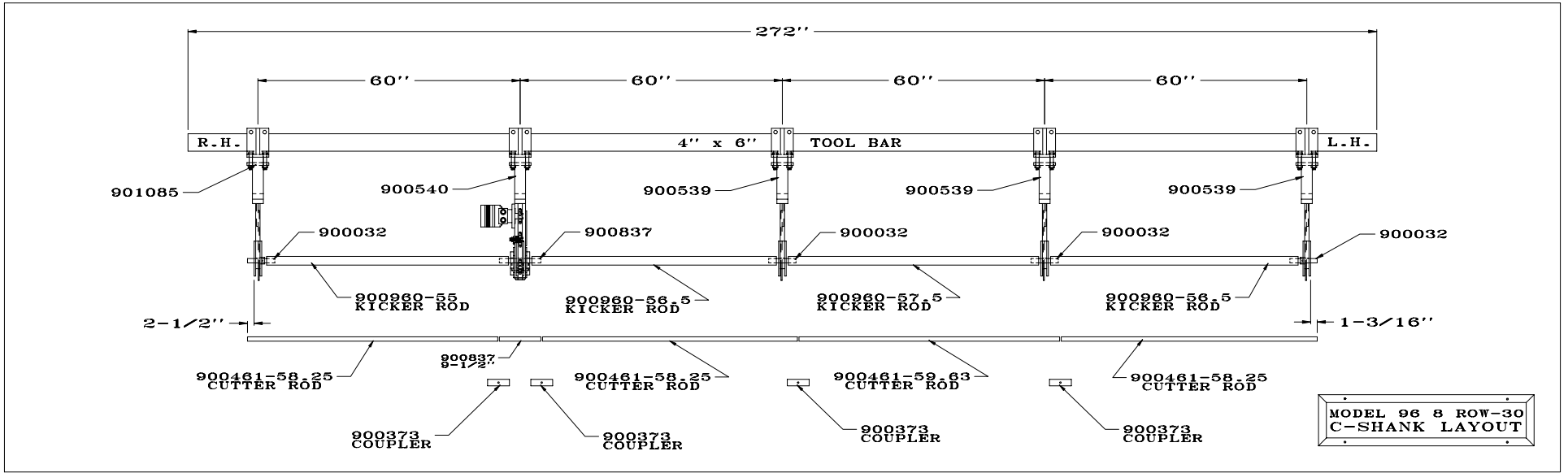

1996-Present

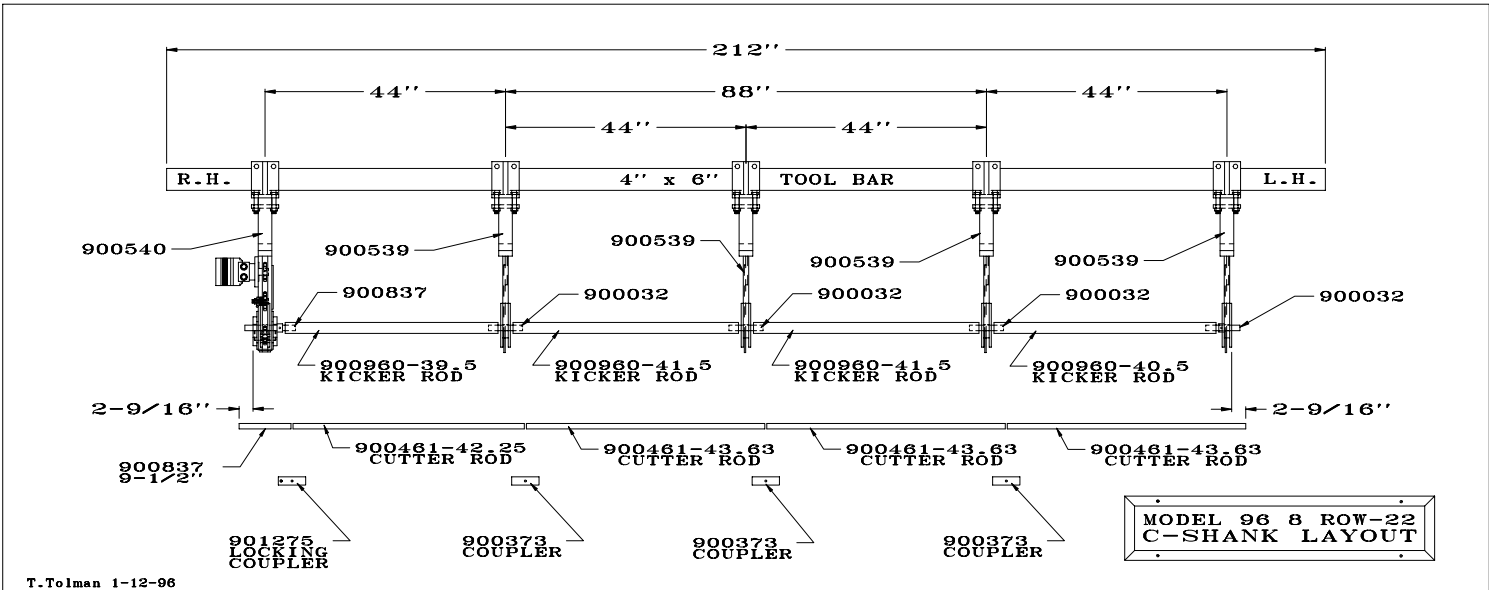
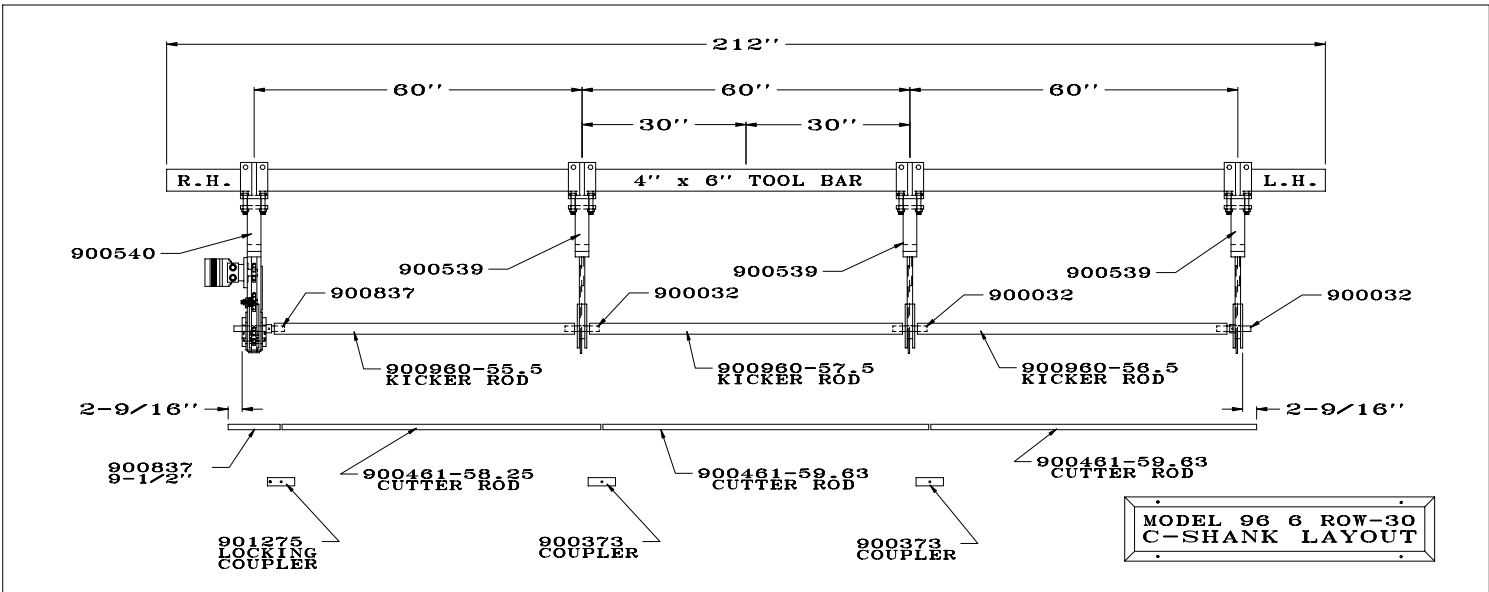
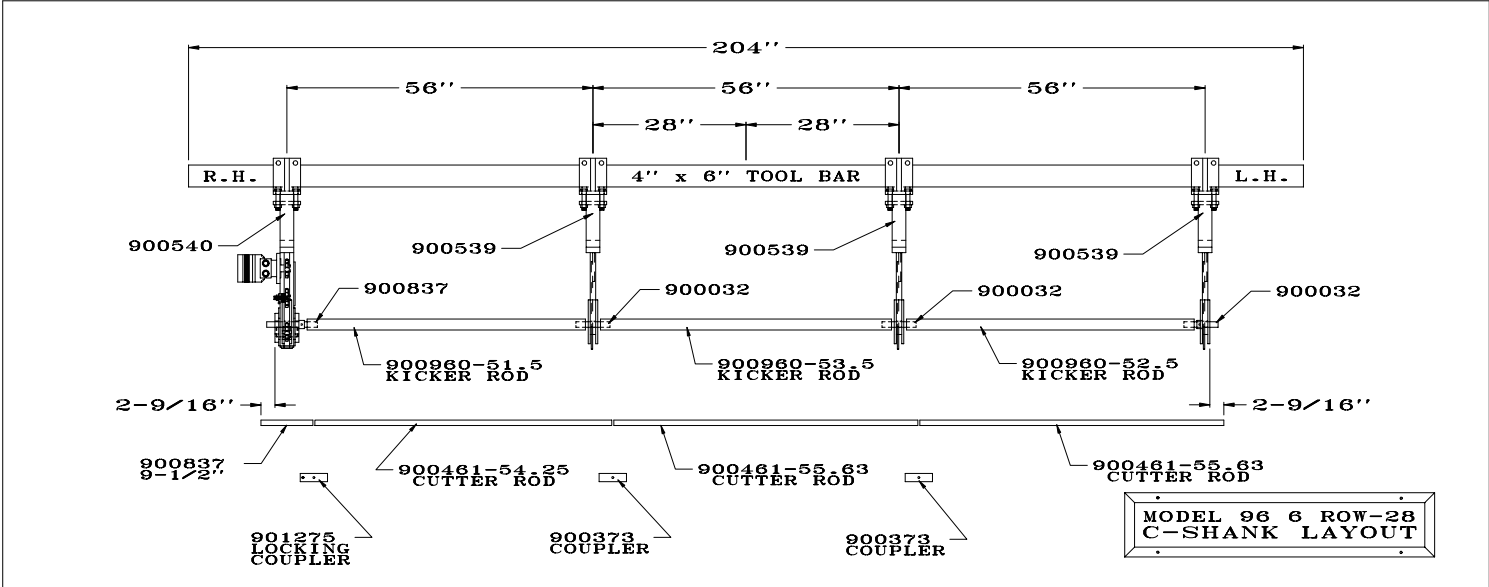

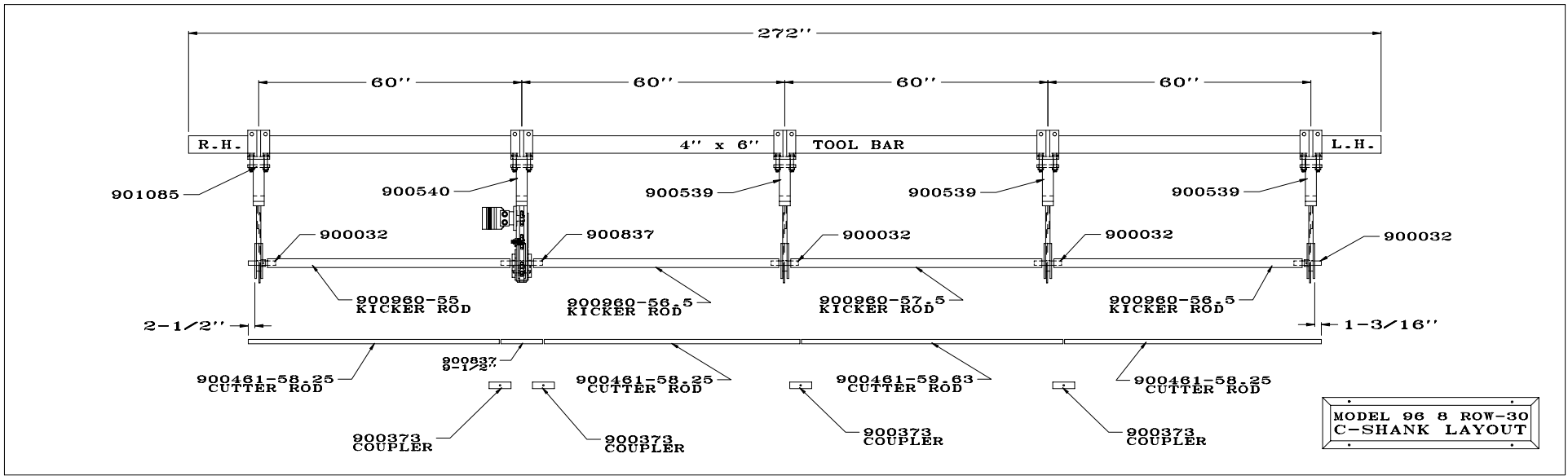

27

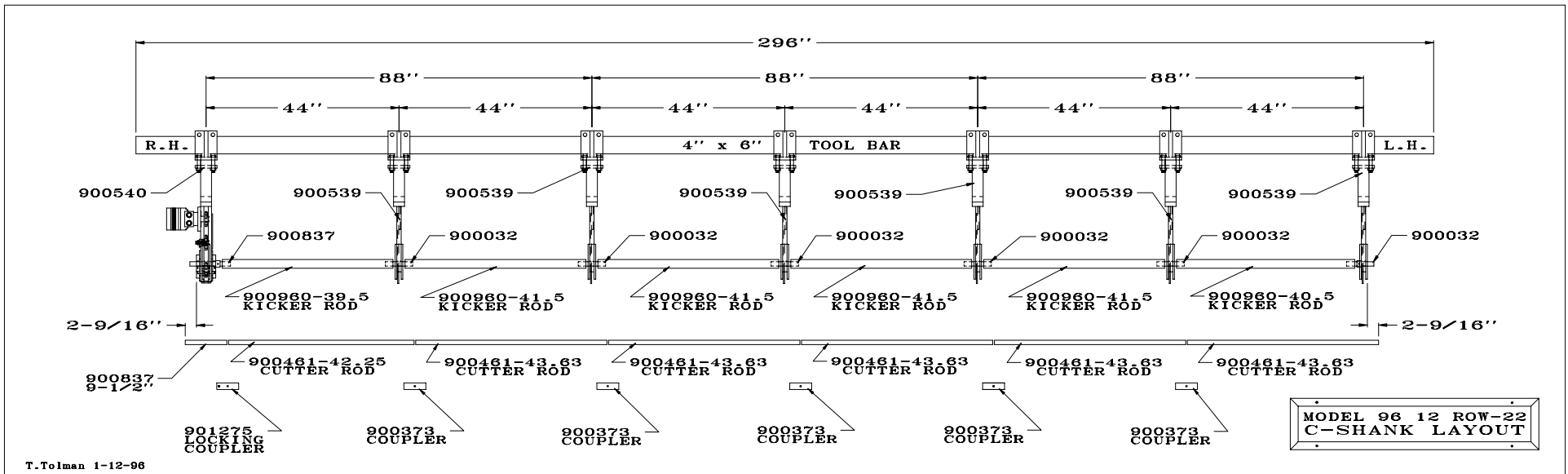

T.Tolman 1-12-96

1996-Present

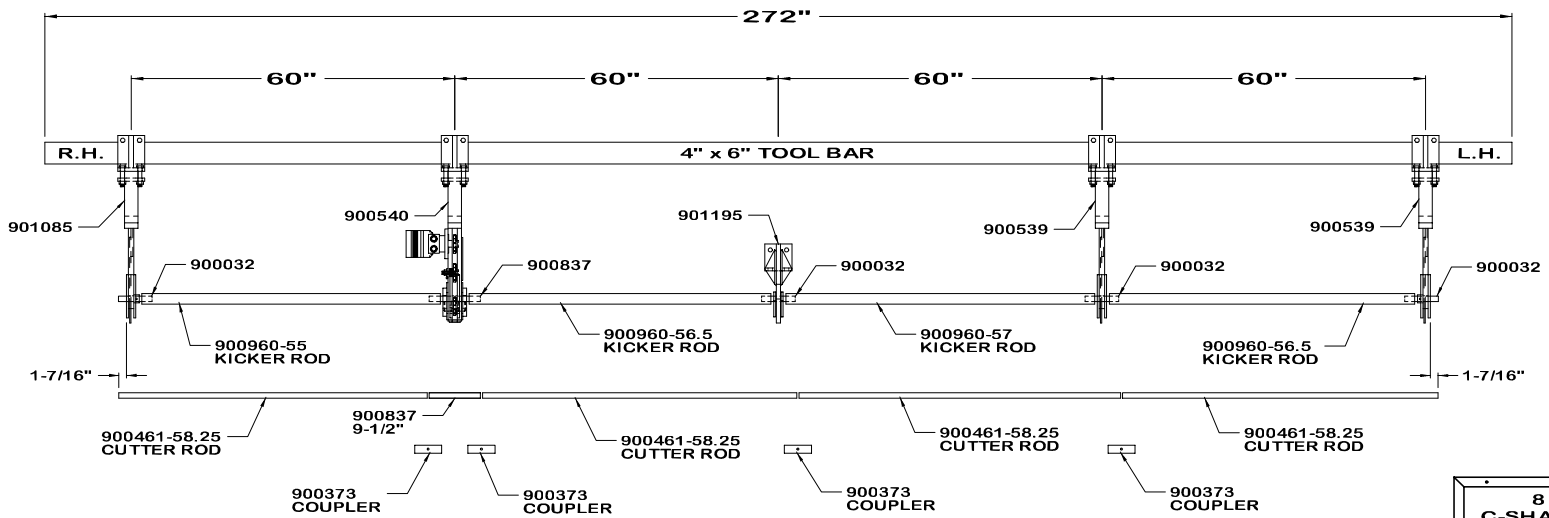
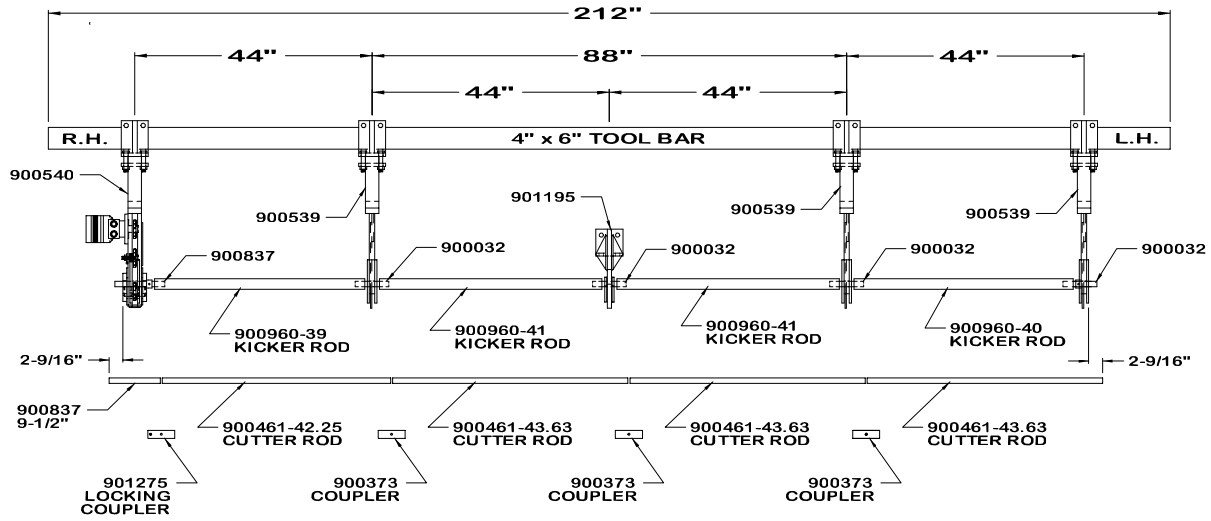

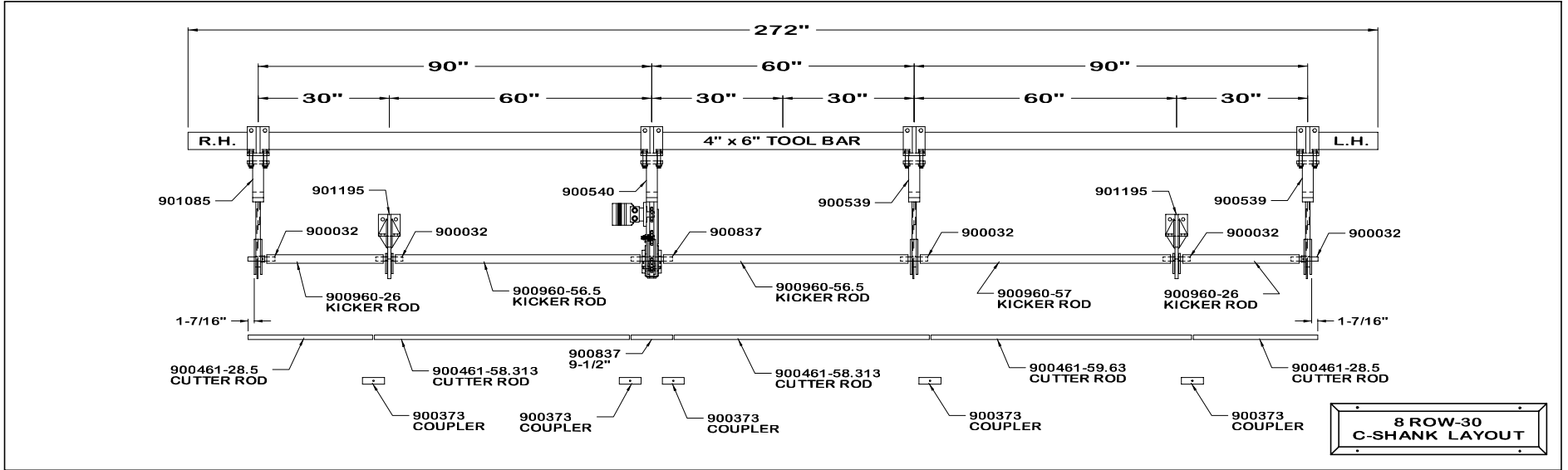

29

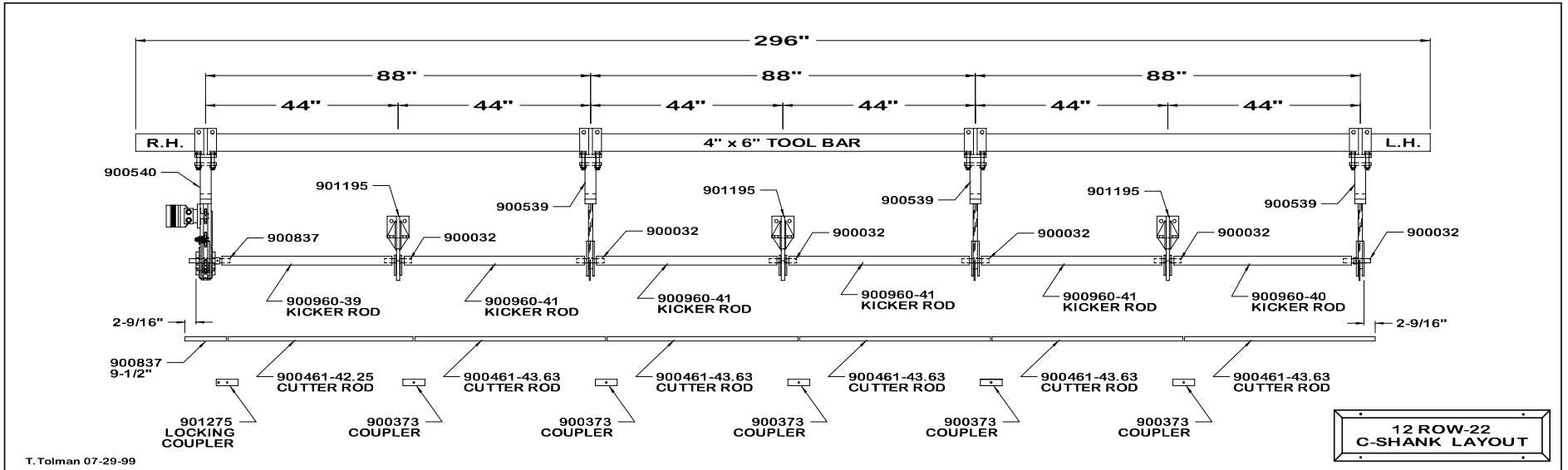

T. Tolman 07-29-99

Optional

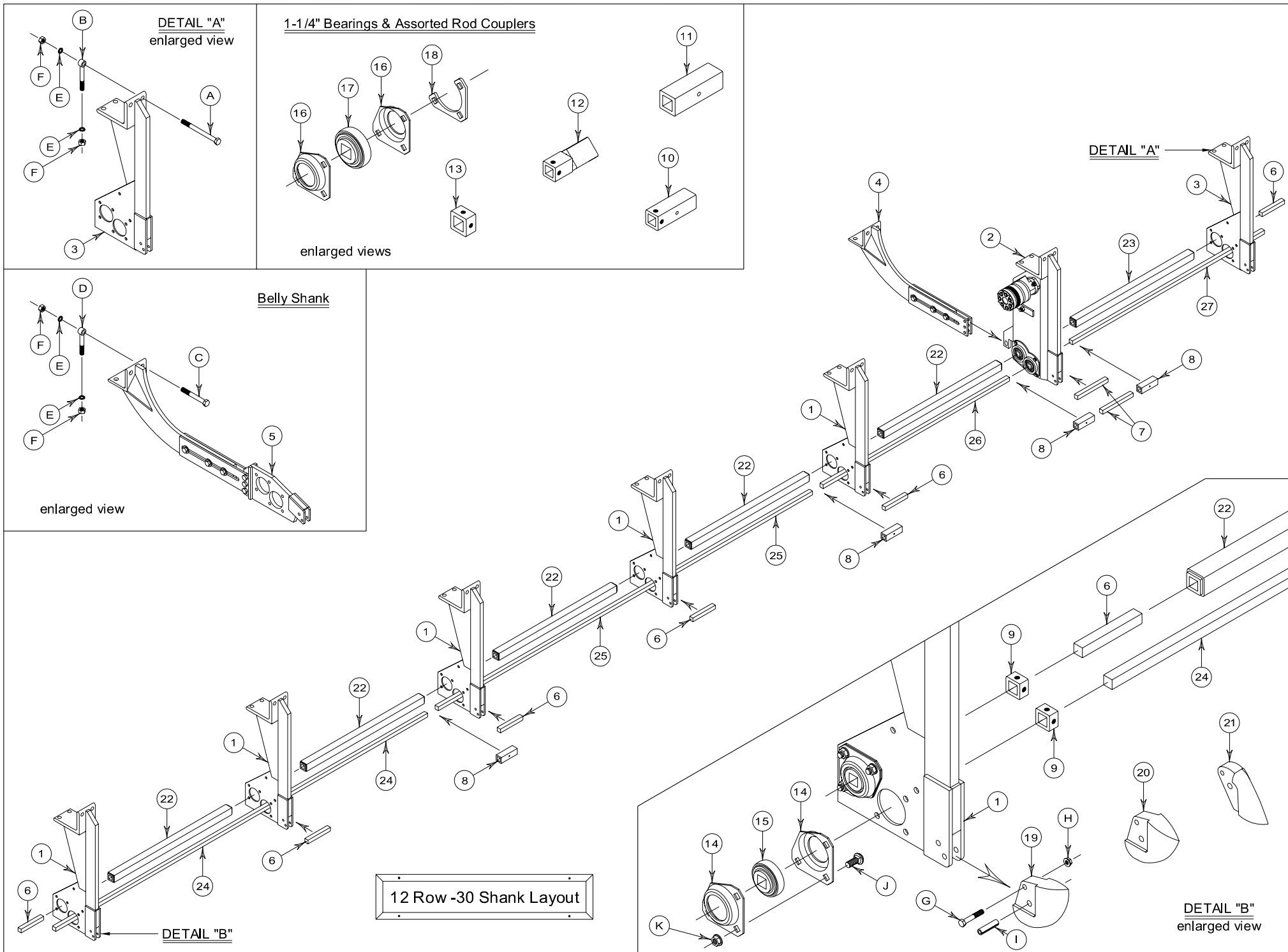

**12 ROW 30 SHANK LAYOUT (2005–Present) (Standard Shanks)****Parts List**

<b>Item No.</b>	<b>Part No.</b>	<b>Description</b>
1.	900405	Shank, 2 hole RH
2.	905090	Chain Case, Hydraulic (complete assembly)
3.	900950	Shank, 2 hole LH
4.	901227	Brace, Chain Case Belly Shank
5.	901195	Shank, Rear Pull Belly (complete assembly) **
6.	900032	Kicker Rod Key (7" long – 6 Required)
7.	900837	Chain Case Kicker Key (9½" long – 2 Required)
8.	900373	1" Cutter Rod Coupler (1" to 1") – 4 Required
9.	103038	Collar, 1" Square Lock
10.	901275	Coupler, Locking 1" Rod (used when Chain Case is on outside of machine)
11.	103099	1¼" Cutter Rod Coupler (1¼" to 1¼")
12.	901436	1" to 1¼" Lock Coupler (w/set screws)
13.	103098	Collar, 1¼" Square Lock
14.	106007	Flangett, 3-Hole (1" Square Bearing, enclosed end housing) (106007-97 open end housing)
15.	102000	Bearing, 1" Square Bore
16.	106037	Flangett, 3-Hole, (1¼" Square Bearing, enclosed end housing) (106037-97 open end housing)
17.	102087	Bearing, 1¼" Square Bore
18.	901434	1¼" Flangett Spacer (1988–1998)
19.	116023	V-Bottom Rock Point
20.	116024	Belly Shank Point
21.	116006	Shear Point (used as standard on part no. 901195, belly shank)
22.	900960-56.5	Kicker Rod, Square to Square–5 Required (56½" long)
23.	900960-55	Kicker Rod, Square to Square–1 Required (55" long)
24.	900461-118.5	1" Cutter Rod (118½" lg.) *
25.	900461-119.6	1" Cutter Rod (119 <sup>5</sup> / <sub>8</sub> " lg.) *
26.	900461-58.5	1" Cutter Rod (58½" lg.) *
27.	900461-57.25	1" Cutter Rod (57¼" lg.) *
Not Shown	116029	Reversible Point (see items 19-21 for similar items)
Not Shown	901435	1¼" Cutter Rod (various lengths) (example: 901435-length) *

**Hardware List**

<b>Item No.</b>	<b>Part No.</b>	<b>Description</b>
A.	106009	¾" x 9" NC Hex Bolt–Grade 8
B.	118000	¾" x 6" NC Eye Bolt–Grade 8
C.		¾" x 5½" NC Hex Bolt–Grade 8
D.	118029	¾" x 5" NC Eye Bolt–Grade 8
E.		¾" Lock Washer
F.		¾" NC Hex Nut–Grade 8
G.		3/8" x 2¼" NC Hex Bolt–Grade 5
H.		3/8" NC Whiz Nut
I.		½" x 2" Roll Pin
J.		½" x 1" NC Carriage Bolt (use 1¼" long Carriage Bolts on C-shanks, 1½" long on Belly Shanks)
K.		½" NC Whiz Nut

\* Kicker Rod and Cutter Rod lengths (in inches) are noted following the 6 digit part number.

\*\* Complete assembly includes all mounting hardware less bearings and flangettes. For a more complete listing, see the Service Update Section, Section 4.

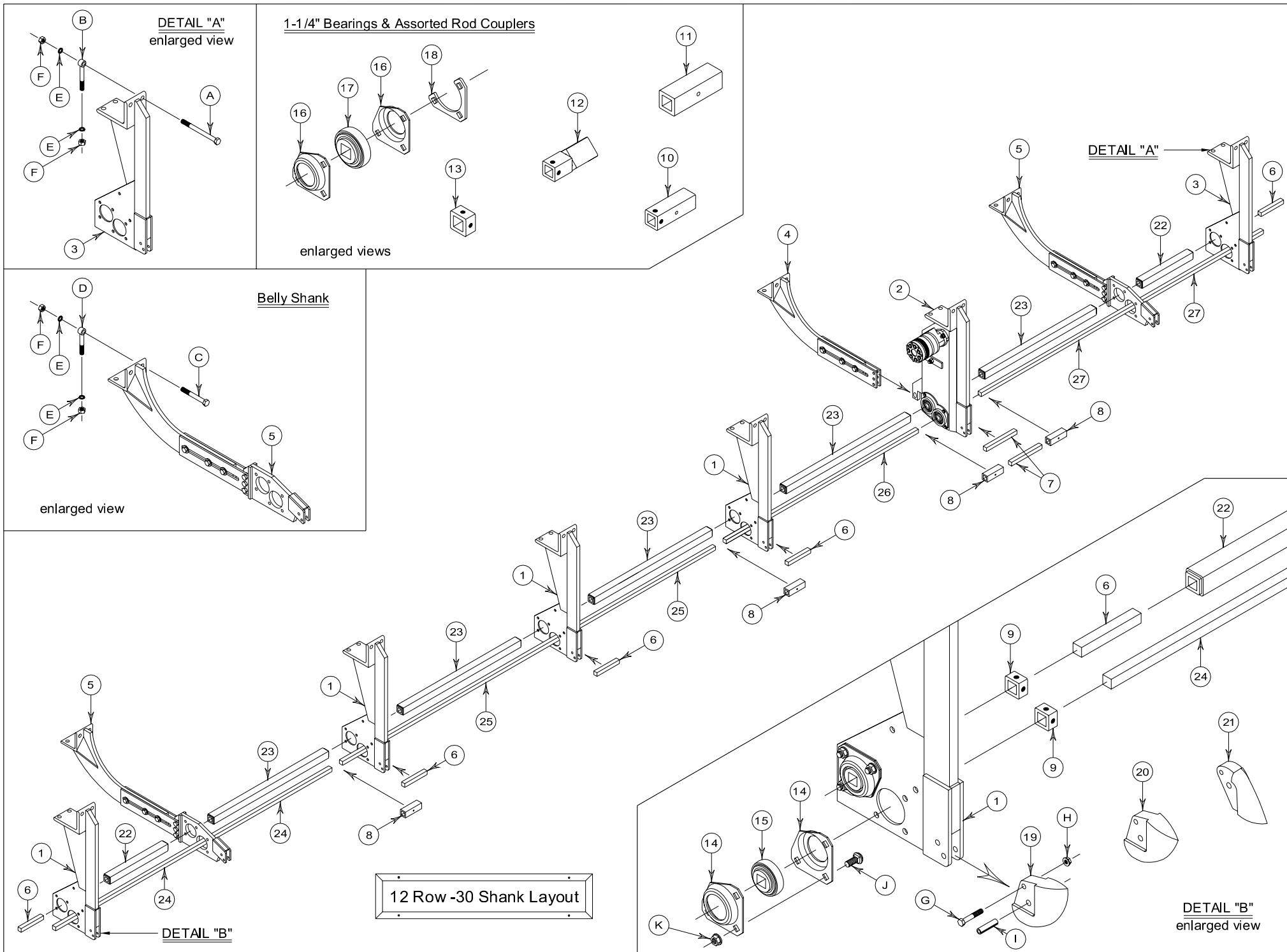



**12 ROW 30 SHANK LAYOUT(2005–Present)(Standard & Belly Shanks)****Parts List**

<b>Item No.</b>	<b>Part No.</b>	<b>Description</b>
1.	900405	Shank, 2 hole RH
2.	905090	Chain Case, Hydraulic (complete assembly)
3.	900950	Shank, 2 hole LH
4.	901227	Brace, Chain Case Belly Shank
5.	901195	Shank, Rear Pull Belly (complete assembly) **
6.	900032	Kicker Rod Key (7" long – 5 Required)
7.	900837	Chain Case Kicker Key (9½" long – 2 Required)
8.	900373	1" Cutter Rod Coupler (1" to 1") – 4 Required
9.	103038	Collar, 1" Square Lock
10.	901275	Coupler, Locking 1" Rod (used when Chain Case is on outside of machine)
11.	103099	1¼" Cutter Rod Coupler (1¼" to 1¼")
12.	901436	1" to 1¼" Lock Coupler (w/set screws)
13.	103098	Collar, 1¼" Square Lock
14.	106007	Flangett, 3-Hole (1" Square Bearing, enclosed end housing) (106007-97 open end housing)
15.	102000	Bearing, 1" Square Bore
16.	106037	Flangett, 3-Hole, (1¼" Square Bearing, enclosed end housing) (106037-97 open end housing)
17.	102087	Bearing, 1¼" Square Bore
18.	901434	1¼" Flangett Spacer (1988–1998)
19.	116023	V-Bottom Rock Point
20.	116024	Belly Shank Point
21.	116006	Shear Point (used as standard on part no. 901195, belly shank)
22.	900960-26	Kicker Rod, Square to Square–2 Required (26 " long)
23.	900960-56.5	Kicker Rod, Square to Square–5 Required (56½" long)
24.	900461-88.5	1" Cutter Rod (88½" lg.) *
25.	900461-119.6	1" Cutter Rod (119 <sup>5</sup> / <sub>8</sub> " lg.) *
26.	900461-58.5	1" Cutter Rod (58½" lg.) *
27.	900461-87.25	1" Cutter Rod (87¼" lg.) *
Not Shown	116029	Reversible Point (see items 19-21 for similar items)
Not Shown	901435	1¼" Cutter Rod (various lengths) (example: 901435-length) *

**Hardware List**

<b>Item No.</b>	<b>Part No.</b>	<b>Description</b>
A.	106009	¾" x 9" NC Hex Bolt–Grade 8
B.	118000	¾" x 6" NC Eye Bolt–Grade 8
C.		¾" x 5½" NC Hex Bolt–Grade 8
D.	118029	¾" x 5" NC Eye Bolt–Grade 8
E.		¾" Lock Washer
F.		¾" NC Hex Nut–Grade 8
G.		3/8" x 2¼" NC Hex Bolt–Grade 5
H.		3/8" NC Whiz Nut
I.		½" x 2" Roll Pin
J.		½" x 1" NC Carriage Bolt (use 1¼" long Carriage Bolts on C-shanks, 1½" long on Belly Shanks)
K.		½" NC Whiz Nut

\* Kicker Rod and Cutter Rod lengths (in inches) are noted following the 6 digit part number.

\*\* Complete assembly includes all mounting hardware less bearings and flangettes. For a more complete listing, see the Service Update Section, Section 4.

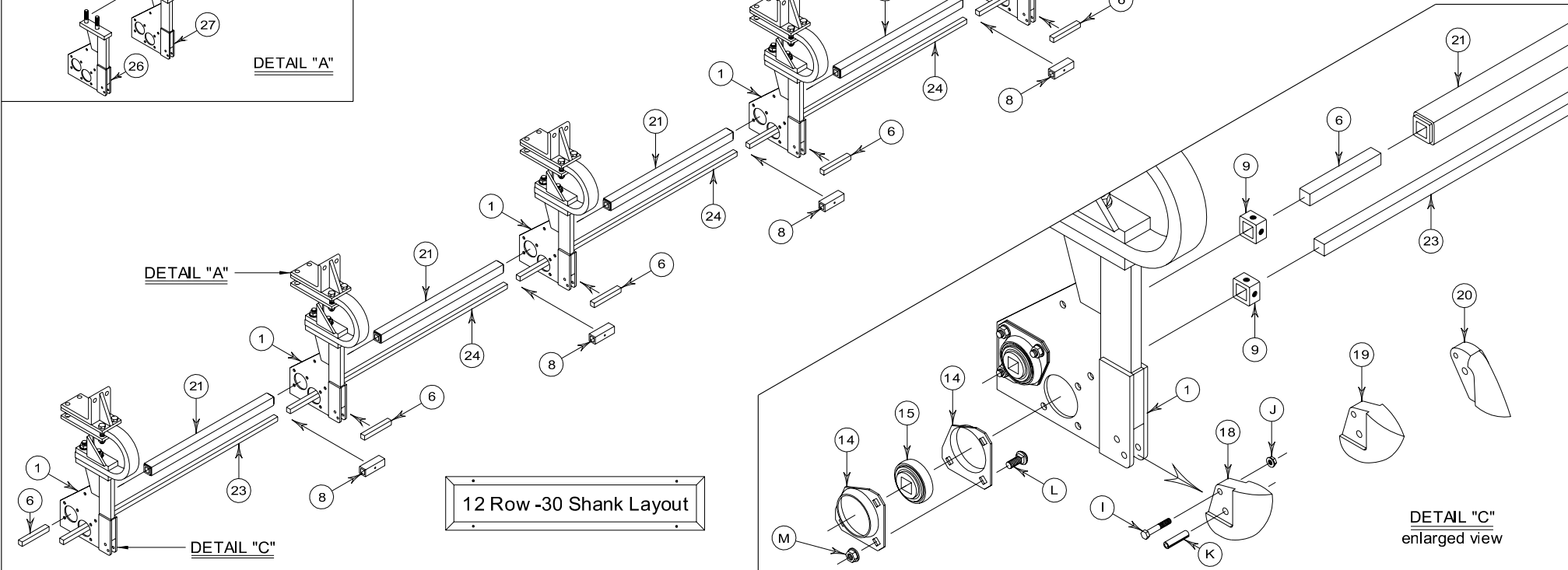
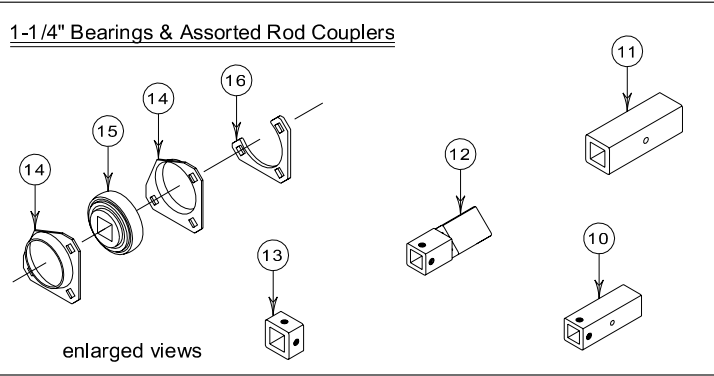
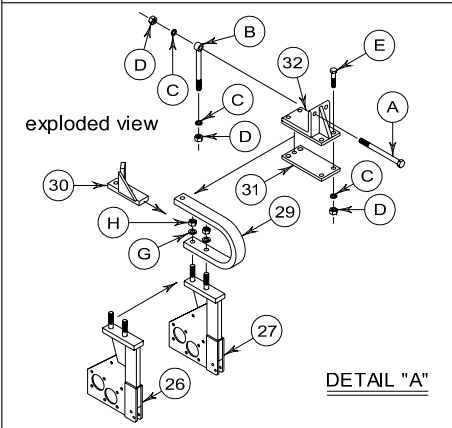
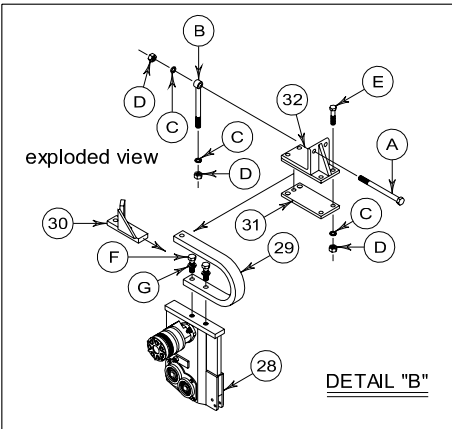

**12 ROW 30 SHANK LAYOUT (2005–Present) (C-Shanks)****Parts List**

<b>Item No.</b>	<b>Part No.</b>	<b>Description</b>
1.	901085	C-Shank, 2 hole (Complete RH)
2.	900540	C-Shank Chain Case, Hydraulic (Complete Assembly)
3.	900539	C-Shank, 2 hole (Complete LH)
4.	300090	Deflector Rod, C-Shank (RH)
5.	300089	Deflector Rod, C-Shank (LH)
6.	900032	Kicker Rod Key (7" long – 6 Required)
7.	900837	Chain Case Kicker Key (9½" long – 2 Required)
8.	900373	1" Cutter Rod Coupler (1" to 1") – 6 Required
9.	103038	Collar, 1" Square Lock
10.	901275	Coupler, Locking 1" Rod (used when Chain Case is on outside of machine)
11.	103099	1¼" Cutter Rod Coupler (1¼" to 1¼")
12.	901436	1" to 1¼" Lock Coupler (w/set screws)
13.	103098	Collar, 1¼" Square Lock
14.	106037-97	Flangett, 3-Hole (1¼" Square Bearing, open end housing)
15.	102087	Bearing, 1¼" Square Bore
16.	901434	1¼" Flangett Spacer (1988–1998)
17.	901375	Deflector Rod, C-Shank Chain Case (RH)
18.	116023	V-Bottom Rock Point
19.	116024	Belly Shank Point
20.	116006	Shear Point
21.	900960-56.5	Kicker Rod, Square to Square – 5 Required (56½" long)
22.	900960-55	Kicker Rod, Square to Square – 1 Required (55" long)
23.	900461-58.5	1" Cutter Rod (58½" lg.) (2 Required) *
24.	900461-59.6	1" Cutter Rod (59⅝" lg.)(3 Required) *
25.	900461-57.25	1" Cutter Rod (57¼" lg.)(1 Required) *
26.	901084	C-Shank, 2 hole (RH Lower Half)
27.	900673	C-Shank, 2 hole (LH Lower Half)
28.	900675	C-Shank, Chain Case (Complete Lower Half)
29.	900615	Cushion Bar
30.	900667	Cushion Stop Plate
31.	900662	C-Shank, Bottom Mounting Plate
32.	900665	C-Shank, Mounting Angle Top Plate
Not Shown	116029	Reversible Point (see items 18-20 for similar items)
Not Shown	901435	1¼" Cutter Rod (various lengths) (example: 901435-length) *

**Hardware List**

<b>Item No.</b>	<b>Part No.</b>	<b>Description</b>
A.	106009	¾" x 9" NC Hex Bolt–Grade 8
B.	118023	¾" x 10" NC Eye Bolt–Grade 8
C.		¾" Lock Washer
D.		¾" NC Hex Nut–Grade 8
E.		¾" x 3½" NC Hex Bolt–Grade 5
F.		7/8" x 3½" NC Hex Bolt–Grade 8
G.		7/8" Lockwasher
H.		7/8" NC Hex Nut–Grade 8
I.		3/8" x 2¼" NC Hex Bolt–Grade 5
J.		3/8" NC Whiz Nut
K.		½" x 2" Roll Pin
L.		½" x 1¼" NC Carriage Bolt
M.		½" NC Whiz Nut

\* Kicker Rod and Cutter Rod lengths (in inches) are noted following the 6 digit part number.

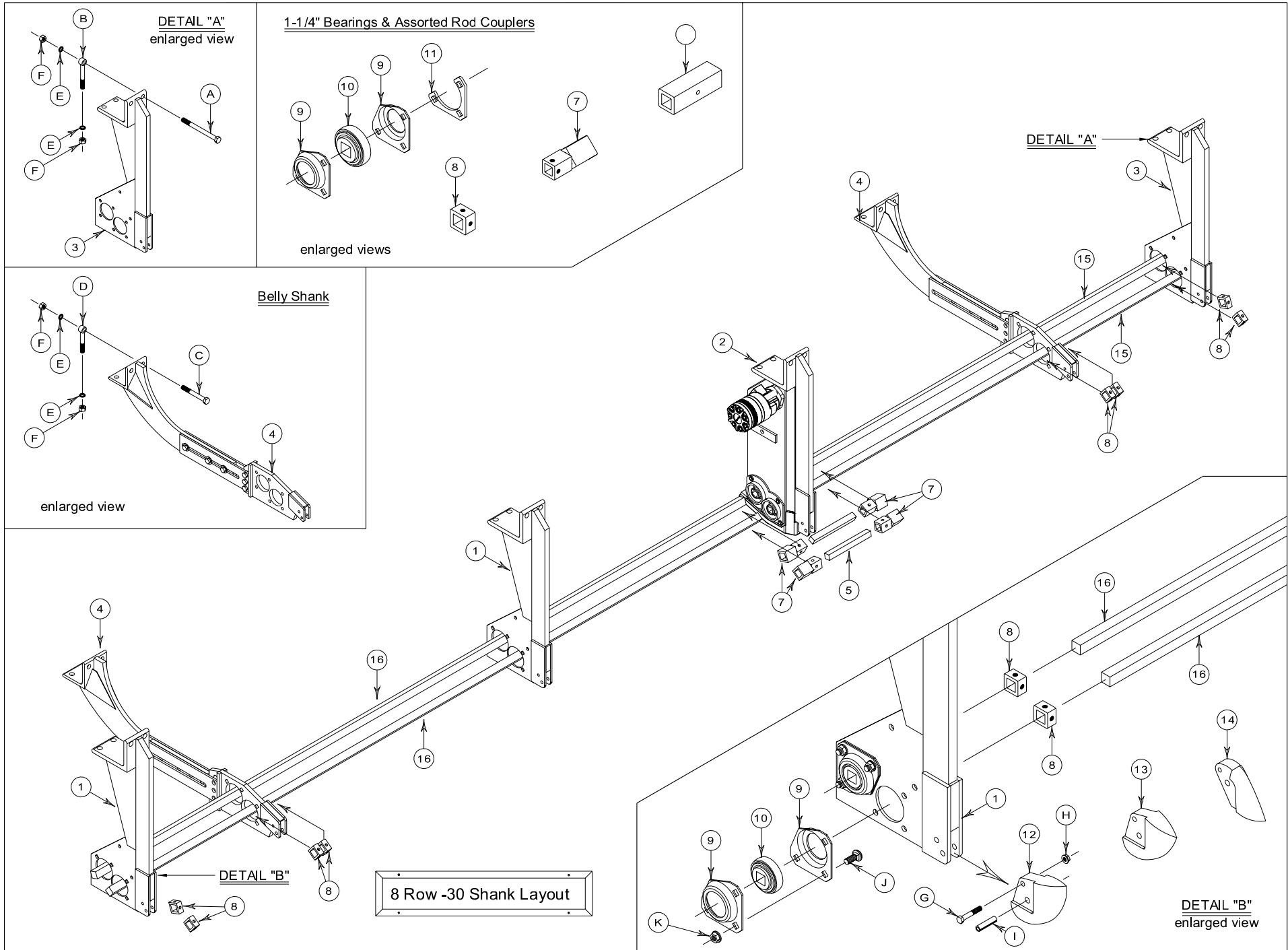

## 8 ROW 30 SHANK LAYOUT (Standard & Belly Shanks) With Two 1 1/4" Cutter Rods

### Parts List

<u>Item No.</u>	<u>Part No.</u>	<u>Description</u>
1.	900405	Shank, 2 hole RH
2.	905090	Chain Case, Hydraulic (complete assembly)
3.	900950	Shank, 2 hole LH
4.	901195	Shank, Rear Pull Belly (complete assembly) **
5.	900837	Chain Case Kicker Key (9½" long – 2 Required)
6.	103099	1¼" Cutter Rod Coupler (1¼" to 1¼") (optional to allow the use of shorter rods)
7.	901436	1" to 1¼" Lock Coupler (w/set screws)
8.	103098	Collar, 1¼" Square Lock
9.	106037	Flangette, 3-Hole, (1¼" Square Bearing, enclosed end housing) (106037-97 open end housing)
10.	102087	Bearing, 1¼" Square Bore
11.	901434	1¼" Flangette Spacer (1988–1998)
12.	116023	V-Bottom Rock Point
13.	116024	Belly Shank Point
14.	116006	Shear Point
15.	901435-87.5	1 1/4" Cutter Rod (87 1/2"lg.) *
16.	901435-147.5	1 1/4" Cutter Rod (147 1/2" lg.) *
Not Shown	116029	Reversible Point (see items 12-14 for similar items)

### Hardware List

<u>Item No.</u>	<u>Part No.</u>	<u>Description</u>
A.	106009	¾" x 9" NC Hex Bolt–Grade 8
B.	118000	¾" x 6" NC Eye Bolt–Grade 8
C.		¾" x 5½" NC Hex Bolt–Grade 8
D.	118029	¾" x 5" NC Eye Bolt–Grade 8
E.		¾" Lock Washer
F.		¾" NC Hex Nut–Grade 8
G.		3/8" x 2¼" NC Hex Bolt–Grade 5
H.		3/8" NC Whiz Nut
I.		½" x 2" Roll Pin
J.		½" x 1" NC Carriage Bolt (use 1¼" long Carriage Bolts on C-shanks, 1½" long on Belly Shanks)
K.		½" NC Whiz Nut

\* Cutter Rod lengths (in inches) are noted following the 6 digit part number.

\*\* Complete assembly includes all mounting hardware less bearings and flangetts. For a more complete listing, see the Service Update Section, Section 4.

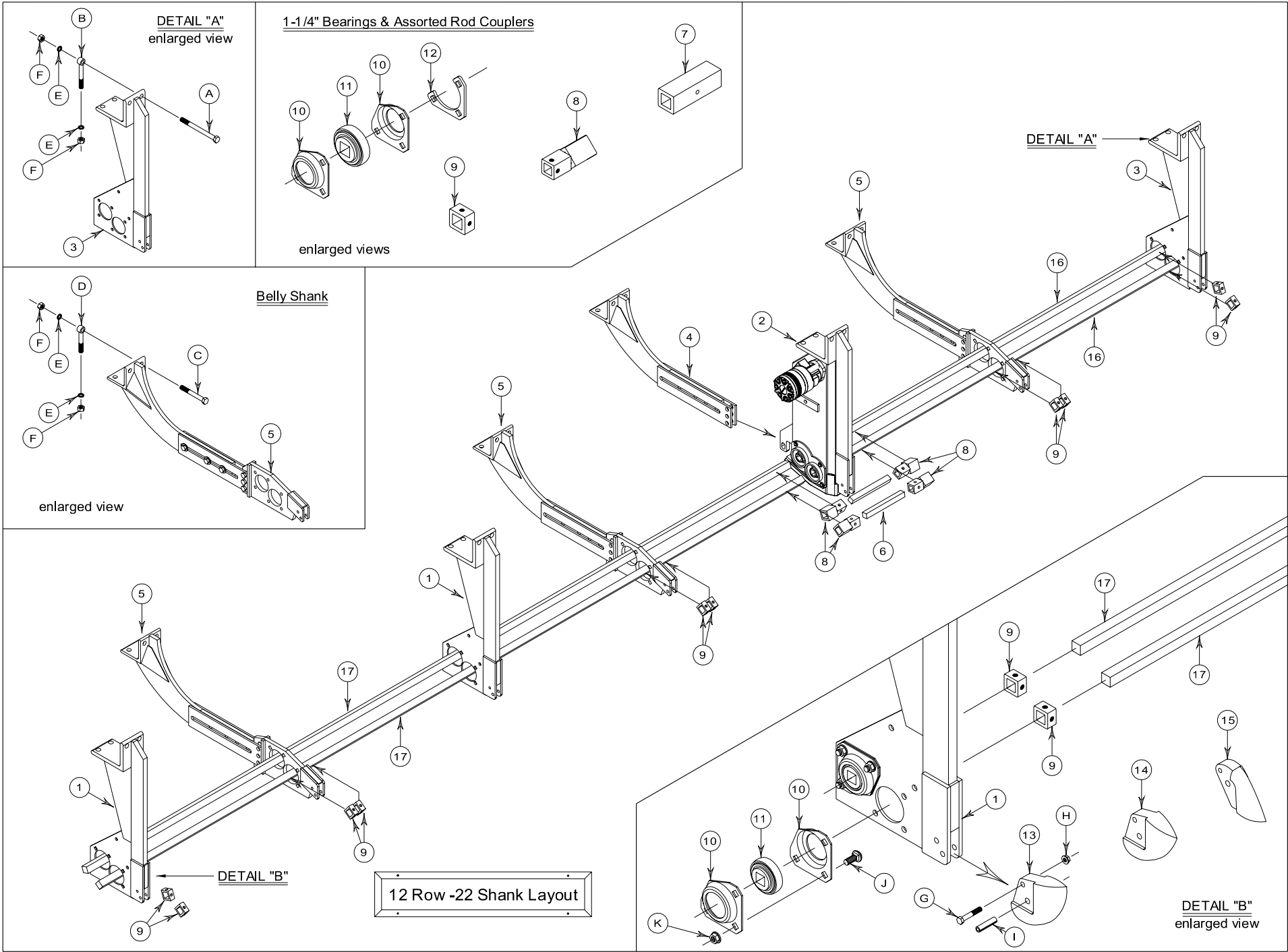

## 12 ROW 22 SHANK LAYOUT (Standard & Belly Shanks) With Two 1 1/4" Cutter Rods

### Parts List

<u>Item No.</u>	<u>Part No.</u>	<u>Description</u>
1.	900405	Shank, 2 hole RH
2.	905090	Chain Case, Hydraulic (complete assembly)
3.	900950	Shank, 2 hole LH
4.	901227	Brace, Chain Case Belly Shank
5.	901195	Shank, Rear Pull Belly (complete assembly) **
6.	900837	Chain Case Kicker Key (9½" long – 2 Required)
7.	103099	1¼" Cutter Rod Coupler (1¼" to 1¼") (optional to allow the use of shorter rods)
8.	901436	1" to 1¼" Lock Coupler (w/set screws)
9.	103098	Collar, 1¼" Square Lock
10.	106037	Flangette, 3-Hole, (1¼" Square Bearing, enclosed end housing) (106037-97 open end housing)
11.	102087	Bearing, 1¼" Square Bore
12.	901434	1¼" Flangette Spacer (1988–1998)
13.	116023	V-Bottom Rock Point
14.	116024	Belly Shank Point
15.	116006	Shear Point
16.	901435-85.5	1 1/4" Cutter Rod (85 1/2"lg.) *
17.	901435-173.5	1 1/4" Cutter Rod (173 1/2" lg.) *
Not Shown	116029	Reversible Point (see items 13-15 for similar items)

### Hardware List

<u>Item No.</u>	<u>Part No.</u>	<u>Description</u>
A.	106009	¾" x 9" NC Hex Bolt–Grade 8
B.	118000	¾" x 6" NC Eye Bolt–Grade 8
C.		¾" x 5½" NC Hex Bolt–Grade 8
D.	118029	¾" x 5" NC Eye Bolt–Grade 8
E.		¾" Lock Washer
F.		¾" NC Hex Nut–Grade 8
G.		3/8" x 2¼" NC Hex Bolt–Grade 5
H.		3/8" NC Whiz Nut
I.		½" x 2" Roll Pin
J.		½" x 1" NC Carriage Bolt (use 1¼" long Carriage Bolts on C-shanks, 1½" long on Belly Shanks)
K.		½" NC Whiz Nut

\* Cutter Rod lengths (in inches) are noted following the 6 digit part number.

\*\* Complete assembly includes all mounting hardware less bearings and flangetts. For a more complete listing, see the Service Update Section, Section 4.